

**United States Department of the Interior
National Park Service**

**National Register of Historic Places
Continuation Sheet**

Section number _____ Page _____

SUPPLEMENTARY LISTING RECORD

NRIS Reference Number: 02001092

Date Listed: October 3, 2002

Property Name: Lizzie McLagan House

County: St. Louis

State: Missouri

Historic Resources of Kirkwood, Missouri
Multiple Name

This property is listed in the National Register of Historic Places in accordance with the attached nomination documentation subject to the following exceptions, exclusions, or amendments, notwithstanding the National Park Service certification included in the nomination documentation.

for Daniel T. Vivian
Signature of the Keeper

October 3, 2002
Date of Action

Amended Items in Nomination:

Section 10: Geographical Data

The Boundary Justification is hereby amended to read as follows: "The boundary encompasses the parcel of land historically associated with the McLagan House."

The Missouri State Historic Preservation Office was notified of this amendment.

DISTRIBUTION:

**National Register property file
Nominating Authority (without nomination attachment)**

United States Department of the Interior
National Park Service**National Register of Historic Places
Registration Form****1. Name of Property**historic name McLagan, Lizzie, Houseother names/site number History House**2. Location**street & number 549 East Argonne [N/A] not for publicationcity or town Kirkwood [N/A] vicinitystate Missouri code MO county St. Louis code 189 zip code 63122**3. State/Federal Agency Certification**

As the designated authority under the National Historic Preservation Act, as amended, I hereby certify that this ☒ nomination ☐ request for determination of eligibility meets the documentation standards for registering properties in the National Register of Historic Places and meets the procedural and professional requirements set forth in 36 CFR Part 60. In my opinion, the property ☒ meets ☐ does not meet the National Register criteria. I recommend that this property be considered significant ☐ nationally ☐ statewide ☒ locally. (See continuation sheet for additional comments ☐.)

 12 August 02
Signature of certifying official/Title Claire F. Blackwell/Deputy SHPO Date

Missouri Department of Natural Resources

State or Federal agency and bureau

In my opinion, the property ☐ meets ☐ does not meet the National Register criteria.(See continuation sheet for additional comments ☐.)

Signature of certifying official/Title

Date

State or Federal agency and bureau

4. National Park Service Certification

I hereby certify that the property is:

☐ entered in the National Register.See continuation sheet ☐.☐ determined eligible for the
National Register.See continuation sheet ☐.☐ determined not eligible for the
National Register.☐ removed from the National
Register.☐ other, (explain:)

Signature of the Keeper

Date of Action

McLagan, Lizzie, House
St. Louis County, Missouri
Historic Resources of Kirkwood, Missouri

Page 2

5. Classification

Ownership of Property	Category of Property	Number of Resources Within Property	
		Contributing	Non-contributing
<input checked="" type="checkbox"/> private	<input checked="" type="checkbox"/> building(s)	1	1
<input type="checkbox"/> public-local	<input type="checkbox"/> district	0	0
<input type="checkbox"/> public-State	<input type="checkbox"/> site	0	0
<input type="checkbox"/> public-Federal	<input type="checkbox"/> structure	0	0
	<input type="checkbox"/> object	1	1
			buildings
			sites
			structures
			objects
			Total

Name of related multiple property listing.

Historic Resources of Kirkwood, Missouri

Number of contributing resources previously listed in the National Register.

0

6. Function or Use

Historic Functions

DOMESTIC/ single dwelling

Current Functions

DOMESTIC/ single dwelling

DOMESTIC/Secondary Structure

7. Description

Architectural Classification

Italianate

Materials

foundation Stone

walls Wood

roof Asphalt

other Wood

Narrative Description See continuation sheet [x].

See continuation sheet []

McLagan, Lizzie, House
St. Louis County, Missouri
Historic Resources of Kirkwood, Missouri

Page 3

8. Statement of Significance

Applicable National Register Criteria

☐ **A** Property is associated with events that have made a significant contribution to the broad patterns of our history.

☐ **B** Property is associated with the lives of persons significant in our past.

☒ **C** Property embodies the distinctive characteristics of a type, period, or method of construction or represents the work of a master, or possesses high artistic values, or represents a significant and distinguishable entity whose components lack individual distinction.

☐ **D** Property has yielded, or is likely to yield, information important in prehistory or history.

Criteria Considerations

Property is:

☐ **A** owned by a religious institution or used for religious purposes.

☐ **B** removed from its original location.

☐ **C** a birthplace or grave.

☐ **D** a cemetery.

☐ **E** a reconstructed building, object, or structure.

☐ **F** a commemorative property.

☐ **G** less than 50 years of age or achieved significance within the past 50 years.

Narrative Statement of Significance

See continuation sheet [x].

9. Major Bibliographic References

Bibliography

See continuation sheet [x].

Previous documentation on file (NPS):

☐ preliminary determination of individual listing (36 CFR 67) has been requested

☐ previously listed in the National Register

☐ previously determined eligible by the National Register

☐ designated a National Historic Landmark

☐ recorded by Historic American Buildings Survey

#

☐ recorded by Historic American Engineering Record

#

Areas of Significance

Architecture

Period of Significance

c. 1863

Significant Dates

c. 1863

Significant Person(s)

N/A

Cultural Affiliation

N/A

Architect/Builder

Unknown

Primary location of additional data:

☒ State Historic Preservation Office

☐ Other State Agency

☐ Federal Agency

☒ Local Government

☐ University

☐ Other:

Name of repository:

Kirkwood Planning and Development Department

McLagan, Lizzie, House
St. Louis County, Missouri
Historic Resources of Kirkwood, Missouri

Page 4

10. Geographical DataAcreage of Property 0.640**UTM References**

A. Zone	Easting	Northing	B. Zone	Easting	Northing
15	726880	4273320			
C. Zone	Easting	Northing	D. Zone	Easting	Northing

[] See continuation sheet

Verbal Boundary Description

(Describe the boundaries of the property on a continuation sheet.)

Boundary Justification

(Explain why the boundaries were selected on a continuation sheet.)

11. Form Prepared Byname/title See Continuation Sheet

organization _____ date _____

street & number _____ telephone _____

city or town _____ state _____ zip code _____

Additional Documentation

Submit the following items with the completed form:

Continuation Sheets**Maps**A **USGS map** (7.5 or 15 minute series) indicating the property's location.A **Sketch map** for historic districts and properties having large acreage or numerous resources.**Photographs**Representative **black and white photographs** of the property.**Additional Items**

(Check with the SHPO or FOP for any additional items)

Property Owner

(Complete this item at the request of SHPO or FPO.)

name Mr. and Mrs. William Ravensbergstreet & number 549 East Argonne telephone _____city or town Kirkwood state MO zip code 63122

**United States Department of the Interior
National Park Service**

**National Register of Historic Places
Continuation Sheet**

Section number 7 Page 1

**McLagan, Lizzie, House
St. Louis County, Missouri
Historic Resources of Kirkwood, Missouri**

Summary The Lizzie McLagan House, at 549 E. Argonne in Kirkwood, St. Louis County, is a two story Italianate style house with an irregular plan and a tall square tower. Constructed ca. 1863, the highly intact house is a good example of Property Type B. Italianate Houses, Subtype, Italian Villa. It meets the registration requirements for that property type set forth in the MPS Cover document "Historic Resources of Kirkwood, Missouri." Typically Italianate features include an irregular floor plan, multiple, low-pitched roofs with wide, overhanging eaves, cornice brackets, and wide frieze boards at the main eave lines. A three story square tower with a heavy bracketed cornice dominates the facade; that feature, paired with the irregular massing, is characteristic of the Italian Villa subtype. The house also has wood siding designed to mimic cut stone, complete with staggered quoins on most corners. The tower has paired, round-arched windows; the other windows of the house are flat-topped, and several of those have pedimented lintel pieces. A one-story front porch is set off-center on the facade; it has slender square posts and scrolled brackets. The house is set back from the street on a relatively large lot. The only other resource on the property is a small modern garage which is set near a back corner of the property; the garage is a non-contributing building. The McLagan House retains a high degree of integrity in the areas of design, materials, workmanship, setting, location, and association. It is immediately recognizable to its period of significance, which corresponds to the construction date of ca. 1863.

Elaboration: The Lizzie McLagan House is a large, highly intact example of the Italianate style, with many design features which were popular nationwide, as well as a few which were more typical of Kirkwood. It is one of the more elaborate examples of the Italianate Residences property type in Kirkwood, employing the distinctive square tower which defines the Italian Villa subtype.

The McLagan House faces south onto East Argonne street, and has an irregular floor plan with multiple rooflines. Onto a gabled ell form, flat-roofed, polygonal bays have been added on the first story of the south gable-front wing, as well as on the west elevation. This, combined with rear additions, the tower, and other decorative features, creates a complex form. The tower is centrally located along the facade, in the "L" formed in the junction of a gable-front-and-wing. The tower projects an additional story above the rest of the house, and has a low-pitched hip roof and a wide bracketed cornice. The remaining gable roofs are also low-pitched, with gable end returns and wide, overhanging eaves. Paired brackets adorn a wide frieze board on all the roof eaves of the original portion of the house, with dentils in between.

The one-story, flat-roofed front porch is set within the "L" of the gable wings, and is open under the tower portion. The porch was replaced in 1976, and complements the Italianate house. The porch has slender square porch columns, with Tuscan-type capitals and impost blocks supporting an entablature with dentils and brackets. A second story balcony porch above has a jig-sawn, Eastlake influenced balustrade. The same type of decorative balustrade tops the one story polygonal bays.

Very tall (to the floor), narrow paired windows provide access to the second story balconies

United States Department of the Interior
National Park Service

National Register of Historic Places
Continuation Sheet

Section number 7 Page 2

McLagan, Lizzie, House
St. Louis County, Missouri
Historic Resources of Kirkwood, Missouri

above the one story bays. These windows are one-over-one, double-hung wood sash, and have molded pedimented crowns. The pediments of all the gable wings of the original portion of the house, as well as the top of all sides of the square tower, have small, circular attic windows. The three windows in each bay are double-hung, with a single sash below and geometric pattern of multiple panes above. The third story of the square tower has tall, very narrow one-over-one, double-hung sash windows with round-arched tops. All other windows on the original portion are two-over-two, double-hung wood sash, with wood surrounds with low-pitched, integral pediments above. The front entry is centrally located, under the square tower. Just east of this entry are two additional glass doors, with transoms above, which also provide entry from the front porch into the house.

There have been multiple extensions of uncertain construction dates to the rear (north) elevation, which are one- and two-stories, with lower hipped and cross-gable roofs. All but the northern-most addition have the same type of wide, shiplap siding and corner quoins used elsewhere. The northern room is clad with narrow wood clapboards, and has a recessed rear entry on the north.

The large lot, nearly two-thirds of an acre, has mature deciduous shade trees enframing the house. A concrete walkway leads straight from the street to the front door. A small frame garage with narrow weatherboard siding sits near the northwest corner of the lot. The garage, which is less than ten years old, is non-contributing. A paved parking area is at the rear of the house.

The McLagan house serves today in its original single family function, and is in excellent condition. It is a highly intact example of the Italian Villa subtype of the Italianate Houses property type, and appears today very much as it did when new. △

United States Department of the Interior
National Park Service

National Register of Historic Places
Continuation Sheet

Section number 7 Page 3

McLagan, Lizzie, House
St. Louis County, Missouri
Historic Resources of Kirkwood, Missouri

Figure One. Site plan and photo key.

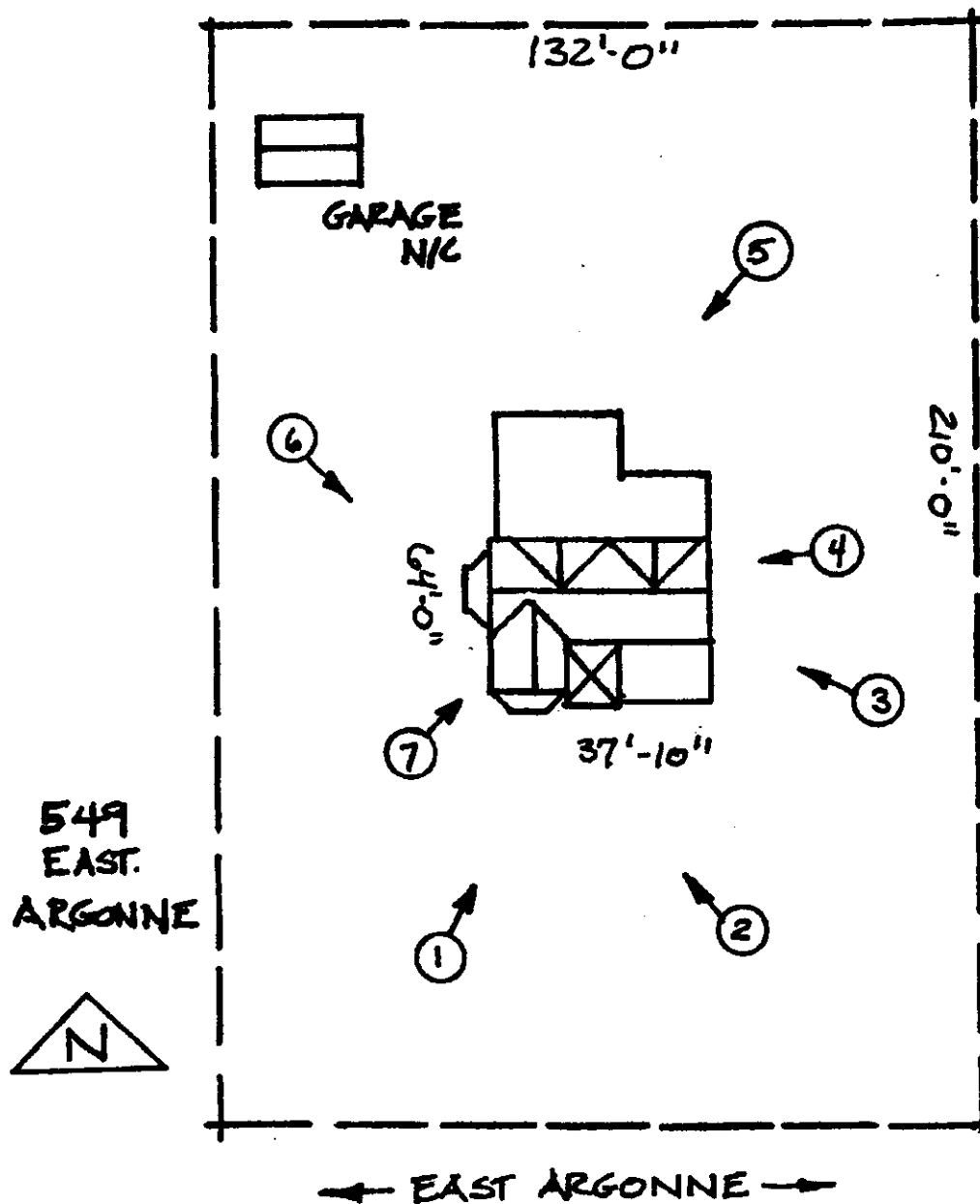

United States Department of the Interior
National Park Service

National Register of Historic Places
Continuation Sheet

Section number 8 Page 4

McLagan, Lizzie, House
St. Louis County, Missouri
Historic Resources of Kirkwood, Missouri

Summary The Lizzie McLagan House, 549 E. Argonne, is significant under Criterion C in the area of ARCHITECTURE. Constructed ca. 1863, the house is one of the largest, most refined examples of the Italian Villa subtype of the Italianate Houses property type in Kirkwood today. The house meets the registration requirements for that property type set forth in the MPS Cover document "Historic Resources of Kirkwood, Missouri," and falls under the context "The Creation of Kirkwood, a Planned Railroad Suburb--1851-1864." Identifying features of this property type found on the McLagan house include multiple low-pitched roofs with widely overhanging eaves and paired decorative brackets, wood siding designed to mimic cut stone, and an irregular floorplan. Those features are all typical of Property Type B.: Italianate Houses. The tall square tower of the facade, paired with an irregular plan, mark this as an example of the Italian Villa subtype. This house represents an early, elaborate example of the style, and exhibits many characteristics common to the Italianate houses of Kirkwood. It was built between 1863 and 1876, for Lizzie McLagan, and has seen few alterations of note since then. The period of significance for the property corresponds with its construction date of ca. 1863. The house is in excellent condition, and exhibits a high degree of integrity of location, setting, design, materials, workmanship, and feeling.

Elaboration: The McLagan house is an elaborate, highly intact example of the Italianate House property type.¹ This is one of the oldest houses which is sheathed with wide, shiplap wood siding and wooden quoins which emulate cut stone. The three-story tower, paired with irregular massing, mark this as an example of the Italian Villa subtype. The delicately rendered tower of this house is one of the most impressive such features found in Kirkwood today. That level of styling is not restricted to the tower; overall, this is one of the most elaborately styled Italianate houses in Kirkwood today.

This property was originally part of forty acres conveyed to Lizzie McLagan in 1863.² The 1878 county atlas map shows that by that time, this house had been built, and the forty acres had been subdivided, with Lizzie McLagan retaining ownership of a smaller parcel which included this house. The next year, McLagan sold the property to Agnes and Charles Black.³ Charles Black was a newspaper publisher who established the Clayton Argus in 1887. That paper had a section called the

¹ See MPS Cover document "Historic Resources of Kirkwood, Missouri, Section F, Associated Property Types," for more discussion of the Italianate House property type.

² Book 273, page 397, at the Recorder of Deeds Office of St. Louis.

³ Book 7, page 236, at the Recorder of Deeds Office of St. Louis.

**United States Department of the Interior
National Park Service**

**National Register of Historic Places
Continuation Sheet**

Section number 8 Page 5

**McLagan, Lizzie, House
St. Louis County, Missouri
Historic Resources of Kirkwood, Missouri**

“Kirkwood Argus” that was devoted to Kirkwood news.⁴

In 1907, the property was sold to Ethen Allen Taussig. Mr. Taussig had been a primo busso with the San Carlo Opera Company in London. He attended the Royal Academy, where he met his prima donna wife, who also sang with the San Carlos. The Taussigs had one son when they moved to Kirkwood. After the arrival of two more children, they enlarged the house at the rear by adding an upstairs and a downstairs room.

The house was later purchased by the Kirkwood Historical Society, and operated as a museum, under the name the “History House.” It has since been returned to single family use, and appears today very much as it did in the 1800s. It exhibits a high level of integrity and craftsmanship, and is one of the largest, most elaborately styled Italianate Houses in Kirkwood today. □

⁴ June Wilkinson Dahl, in A History of Kirkwood, Missouri: 1851-1965, (Kirkwood, Missouri: The Kirkwood Historical Society, 1965), p. 100.

United States Department of the Interior
National Park Service

National Register of Historic Places
Continuation Sheet

Section number 9 Page 6

McLagan, Lizzie, House
St. Louis County, Missouri
Historic Resources of Kirkwood, Missouri

BIBLIOGRAPHY

- Dahl, June Wilkinson. A History of Kirkwood, Missouri: 1861-1965. Kirkwood, MO.: The Kirkwood Historical Society, 1965.
- Johnson, Berkeley E. Atlas of St. Louis County. Clayton, MO: C. B. Black, 1893.
- McAlester, Virginia & Lee. A Field Guide to American Houses. New York: Alfred A. Knopf, 1984.
- Northwest Publishing Company. Plat Book of St. Louis County. Des Moines: IA, Northwest Publishing Company, 1909.
- Pitzman, Julius. Atlas of St. Louis City and County, 1878. At Missouri Historical Society, St. Louis.
- St. Louis County Deed Records. Recorder of Deeds Office, Clayton, MO.

**United States Department of the Interior
National Park Service**

**National Register of Historic Places
Continuation Sheet**

Section number 10, photographs Page 7

**McLagan, Lizzie, House
St. Louis County, Missouri
Historic Resources of Kirkwood, Missouri**

Verbal Boundary Description

The West 10 feet of Lot 1 and all of Lots 2 and 3 of Phil Rau's Kirkwood Subdivision, in St. Louis County, Missouri, according to plat thereof recorded in Plat Book 35 page 68 of the St. Louis Recorder's Office, having a total acreage of 0.640 acres.

Boundary Justification

The current boundaries encompass all of the land associated with the house.

Photographs

The following information is the same for all photographs:

McLagan, Lizzie, House

549 E. Argonne St.

Kirkwood, St. Louis County, MO

1-2, taken by Debbie Sheals, 406 West Broadway, Columbia, MO 65203; date: 2002

3-9, taken by Linda Stockman, 139 South Kirkwood Rd, Kirkwood, MO, 63122; date: 1990

(The house was field checked in 2002 to ensure the 1990 photos are still accurate.)

Negatives on file with the City of Kirkwood Dept of Planing and Development, 139 South Kirkwood Road, Kirkwood, MO 63122, 314-822-5808.

List of Photographs

See site plan/photo key for indication of camera angles.

1. Facade, south east corner
2. Detail, tower
3. East elevation.
4. Detail, east rear corner.
5. Back, northeast corner.
6. Back, northwest corner.
7. Detail, west elevation.
8. Interior, mantle.
9. Interior, staircase.

United States Department of the Interior
National Park Service

National Register of Historic Places
Continuation Sheet

Section number 11 Page 8

McLagan, Lizzie, House
St. Louis County, Missouri
Historic Resources of Kirkwood, Missouri

11. Form Prepared By

Name Linda Stockman
organization Kirkwood Landmark Commission date 1990
street & number 139 South Kirkwood Road telephone (314) 822-5808
city or town Kirkwood state Missouri zip code 63122

Name Deon K. Wolfenbarger
organization Three Gables Preservation date 1992
street & number 9550 N.E. Cookingham Drive telephone (816) 792-1275
city or town Kansas City state Missouri zip code 64157

Name Debbie Sheals
organization Independent Contractor date May, 2002
street & number 406 West Broadway telephone 573-874-3779
city or town Columbia state Missouri zip code 65203















