

United States Department of the Interior
National Park Service

**NATIONAL REGISTER OF HISTORIC PLACES
REGISTRATION FORM**

This form is for use in nominating or requesting determinations for individual properties and districts. See instructions in How to Complete the National Register of Historic Places Registration Form (National Register Bulletin 16A). Complete each item by marking "x" in the appropriate box or by entering the information requested. If any item does not apply to the property being documented, enter "N/A" for "not applicable." For functions, architectural classification, materials, and areas of significance, enter only categories and subcategories from the instructions. Place additional entries and narrative items on continuation sheets (NPS Form 10-900a). Use a typewriter, word processor, or computer, to complete all items.

1. Name of Property

historic name Old Hyde Park West Historic District
other names/site number N/A

2. Location

street & number Roughly bounded by Linwood Blvd., Central, 39th St., and Baltimore St. not for publication N/A
city or town Kansas City vicinity N/A
state Missouri code MO county Jackson code 095 zip code 64110-11

3. State/Federal Agency Certification

As the designated authority under the National Historic Preservation Act of 1986, as amended, I hereby certify that this

nomination request for determination of eligibility meets the documentation standards for registering properties in the National Register of Historic Places and meets the procedural and professional requirements set forth in 36 CFR Part 60. In my opinion, the property meets does not meet the National Register Criteria. I recommend that this property be considered significant nationally statewide locally. (See continuation sheet for additional comments.)

Mark A. Miles

04/09/04

Signature of certifying official/Title Mark A. Miles, Deputy SHPO

Date

Missouri Department of Natural Resources
State or Federal Agency or Bureau

In my opinion, the property [] meets [] does not meet the National Register criteria.
([] See continuation sheet for additional comments.)

Signature of commenting or other official _____ Date _____

4. National Park Service Certification

I hereby certify that the property is:
[] entered in the National Register.
See continuation sheet []
[] determined eligible for the National Register.
See continuation sheet []
[] determined not eligible for the National Register
[] removed from the National Register.
[] other, explain
See continuation sheet []

Signature of the Keeper _____

Date of Action _____

5. Classification

Ownership of Property	Category of Property	Number of Resources within Property		
		Contributing	Noncontributing	
<input checked="" type="checkbox"/> private	<input type="checkbox"/> building(s)	261	43	buildings
<input type="checkbox"/> public-local	<input checked="" type="checkbox"/> district			sites
<input type="checkbox"/> public-State	<input type="checkbox"/> site			structures
<input type="checkbox"/> public-Federal	<input type="checkbox"/> structure			objects
	<input type="checkbox"/> object			Total
		261	43	

Name of related multiple property listing.

N/A

Number of contributing resources previously listed in the National Register.

15

6. Function or Use

(Enter categories from instructions)

Historic Functions

Domestic: Single dwelling

Domestic: multiple dwelling

Current Functions

Domestic: Single dwelling

Domestic: multiple dwelling

7. Description

Architectural Classification

Late Victorian

Queen Anne

Late 19th and 20th Century American Movements:

Prairie School

Bungalow/Craftsman

Other: Foursquare

Late 19th and 20th Century Revivals:

Classical Revival

Colonial Revival

Tudor Revival

Other: Kansas City Shirtwaist

Materials

foundation Limestone

roof Asphalt

Shake

Walls Brick

Limestone

Clapboard

Wood: shingle

Stucco

other Glass

Wood

Terracotta

Narrative Description (Describe the historic and current condition of the property on one or more continuation sheets.)

8. Statement of Significance

Applicable National Register Criteria

- [X] A Property is associated with events that have made a significant contribution to the broad patterns of our history.
[] B Property is associated with the lives of persons significant in our past.
[X] C Property embodies the distinctive characteristics of a type, period, or method of construction or represents the work of a master, or possesses high artistic values, or represents a significant and distinguishable entity whose components lack individual distinction.
[] D Property has yielded, or is likely to yield information important in prehistory or history.

Criteria Considerations

- [] A owned by a religious institution or used for religious purposes.
[] B removed from its original location.
[] C a birthplace or a grave.
[] D a cemetery.
[] E a reconstructed building, object, or structure.
[] F a commemorative property.
[] G less than 50 years of age or achieved significance within the last 50 years.

Areas of Significance

Community Planning and Development

Architecture

Period of Significance

1887-1938

Significant Dates

N/A

Significant Person(s)

N/A

Cultural Affiliation

N/A

Architect/Builder

McKecknie, John

Peters, Nelle E.

Phillips, Charles

Narrative Statement of Significance

(Explain the significance of the property on one or more continuation sheets.)

9. Major Bibliographical References

Bibliography

(Cite the books, articles, and other sources used in preparing this form on one or more continuation sheets.)

Previous documentation on file (NPS):

- [] preliminary determination of individual listing (36 CFR 67) has been requested.
[] previously listed in the National Register
[] previously determined eligible by the National Register
[] designated a National Historic Landmark
[] recorded by Historic American Buildings Survey
#
[] recorded by Historic American Engineering Record
#

Primary Location of Additional Data

- [X] State Historic Preservation Office
[] Other State agency
[] Federal agency
[X] Local government
[] University
[] Other

Name of Repository: Kansas City Landmarks Commission

10. Geographical Data

Acreage of Property 84.1 acres

UTM References

(place additional UTM references on a continuation sheet.) **See Continuation Sheet**

A	<u>15</u>	<u>362640</u>	<u>4325420</u>
	Zone	Easting	Northing
B	<u>15</u>	<u>362790</u>	<u>4325420</u>

C	<u>15</u>	<u>362720</u>	<u>4324260</u>
	Zone	Easting	Northing
D	<u>15</u>	<u>362430</u>	<u>4324270</u>

See continuation sheet

Verbal Boundary Description (Describe the boundaries of the property on a continuation sheet.) See Continuation Sheet

Boundary Justification (Explain why the boundaries were selected on a continuation sheet.) See Continuation Sheet

11. Form Prepared By

name/title Tony Gardner, Principal
organization S&G Historic Property Consultants, LLC date 12/05/2003
street & number 624 N. 8th St telephone 816-364-3800
city or town St. Joseph state MO zip code 64501

Additional Documentation

Submit the following items with the completed form:

Continuation Sheets

Maps

- A **USGS map** (7.5 or 15 minute series) indicating the property's location.
- A **sketch map** for historic districts and properties having large acreage or numerous resources.

Photographs

Representative **black and white photographs** of the property.

Additional items (Check with the SHPO or FPO for any additional items)

Property Owner

(Complete this item at the request of the SHPO or FPO.)

name Multiple
street & number _____ telephone _____
city or town _____ state _____ zip code _____

United States Department of the Interior
National Park Service

National Register of Historic Places Continuation Sheet

Section
number 7 Page 1

Old Hyde Park West Historic District
Jackson County, Missouri

The Old Hyde Park West Historic District is a residential neighborhood located of Kansas City, Jackson County, Missouri. Located in the city's "Midtown" area about three miles south of the Central Business District, Old Hyde Park West is roughly bounded by Central Street on the West, 39th Street on the south, Baltimore Avenue on the east, and Linwood Avenue on the north. The Old Hyde Park West district is limited mainly to properties constructed as residences along Central, Baltimore, Wyandotte, and numbered side streets. The proposed historic district contains 319 resources. Of this total, 261 are contributing and 43 are non-contributing (23 of the noncontributing are garages/outbuildings). The district also includes 15 buildings previously listed on the National Register. Only 15 of the primary buildings date after 1930. The level of integrity from property to property and block to block is high. Prevalent architectural styles include Prairie/Craftsman, Foursquare, Queen Anne, Classical Revival and Tudor Revival, and the locally popular Kansas City Shirtwaist Style. The streets are lined with concrete sidewalks, streetlamps, and mature trees.

The neighborhood is designed on the grid pattern between the major thoroughfares of Broadway, Main, Linwood, and 39th Streets. The single lots are 50 feet along the frontage and about 125-150 feet deep. One factor in the design of this suburb was their proximity to the streetcar lines along Main, Broadway, and Linwood. Since the automobile had yet to gain widespread popularity and the streetcars provided convenient transportation, the majority of the houses and apartment buildings did not have driveways and parking lots. Most of the existing driveways and lots were constructed at later dates.

The topography of the area slopes up from Union Station train station (Pershing Road) and Crown Center shopping center, then down to Brush Creek near 47th Street. This topography is reflected in the streetscape by the prevalent use of limestone retaining walls throughout the district that vary from one to five feet, depending on the area.

The proposed historic district contains 58 multifamily residences constructed before World War I. The period of most rapid growth was the decade after 1900 when 164 residences were constructed. The table below illustrates the major building periods for the Old Hyde Park West Historic District properties. The first period includes all construction before 1900, which illustrates the beginning of the building boom in the neighborhood. Between 1900-1909, 58 percent of the buildings in the district were completed. By 1929, the last building in the district was complete, which led to a period of no construction in the district until 1953. There was a secondary demolition and construction boom in the 1960s, when many apartment buildings were constructed throughout the district, but they are outside the period of significance.

United States Department of the Interior
National Park Service

National Register of Historic Places Continuation Sheet

Section number 7 Page 2

Old Hyde Park West Historic District
Jackson County, Missouri

Building Dates by Period:	
1880-1889	5
1890-1899	37
1900-1909	164
1910-1919	38
1920-1929	22
1930-1939	0
1940-1949	0
1950-1959	2
1960-1969	13

Included in the Old Hyde Park West Historic District are single-family residences, duplexes and multi-family apartments, the majority constructed before World War I. While single-family residences comprise the majority of buildings in the district, multi-unit dwellings represent the bulk of construction from a second building episode between the end of World War I and 1927.

The Old Hyde Park Historic District was developed during a period of great architectural variety. The late 19th century was the heyday of exuberant Victorian architecture, while the early 20th century witnessed the return of more subdued Classical and Colonial Revival styles, the exploration of traditional Craftsman themes, and the development of the uniquely Midwestern Prairie style. The architectural vocabulary of these varied styles is represented both individually and in unique amalgamations on buildings throughout the District. The result is a neighborhood of substantial residences, eclectic in design, that present a streetscape largely unchanged since the 1920s.

The single-family residences represent the variety of architectural fashions popular from the end of the nineteenth century through World War I. Most of the single-family homes are 1 to 2 ½ stories. While a few architect-designed properties are included in the district, the majority are vernacular house forms embellished with stylistic elements. The locally popular "Kansas City Shirtwaist," a variation of the midwestern foursquare house, predominates. These houses are clad with brick or stone on the first story and shingles, clapboards, or stucco on the upper stories. Most have full-width or wraparound front porches and multiple roof dormers. Architectural embellishments reflect the various architectural styles elaborated below.

United States Department of the Interior
National Park Service

National Register of Historic Places Continuation Sheet

Section
number 7 Page 3

Old Hyde Park West Historic District
Jackson County, Missouri

Queen Anne: shingled siding, asymmetrical plan, wraparound porch, stained glass windows, decorative stick work

Colonial Revival: center hall plan, gabled portico, pent overhang, sidelights

Neoclassical: columns, cornice returns, dentils, modillions, Palladian window

Tudor: small multi-light sash, simulated half-timbering

Prairie: wide eaves, banded windows

Craftsman: knee braces, exposed rafter tails, multiple gables and dormers, leaded and art glass windows

These same styles, whose features were adopted for vernacular designs, are typical of the few high-style residences extant in the district.

Multi-unit dwellings were constructed in the district from the beginning. These dwellings in general range from 2 to 4 stories, though there are a few taller apartment buildings. Prior to 1910, over eighty-percent of the construction was for single-family residences. However, after 1910 that trend shifted as increased population demands necessitated the construction of multi-unit buildings. Between 1910 and World War II, sixty-five percent of the residential construction in Old Hyde Park West contained multiple units. That number increased to eighty-five percent in the decade following the war.

The most prolific type of multi-unit dwelling in the district is the Colonnaded Apartment. These two to three story, brick buildings typically contain four to six apartment units. Front porches elevated on columns and piers of different orders distinguish these apartments. The columns range from simple, posts to full-height, fluted Corinthian designs.

Following the war, apartment designs became larger, porchless, and more functional with minimal ornament influenced by historical European architecture. Fewer buildings were constructed, but each contained substantially more apartments than the earlier four or six unit buildings.

Most of the buildings contributing to the historic district have suffered few changes. The most common alterations involve the covering of historic siding and alteration of porch elements. A number of buildings have replacement windows as well. Exterior wood stairs leading to the second and third stories are found on many of the homes that were converted into apartments during the 1940s. While the neighborhood has seen a number of changes over time, not unlike many streetcar suburbs in the United States, the overall integrity and feel of the district convey that of a turn of the century streetcar suburb.

United States Department of the Interior
National Park Service

National Register of Historic Places Continuation Sheet

Section
number 7 Page 4

Old Hyde Park West Historic District
Jackson County, Missouri

* All properties contributing unless otherwise noted

Vacant lots are noted in the inventory but not tallied in the final count of contributing and noncontributing building per Bulletin #16A.

1. 16-18 W. 34th Street (noncontributing due to alterations)

Building Date: 1907; Stories: 3; Plan: Rectangular; Style: Walk-up; Architect: (Unknown); Builder: (Unknown); Property Type: Domestic, multiple dwelling; Integrity: Fair.

Description: This three-story building has a stone foundation, and uses brick cladding materials with a flat, composition roof. The 1/2 front porch is two-story, enclosed with a balcony. The building also has brick quoins and belt courses, balconettes with French doors, and a projecting one-story entrance pavilion.

2. 22-24 W. 34th Street

Building Date: 1907; Stories: 3; Plan: Rectangular; Style: Walk-up; Architect: (Unknown); Builder: (Unknown); Property Type: Domestic, multiple dwelling; Integrity: Fair.

Description: This three-story building has a stone foundation, and uses brick cladding materials with a flat, composition roof. The 1/2 front porch has a flat roof. The building also has brick quoins and belt courses, and a projecting one-story entrance pavilion.

3. 101-03 W. 34th Street

Building Date: 1922; Stories: 1; Plan: Square; Style: One part commercial block; Architect: (Unknown); Builder: George Reinjes; Property Type: Commerce, restaurant; Integrity: Fair

Description: This one-story building has a brick foundation, and uses brick and lap siding cladding materials with a flat, composition roof.

4. 105-07 W. 34th Street

Building Date: 1905; Stories: 2; Plan: Rectangular; Style: Four-family flat; Architect: (Unknown); Builder: (Unknown); Property Type: Domestic, multiple dwelling; Integrity: Good

Description: This two-story building has a stone foundation, and uses brick cladding materials with a flat, composition roof. The front two-story porches are colonnaded with flat roofs. The building also has brick quoins, brick piers and balustrades, corbelled cornice, decorative chimney stack, and polygonal oriels.

United States Department of the Interior
National Park Service

National Register of Historic Places Continuation Sheet

Section
number 7 Page 5

Old Hyde Park West Historic District
Jackson County, Missouri

5. 109-11 W. 34th Street

Building Date: 1902; *Stories:* 2; *Plan:* Rectangular; *Style:* Four-family flat; *Architect:* (Unknown); *Builder:* J.A. Rose, realtor; *Property Type:* Domestic, multiple dwelling; *Integrity:* Good.

Description: This two-story building has a brick foundation, and uses brick cladding materials with a flat, composition roof. The full, two-story front porch has a flat roof. The building also has column-over-pier Tuscan colonnade, arched openings with stone sills, and brick dentilled cornice.

6. 200 W. 34th Street

Building Date: 1901; *Stories:* 2 1/2; *Plan:* Rectangular; *Style:* Mediterranean Revival; *Architect:* (Unknown); *Builder:* Chas. E. Phillips; *Property Type:* Domestic, single dwelling; *Integrity:* Good

Description: This 2 1/2-story building has a stone foundation, a wood frame, and uses stone and stucco cladding materials with a hip, tiled roof. The full, two-story front porch has a flat roof. The building also has column-over-pier Tuscan colonnade and polygonal oriels.

201-03 W. 34th Street - Vacant Lot

7. 206-08 W. 34th Street

Building Date: 1901; *Stories:* 3; *Plan:* Rectangular; *Style:* Walk-up; *Architect:* (Unknown); *Builder:* (Unknown); *Property Type:* Domestic, multiple dwelling; *Integrity:* Excellent

Description: This three-story building has a brick foundation, and uses brick cladding materials with a flat, composition roof. The building also has tripartite and paired windows, stone and brick trim, and recessed panels in entablature.

8. 215 W. 34th Street

Building Date: 1902; *Stories:* 2 1/2; *Plan:* Square; *Style:* Kansas City Shirtwaist; *Architect:* (Unknown); *Builder:* (Unknown); *Property Type:* Domestic, single dwelling; *Integrity:* Good.

Description: This 2 1/2-story building has a stone foundation, a wood frame, and uses brick and asbestos shingles cladding materials with a hip, composition roof. The full front porch has a hip roof. The building also has wide, bellcast eaves with modillions; and hip dormer with paired windows.

United States Department of the Interior
National Park Service

National Register of Historic Places Continuation Sheet

Section
number 7 Page 6

Old Hyde Park West Historic District
Jackson County, Missouri

9. 216 W. 34th Street

Building Date: 1902; *Stories:* 2 1/2; *Plan:* Square; *Style:* Two-family flat; *Architect:* (Unknown); *Builder:* (Unknown); *Property Type:* Domestic, multiple dwelling; *Integrity:* Fair.

Description: This 2 1/2-story building uses brick cladding materials with a hip, composition roof. The full, two-story front porch is half enclosed. The building also has thin Tuscan columns; slate shingled dormer walls; and stone lintels and sills.

10. 217 W. 34th Street

Building Date: 1902; *Stories:* 2 1/2; *Plan:* Square; *Style:* Kansas City Shirtwaist; *Architect:* (Unknown); *Builder:* (Unknown); *Property Type:* Domestic, single dwelling; *Integrity:* Good

Description: This 2 1/2-story building has a stone foundation, a wood frame, and uses brick and lap siding cladding materials with a hip, composition roof. The full front porch has a hip roof. The building also has wide, bellcast eaves with modillions, and hip dormer with paired windows.

11. 218 W. 34th Street

Building Date: 1901; *Stories:* 2 1/2; *Plan:* Rectangular; *Style:* Queen Anne; *Architect:* (Unknown); *Builder:* (Unknown); *Property Type:* Domestic, multiple dwelling; *Integrity:* Fair

Description: This 2 1/2-story building has a stone foundation, and uses brick cladding materials with a front gabled, composition roof. The full front porch is enclosed with a flat roof. The building also has bay windows; recessed tripartite window in gable; modillioned eaves; and brick beltcourse. **Noncontributing garage.**

12. 220 W. 34th Street

Building Date: 1901; *Stories:* 2 1/2; *Plan:* Square; *Style:* Kansas City Shirtwaist; *Architect:* (Unknown); *Builder:* (Unknown); *Property Type:* Domestic, multiple dwelling; *Integrity:* Fair.

Description: This 2 1/2-story building has a stone foundation, a wood frame, and uses brick and vinyl cladding materials with a hip, composition roof. The full front porch has a hip roof, and there is a rear deck. The building also has wide, bellcast eaves; contrasting brick quoins and window surrounds; and flared dormer walls. **Noncontributing garage.**

United States Department of the Interior
National Park Service

National Register of Historic Places Continuation Sheet

Section
number 7 Page 7

Old Hyde Park West Historic District
Jackson County, Missouri

13. 300 W. 34th Street

Building Date: 1911; *Stories:* 2 1/2; *Plan:* Irregular; *Style:* Two-family flat: Colonial Revival; *Architect:* (Unknown); *Builder:* (Unknown); *Property Type:* Domestic, multiple dwelling; *Integrity:* Excellent.

Description: This 2 1/2-story building has a stone foundation, and uses brick cladding materials with a gabled, composition roof. The full, two-story front porch has a hip roof. The building also has full-height, fluted Ionic colonnade; wide, modillioned eaves; and a two story, polygonal bay. **Noncontributing garage.**

14. 304 W. 34th Street

Building Date: 1914; *Stories:* 3; *Plan:* Rectangular; *Style:* Colonnaded double-loaded corridor; *Architect:* (Unknown); *Builder:* (Unknown); *Property Type:* Domestic, multiple dwelling; *Integrity:* Fair.

Description: This three-story building has a stone foundation, and uses brick cladding materials with a flat, composition roof. The front, colonnaded two-story porch has a flat roof. The building also has full-height brick posts and stone trim.

15. 20 W. 36th Street

Historic Name: Alps Apartments

Building Date: 1927; *Stories:* 5; *Plan:* Rectangular; *Style:* High rise apartment: Spanish Colonial; *Architect:* Harry Foster Almon; *Builder:* (Unknown); *Property Type:* Domestic, multiple dwelling; *Integrity:* Excellent

Description: This five-story building has a poured concrete foundation, and uses brick cladding materials with a flat composition roof. The building also has brick tapestry in upper corners; horizontal banding below beltcourse;; terra cotta beltcourse; medallions, coping and entrance surround; and stepped parapet with gable over central entrance.

16. 31 W. 36th Street (3601 Baltimore) *Historic Name:* William F. Shelley House

Previously listed (3/17/1978)

Building Date: 1887-89; *Stories:* 2 1/2; *Plan:* Irregular; *Style:* Queen Anne; *Architect:* (Unknown); *Builder:* (Unknown); *Property Type:* Domestic, single dwelling; *Integrity:* Excellent

Description: This 2 1/2-story building has a stone foundation, a brick frame, and uses brick cladding materials with a gabled, composition roof. The front porch is ell shaped with a hip roof. The building also has bracketed and modillioned eaves; turned porch posts with brackets and pendants; arched window openings; corbelled chimney; stone lintels and sills. The dwelling was constructed with elements of the Queen Anne and Italianate architectural styles combined in a "builder's vernacular." The main façade faces north. Exterior walls are pressed brick, common bond. East façade has projecting square bay, west façade has semi-hexagonal bay. Fenestration consists of double-hung windows symmetrically placed and three hinged leaded art glass windows produced by the Tiffany Studio. Porches cover all four entrances. The W.F. Shelley Residence is significant as an outstanding surviving example of a typical residential design found throughout the once fashionable

United States Department of the Interior
National Park ServiceNational Register of Historic Places
Continuation SheetSection
number 7 Page 8Old Hyde Park West Historic District
Jackson County, Missouri

neighborhood of Hyde Park. It is one of the oldest remaining residences built in Hyde Park, and remained in the ownership of the Shelley family through the 1970s. The cost of construction was approximately \$11,000. W.F. Shelley was treasurer for the Jarvas-Conklin Mortgage Trust Co. The house was placed on the National Register Listing in 1976.

17. 101-03 W. 36th Street

Building Date: 1909; *Stories:* 3; *Plan:* Rectangular; *Style:* Four-family flat; *Architect:* (Unknown); *Builder:* M.H. O'Connell; *Property Type:* Domestic, multiple dwelling; *Integrity:* Fair

Description: This three-story building has a stone foundation, and uses brick cladding materials with a flat, composition roof. The full, two-story front porch has a balcony. The building also has brick quoins; corbelled brick eaves and chimney flues; stone lintels and sills; two-story porch posts and Tuscan columns; and transoms.

18. 105-07 W. 36th Street

Building Date: 1909; *Stories:* 2; *Plan:* Rectangular; *Style:* Four-family flat; *Architect:* (Unknown); *Builder:* (Unknown); *Property Type:* Domestic, multiple dwelling; *Integrity:* Good

Description: This two-story building has a stone foundation, and uses brick cladding materials with a flat, composition roof. The full, two-story front porch has a hip roof. The building also has brick quoins; corbelled brick eaves and chimney flues; stone lintels and sills; two-story porch posts and Tuscan columns; and transoms.

19. 106-08 W. 36th Street

Building Date: c. 1919; *Stories:* 3; *Plan:* Rectangular; *Style:* Walk-up; *Architect:* (Unknown); *Builder:* McCanless Realty, Co.; *Property Type:* Domestic, multiple dwelling; *Integrity:* Good

Description: This three-story building has a stone foundation, and uses brick cladding materials with a flat, composition roof. The building also has pent roof with wide projecting modillioned eaves; stone and brick trim; and tripartite windows.

109-11 W. 36th Street – Vacant Lot**20. 110-12 W. 36th Street**

Building Date: 1907; *Stories:* 3; *Plan:* Rectangular; *Style:* Colonnaded Walk-up; *Architect:* (Unknown); *Builder:* (Unknown); *Property Type:* Domestic, multiple dwelling; *Integrity:* Good

Description: This three-story building has a brick foundation, and uses brick cladding materials with a flat, composition roof. The full, three-story front porch is colonnaded with a flat roof. The building also has three story, column-over-pier colonnade; stone trim; wide projecting eaves; and sidelights.

United States Department of the Interior
National Park Service

National Register of Historic Places Continuation Sheet

Section
number 7 Page 9

Old Hyde Park West Historic District
Jackson County, Missouri

21. 114-16 W. 36th Street

Building Date: 1907; *Stories:* 3; *Plan:* Rectangular; *Style:* Colonnaded Walk-up; *Architect:* (Unknown); *Builder:* (Unknown); *Property Type:* Domestic, multiple dwelling; *Integrity:* Good

Description: This three-story building has a brick foundation, and uses brick cladding materials with a flat, composition roof. The full, three-story front porch is colonnaded with a flat roof. The building also has three story, column-over-pier colonnade; stone trim; wide projecting eaves; and sidelights.

22. 200-02 W. 36th Street

Building Date: ca. 1905; *Stories:* 3; *Plan:* Rectangular; *Style:* Colonnaded Walk-up; *Architect:* (Unknown); *Builder:* (Unknown); *Property Type:* Domestic, multiple dwelling; *Integrity:* Good

Description: This three-story building has a stone foundation, and uses brick cladding materials with a flat, composition roof. The 1/2, three-story front porch is colonnaded with a hip roof. The building also has three story, column-over-pier colonnade; decorative brick or stone trim; wide modillioned eaves; Tuscan columns; and porch doors flanked by leaded glass sidelights.

23. 204-06 W. 36th Street (noncontributing)

Building Date: 1962; *Stories:* 2; *Plan:* Square; *Style:* Modern Minimalist; *Architect:* (Unknown); *Builder:* (Unknown); *Property Type:* Domestic, multiple dwelling; *Integrity:* Excellent.

Description: This two-story building has a poured concrete foundation, and uses brick cladding materials with a hip, composition roof. The front portico has a hip roof. The building also has wide eaves and tripartite windows.

24. 210-12 W. 36th Street

Building Date: 1915; *Stories:* 3; *Plan:* Rectangular; *Style:* Colonnaded Walk-up; *Architect:* (Unknown); *Builder:* (Unknown); *Property Type:* Domestic, multiple dwelling; *Integrity:* Good

Description: This three-story building has a brick foundation, and uses brick cladding materials with a flat, composition roof. The 1/2, enclosed front porch is colonnaded. The building also has wide eaves with paired brackets at corners; tripartite, double-hung windows with decorative, multi-light upper sash; projecting pavilions flanking central entrance bay; and stone lintels and sills.

25. 16-18 W. 37th Street

Building Date: 1920; *Stories:* 3; *Plan:* Rectangular; *Style:* Walk-up; *Architect:* C.B. Sloan; *Builder:* Geo. M. Bliss Cons. Co.; *Property Type:* Domestic, multiple dwelling; *Integrity:* Good

United States Department of the Interior
National Park Service

National Register of Historic Places Continuation Sheet

Section
number 7 Page 10

Old Hyde Park West Historic District
Jackson County, Missouri

Description: This three-story building has a stone foundation, and uses brick cladding materials with a flat, composition roof. The front portico has a flat roof. The building also has stone and brick trim, and the portico has paired windows.

26. 215-17 W. 37th Street

Building Date: 1925; *Stories:* 2; *Plan:* Rectangular; *Style:* Colonnaded Four-Family Flat; *Architect:* (Unknown); *Builder:* (Unknown); *Property Type:* Domestic, multiple dwelling; *Integrity:* Excellent

Description: This two-story building has a brick foundation, and uses brick cladding materials with a flat, composition roof. The 1/2, two-story front porch is colonnaded with a flat roof. The building also has modillioned and dentiled eaves; projecting colonnade; contrasting brick and stone trim; and turned balusters.

27. 219-21 W. 37th Street

Building Date: 1909; *Stories:* 2; *Plan:* Rectangular; *Style:* Colonnaded four-family flat
Architect: (Unknown); *Builder:* (Unknown); *Property Type:* Domestic, multiple dwelling; *Integrity:* Excellent

Description: This two-story building has a brick foundation, and uses brick cladding materials with a flat, composition roof. The 1/2, two-story front porch is colonnaded with a flat roof. The building also has modillioned and dentiled eaves; projecting colonnade; contrasting brick and stone trim; and turned balusters.

303-05 W. 37th Street - Vacant Lot

28. 11-15 W. 38th Street

Building Date: 1908; *Stories:* 2; *Plan:* Square; *Style:* Four-family flat; *Architect:* Matt O'Connell; *Builder:* (Unknown); *Property Type:* Domestic, multiple dwelling; *Integrity:* Good

Description: This two-story building has a stone foundation, brick cladding materials and a flat, composition roof. The full, two-story front porch has a flat roof. The building also has fluted Doric columns; matchstick balustrade with turned newel posts; parapet with brick ornament and stone coping; stone sills; and transoms.

17 W. 38th Street - Vacant Lot

29. 18 W. 38th Street

Historic Name: R. Barton Greene Residence

Building Date: 1897; *Stories:* 2 1/2; *Plan:* Square; *Style:* Colonial Revival; *Architect:* W.H. Rose; *Builder:* R. Barton Green, real; *Property Type:* Domestic, single dwelling; *Integrity:* Good

Description: This 2 1/2-story building has a stone foundation, a wood frame, and uses wood shingles cladding materials with a hip, composition roof. The 1/3 front porch has a flat roof. The building also has wide

United States Department of the Interior
National Park ServiceNational Register of Historic Places
Continuation SheetSection
number 7 Page 11Old Hyde Park West Historic District
Jackson County, Missouri

modillioned eaves; bowed portico with Ionic columns; fanlight and sidelights with diamond pane glass; cornerboards with Ionic capitals; and hip dormers and paired windows.

21 W. 38th Street - Vacant Lot**25 W. 38th Street - Vacant Lot****30. 100 W. 38th Street (noncontributing)**

Building Date: 1967; *Stories:* 2; *Plan:* Rectangular; *Style:* Modern; *Architect:* Unknown; *Builder:* DiCarlo Construction; *Property Type:* Domestic, Multiple Dwelling; *Integrity:* Good

Description: This two-story apartment building that is a noncontributing structure to the district.

31. 201-03 W. 38th Street

Building Date: 1921; *Stories:* 3; *Plan:* Rectangular; *Style:* Colonnaded Walk-up; *Architect:* (Unknown); *Builder:* (Unknown); *Property Type:* Domestic, multiple dwelling; *Integrity:* Excellent

Description: This three-story building has a stone foundation, and uses brick cladding materials with a flat, composition roof. The three-story front porch is colonnaded. The building also has three story, column-over-pier colonnade; fluted Doric columns; turned balusters; stone trim; projecting colonnaded porches flank the central entrance bay; and wide eaves.

32. 205-07 W. 38th Street

Building Date: 1921; *Stories:* 3; *Plan:* Rectangular; *Style:* Colonnaded Walk-up; *Architect:* (Unknown); *Builder:* (Unknown); *Property Type:* Domestic, multiple dwelling; *Integrity:* Excellent

Description: This three-story building has a stone foundation, and uses brick cladding materials with a flat, composition roof. The three-story front porch is colonnaded. The building also has three story, column-over-pier colonnade; fluted Doric columns; patterned balusters; stone trim; projecting colonnaded porches flank central entrance bay; and wide eaves.

33. 209-11 W. 38th Street

Building Date: 1921; *Stories:* 3; *Plan:* Rectangular; *Style:* Colonnaded Walk-up; *Architect:* (Unknown); *Builder:* (Unknown); *Property Type:* Domestic, multiple dwelling; *Integrity:* Excellent

Description: This three-story building has a stone foundation, and uses brick cladding materials with a flat, composition roof. The three-story front porch is colonnaded. The building also has three story, column-over-pier colonnade; fluted Doric columns; patterned balusters; stone trim; projecting colonnaded porches flank central entrance bay; and wide eaves.

United States Department of the Interior
National Park ServiceNational Register of Historic Places
Continuation SheetSection
number 7 Page 12Old Hyde Park West Historic District
Jackson County, Missouri**34. 215-17 W. 38th Street**

Building Date: 1921; *Stories:* 3; *Plan:* Rectangular; *Style:* Colonnaded Walk-up; *Architect:* (Unknown); *Builder:* (Unknown); *Property Type:* Domestic, multiple dwelling; *Integrity:* Excellent

Description: This three-story building has a stone foundation, and uses brick cladding materials with a flat, composition roof. The three-story front porch is colonnaded. The building also has three story, column-over-pier colonnade; fluted Doric columns; matchstick balusters; stone trim; projecting colonnaded porches flank central entrance bay; and wide eaves.

35. 219-21 W. 38th Street

Building Date: 1921; *Stories:* 3; *Plan:* Rectangular; *Style:* Colonnaded Walk-up; *Architect:* (Unknown); *Builder:* (Unknown); *Property Type:* Domestic, multiple dwelling; *Integrity:* Excellent

Description: This three-story building has a stone foundation, and uses brick cladding materials with a flat, composition roof. The three-story front porch is colonnaded. The building also has three story, column-over-pier colonnade; fluted Doric columns; patterned balusters; stone trim; projecting colonnaded porches flank central entrance bay; and wide eaves.

36. 223-25 W. 38th Street

Building Date: 1921; *Stories:* 3; *Plan:* Rectangular; *Style:* Colonnaded Walk-up; *Architect:* (Unknown); *Builder:* (Unknown); *Property Type:* Domestic, multiple dwelling; *Integrity:* Good

Description: This three-story building has a stone foundation, and uses brick cladding materials with a flat, composition roof. The three-story front porch is colonnaded. The building also has three story, column-over-pier colonnade; fluted Doric columns; matchstick balusters; stone trim; projecting colonnaded porches flank central entrance bay; and wide eaves.

37. 307-09 W. 38th Street

Building Date: 1911; *Stories:* 2 1/2; *Plan:* Rectangular; *Style:* Two-family flat; *Architect:* (Unknown); *Builder:* (Unknown); *Property Type:* Domestic, multiple dwelling; *Integrity:* Poor

Description: This 2 1/2-story building has a stone foundation, a wood frame, and uses stucco cladding materials with a gabled front, composition roof. The 1/3, two-story front porch is recessed.

United States Department of the Interior
National Park Service

National Register of Historic Places Continuation Sheet

Section
number 7 Page 13

Old Hyde Park West Historic District
Jackson County, Missouri

38. 100-06 W. Armour Blvd.

Historic Name: Collins Flats

Previously listed as part of *Armour Boulevard Multiple Resources – District I (7/28/1983)*

Building Date: 1902; *Stories:* 3 1/2; *Plan:* Rectangular; *Style:* Double loaded corridor; Spanish; *Architect:* John McKecknie; *Builder:* W.H. Collins, real estate; *Property Type:* Domestic, multiple dwelling; *Integrity:* Good

Description: This three+-story building has a stone foundation, and uses stucco and stone cladding materials with a mansard, tiled roof. The 1/2, three-story front porch has a balcony. The building also has projecting pavilions; wide eaves with modillions and knee braces; projecting porches with pier-over-column design; jack arches and quoining; and wide entablature. It is on the National Register. The building contained 12 apartments of 6 rooms and a bath each. The interior arrangement of the rooms allowed for them to be opened into one suite. The building contained both back and front porches to ensure the privacy of each tenant.

39. 108-10 W. Armour Blvd.

Previously listed as part of *Armour Boulevard Multiple Resources – District I (7/28/1983)*

Building Date: 1903; *Stories:* 2; *Plan:* Rectangular; *Style:* Two-family flat; *Architect:* John McKecknie; *Builder:* (Unknown); *Property Type:* Domestic, multiple dwelling; *Integrity:* Good

Description: This two-story building has a stone foundation, and uses brick cladding materials with a flat, composition roof. The 2/3, two-story front porch has a balcony. The building also has wide, flat eaves with modillions; two-story, projecting porch with pier-over-column design; banded first story brickwork; and pilasters with recessed panels. This is one of three vertically identical units that stand adjacent to each other. Erected on the Mastin tract of land, the apartments were designed for Morris Harris.

40. 109-11 W. Armour Blvd

Previously listed as part of *Armour Boulevard Multiple Resources – District I (7/28/1983)*

Date: c. 1906; *Stories:* 2; *Plan:* Rectangular; *Style:* Two-family flat; *Architect:* John McKecknie; *Builder:* (Unknown); *Property Type:* Domestic, multiple dwelling; *Integrity:* Good

Description: This two-story building has a stone foundation, and uses brick cladding materials with a flat, composition roof. The two-story porch is ell shaped with a flat roof. The building also has flat parapeted roof; wide modillioned eaves; two story, wrap around porch with pier-over-column design; flat entrance hood with brackets and modillions; and contrasting brick surrounds.

41. 112-14 W. Armour Blvd.

Previously listed as part of *Armour Boulevard Multiple Resources – District I (7/28/1983)*

Building Date: 1903; *Stories:* 2; *Plan:* Rectangular; *Style:* Two-family flat; *Architect:* John McKecknie; *Builder:* (Unknown); *Property Type:* Domestic, multiple dwelling; *Integrity:* Good

United States Department of the Interior
National Park Service

National Register of Historic Places Continuation Sheet

Section
number 7 Page 14

Old Hyde Park West Historic District
Jackson County, Missouri

Description: This two-story building has a stone foundation, and uses brick cladding materials with a flat, composition roof. The building also has wide, flat eaves with modillions and dentils; quoins; two-story, wrap around porch with pier-over-column design; and pilasters with recessed panels. This is one of three vertically identical units that stand adjacent to each other. Erected on the Mastin tract of land for Morris Harris.

42. 113-15 W. Armour Blvd.

Previously listed as part of *Armour Boulevard Multiple Resources – District I (7/28/1983)*

Building Date: c. 1906; *Stories:* 2 1/2; *Plan:* Rectangular; *Style:* Two-family flat, Craftsman; *Architect:* John McKecknie; *Builder:* (Unknown); *Property Type:* Domestic, multiple dwelling; *Integrity:* Excellent

Description: This 2 1/2-story building has a stone foundation, and uses brick cladding materials with a flat, composition roof. The full, two-story front porch has a balcony and full-height triple piers. There is also a two-story rear porch. The building also has decorative brick eaves; stone trim and parapeted and bowed central bay.

43. 116-18 W. Armour Blvd.

Previously listed as part of *Armour Boulevard Multiple Resources – District I (7/28/1983)*

Building Date: 1903; *Stories:* 2; *Plan:* Square; *Style:* Two-family flat; *Architect:* John McKecknie; *Builder:* (Unknown); *Property Type:* Domestic, multiple dwelling; *Integrity:* Good

Description: This two-story building has a stone foundation, and uses brick cladding materials with a flat, composition roof. The 2/3, two-story front porch has a flat roof. The building also has two story, pier-over-column apartment; wide modillioned eaves; patterned brick entablature; quoins; and pilasters with recessed panels. Erected on the Mastin tract of land, this is one of three apartments designed for Morris Harris.

44. 117-19 W. Armour Blvd.

Previously listed as part of *Armour Boulevard Multiple Resources – District I (7/28/1983)*

Building Date: c. 1906; *Stories:* 2 1/2; *Plan:* Rectangular; *Style:* Two-family flat, Craftsman; *Architect:* John McKecknie; *Builder:* (Unknown); *Property Type:* Domestic, multiple dwelling; *Integrity:* Excellent

Description: This 2 1/2-story building has a stone foundation, and uses brick cladding materials with a flat, composition roof. The full, two-story front porch has a balcony, and full-height paired piers and flat roofs with modillioned eaves. The building also has decorative brick work; stone trim; and parapeted and bowed central bay.

United States Department of the Interior
National Park ServiceNational Register of Historic Places
Continuation SheetSection
number 7 Page 15Old Hyde Park West Historic District
Jackson County, Missouri**45. 121-23 W. Armour Blvd.**Previously listed as part of *Armour Boulevard Multiple Resources – District I (7/28/1983)**Building Date:* c 1906; *Stories:* 2; *Plan:* Rectangular; *Style:* Two-family flat, Craftsman; *Architect:* John McKecknie (attributed) *Builder:* (Unknown); *Property Type:* Domestic, multiple dwelling; *Integrity:* Excellent

Description: This two-story building has a stone foundation, and uses brick cladding materials with a flat, composition roof. The full, two-story front porch has a flat roof and full-height triple piers. The building also has wide, brick eaves with modillions; stone trim; and a parapeted and bowed central bay with decorative brick work.

46. 201-09 W. Armour Blvd. (noncontributing) Name: American Red Cross Building*Building Date:* 1964; *Stories:* 3; *Plan:* Rectangular; *Style:* Modern; *Architect:* Unknown; *Builder:* Bennett Construction Company *Property Type:* Commercial Offices; *Integrity:* Excellent

Description: This three-story building has a poured concrete foundation, and uses brick and concrete cladding materials with a flat, composition roof. The building has vertical ribbons of single pane fixed window divided by brown aluminum panels. The parking lot for the facility is located to the south. There is a six-bay, noncontributing garage on the south side of the property. It has metal siding, a flat roof, and a poured concrete foundation. **Noncontributing garage.**

47. 200-02 W. Armour Blvd. Historic Name: Del Monte ApartmentPreviously listed as part of *Armour Boulevard Multiple Resources – District I (7/28/1983)**Building Date:* 1920; *Stories:* 4; *Plan:* U-shaped; *Style:* Double loaded corridor, Craftsman; *Architect:* Nell E. Peters; *Builder:* Charles E. Phillips; *Property Type:* Domestic, multiple dwelling; *Integrity:* Excellent

Description: This four-story building has a brick foundation, and uses brick cladding materials with a flat, composition roof. The front portico has a deck. The building also has projecting and pavilions form U-shaped plan; stone and brick trim; and paired windows. The building contained 54 apartments. The interior featured oak floors and trim, and fireproof basement and halls. In 1960 extensive remodeling and refurbishing of the interior was undertaken.

48. 212-14 W. Armour Blvd.Previously listed as part of *Armour Boulevard Multiple Resources – District I (7/28/1983)**Building Date:* 1905; *Stories:* 2; *Plan:* Square; *Style:* Two-family flat; *Architect:* John McKecknie; *Builder:* (Unknown); *Property Type:* Domestic, multiple dwelling; *Integrity:* Fair

Description: This two-story building has a stone foundation, and uses brick cladding materials with a flat, composition roof. The full, two-story front porch has a balcony. The building also has stone trim.

United States Department of the Interior
National Park Service

National Register of Historic Places Continuation Sheet

Section
number 7 Page 16

Old Hyde Park West Historic District
Jackson County, Missouri

49. 216-18 W. Armour Blvd.

Previously listed as part of *Armour Boulevard Multiple Resources – District I (7/28/1983)*

Building Date: 1905; *Stories:* 2; *Plan:* Square; *Style:* Two-family flat, Craftsman; *Architect:* John McKecknie; *Builder:* (Unknown); *Property Type:* Domestic, multiple dwelling; *Integrity:* Good

Description: This two-story building has a stone foundation, and uses brick cladding materials with a flat, composition roof. The full, two-story front porch has a balcony. The building also has arched parapet over central bay; and brick and stone trim.

50. 220-22 W. Armour Blvd.

Previously listed as part of *Armour Boulevard Multiple Resources – District I (7/28/1983)*

Building Date: 1905; *Stories:* 2; *Plan:* Rectangular; *Style:* Two-family flat; *Architect:* John McKecknie; *Builder:* (Unknown); *Property Type:* Domestic, multiple dwelling; *Integrity:* Fair

Description: This two-story building has a stone foundation, and uses brick cladding materials with a flat, composition roof. The two-story front porch has a balcony. The building also has stone and brick trim.

51. 300-06 W. Armour Blvd.

Historic Name: Ellison Hotel

Previously listed as part of *Armour Boulevard Multiple Resources – District I (7/28/1983)*

Building Date: 1928; *Stories:* 7; *Plan:* U-shaped; *Style:* English Gothic; *Architect:* Nelle E. Peters; *Builder:* (Unknown); *Property Type:* Domestic, multiple dwelling; *Integrity:* Excellent

Description: This seven-story building has a stone foundation, and uses brick cladding materials. The first story is fenestrated with round arched windows trimmed with terra cotta. The buildings' two units are bridged by a central portal with terra cotta surround. Strong vertical emphasis is created by the brick piers, which rise from the 2nd through 7th stories. The flanking bays on each unit carry a steep gable. The parapet wall is decorated with intermittent terra cotta pinnacles. Terra cotta is also used for the quoining that occurs in both units on the flanking bays. Begun in late 1926 for the Phillips Building Company, the hotel originated as a single unit. The second identical unit was constructed some months later. The hotel featured such modern conveniences as automatic elevators and mechanical refrigeration. Studio apartments were available in the buildings, which was a new type of unit for Armour Boulevard.

52. 301-07 W. Armour Blvd.

Historic Name: The Westport; The Chief

Previously listed as part of *Armour Boulevard Multiple Resources – District I (7/28/1983)*

Building Date: 1929, 1944; *Stories:* 10; *Plan:* Rectangular; *Style:* High rise apartment, Moderne; *Architect:* John R. Brunt, Emil O. Bayer; *Builder:* H. Kelley and Sons; *Property Type:* Domestic, multiple dwelling; *Integrity:* Excellent

United States Department of the Interior
National Park Service

National Register of Historic Places Continuation Sheet

Section
number 7 Page 17

Old Hyde Park West Historic District
Jackson County, Missouri

Description: This ten-story building uses brick cladding materials and has a flat, composition roof. The building, originally the Westport Arms Apartments, has contrasting brick; banded first story, six articulated, vertical bands in central bay separating individual windows; horizontal banding in eaves; and paired and tripartite windows in flanking sections. Construction of this building was halted in the 1929 financial collapse. It remained a skeleton structure for 16 years.

53. 3319 Baltimore

Building Date: 1901; *Stories:* 2 1/2; *Plan:* Square; *Style:* Kansas City Shirtwaist; *Architect:* (Unknown); *Builder:* (Unknown); *Property Type:* Domestic, single dwelling; *Integrity:* Fair

Description: This 2 1/2-story building uses asbestos shingles and brick cladding materials and has a hip, composition roof. The full front porch has a gabled roof. The building also has decorative stick work on the porch; and brick posts and piers.

54. 3321 Baltimore

Building Date: 1906; *Stories:* 2 1/2; *Plan:* Square; *Style:* Kansas City Shirtwaist; *Architect:* (Unknown); *Builder:* (Unknown); *Property Type:* Domestic, single dwelling; *Integrity:* Fair

Description: This 2 1/2-story building has a wood frame and uses asbestos shingles and brick cladding materials and has a hip, composition roof. The full front porch has a hip roof. The building also brick porch posts; and matchstick balustrade. lintels and sills.

55. 3327 Baltimore

Building Date: 1898; *Stories:* 2 1/2; *Plan:* Square; *Style:* Colonial Revival; *Architect:* ? & Welsh; *Builder:* (Unknown); *Property Type:* Domestic, single dwelling; *Integrity:* Good

Description: This 2 1/2-story building has a stone foundation, a wood frame, and uses asbestos shingles and brick cladding materials with a hip, composition roof. The 1/3 front portico has a flat roof. The building also has pedimented entrance porch with swag; sidelights and transom; dentiled eaves; and a truncated hip roof.

56. 3329 Baltimore

Building Date: 1902; *Stories:* 2 1/2; *Plan:* Square; *Style:* Kansas City Shirtwaist; *Architect:* (Unknown); *Builder:* (Unknown); *Property Type:* Domestic, single dwelling; *Integrity:* Good

Description: This 2 1/2-story building has a stone foundation, a wood frame, wood shingles and brick cladding with a hip, composition roof. The full front porch has a hip roof. The building also has asymmetrical porch with pedimented gable; brick posts on stone foundation; and wood shingled second story. **Garage: 1-story wood shingled garage with gabled roof and wooden doors. (contributing).**

United States Department of the Interior
National Park Service

National Register of Historic Places Continuation Sheet

Section
number 7 Page 18

Old Hyde Park West Historic District
Jackson County, Missouri

57. 3330 Baltimore

Building Date: 1902; *Stories:* 2 1/2; *Plan:* Square; *Style:* Four Square; *Architect:* (Unknown); *Builder:* (Unknown); *Property Type:* Domestic, single dwelling; *Integrity:* Good

Description: This 2 1/2-story building has a stone foundation, and uses brick cladding materials with a hip, composition roof. The full front porch has a hip roof. The building also has stone lintels and sills; Tuscan columns; stained glass window transom; and decorative brick work. **Garage: 1-story clapboard garage with gabled roof and wood doors. (contributing).**

58. 3334 Baltimore

Building Date: 1902; *Stories:* 2 1/2; *Plan:* Square; *Style:* Colonial Revival; *Architect:* (Unknown); *Builder:* (Unknown); *Property Type:* Domestic, single dwelling; *Integrity:* Good

Description: This 2 1/2-story building has a stone foundation, and uses brick cladding materials with a hip, composition roof. The full front porch has a flat roof. The building also has contrasting brick quoining; molded cornice detailing; slate-sided dormers; and striped brick posts.

59. 3335 Baltimore

Building Date: 1904; *Stories:* 2 1/2; *Plan:* Square; *Style:* Kansas City Shirtwaist; *Architect:* (Unknown); *Builder:* (Unknown); *Property Type:* Domestic, single dwelling; *Integrity:* Good

Description: This 2 1/2-story building has a wood frame, and uses asbestos shingles and brick cladding materials with a hip, composition roof. The full front porch has a gabled roof. The building also has full-width pedimented porch; and matchstick balustrade.

60. 3336 Baltimore

Building Date: 1902; *Stories:* 2 1/2; *Plan:* Rectangular; *Style:* Colonial Revival; *Architect:* (Unknown); *Builder:* (Unknown); *Property Type:* Domestic, single dwelling; *Integrity:* Good

Description: This 2 1/2-story building has a stone foundation, and uses brick cladding materials with a front gabled, composition roof. The full front porch has a hip roof. The building also has second story bowed bay; stone lintels and sills; decorative upper sash in gable; and decorative brick work on chimney. **Garage: 1-story clapboard garage with gabled roof and modern doors. (noncontributing).**

61. 3337 Baltimore

Building Date: 1904; *Stories:* 2 1/2; *Plan:* Square; *Style:* Kansas City Shirtwaist; *Architect:* (Unknown); *Builder:* (Unknown); *Property Type:* Domestic, single dwelling; *Integrity:* Fair

United States Department of the Interior
National Park Service

National Register of Historic Places Continuation Sheet

Section
number 7 Page 19

Old Hyde Park West Historic District
Jackson County, Missouri

Description: This 2 1/2-story building has a wood frame, and uses vinyl and brick cladding materials with a hip, composition roof. The full front porch has a gabled roof. The building also has brick porch piers and posts.

62. 3340 Baltimore

Building Date: 1902; *Stories:* 2 1/2; *Plan:* Square; *Style:* Kansas City Shirtwaist; *Architect:* (Unknown); *Builder:* (Unknown); *Property Type:* Domestic, single dwelling; *Integrity:* Good

Description: This 2 1/2-story building has a stone foundation, a wood frame, and uses asbestos shingles and stone cladding materials. The full front porch has a hip roof. The building also has leaded transom and door; and bellcast eaves.

63. 3341 Baltimore

Building Date: 1904; *Stories:* 2 1/2; *Plan:* Square; *Style:* Kansas City Shirtwaist; *Architect:* (Unknown); *Builder:* (Unknown); *Property Type:* Domestic, single dwelling; *Integrity:* Fair

Description: This 2 1/2-story building has a stone foundation, a wood frame, and uses vinyl and stone cladding materials with a hip, composition roof. The full front porch has a hip roof. The building also has Tuscan columns; and bellcast eaves.

64. 3343 Baltimore

Building Date: 1904; *Stories:* 2 1/2; *Plan:* Square; *Style:* Kansas City Shirtwaist; *Architect:* (Unknown); *Builder:* (Unknown); *Property Type:* Domestic, single dwelling; *Integrity:* Fair

Description: This 2 1/2-story building has a stone foundation, a wood frame, and uses asbestos shingles and stone cladding materials, with a hip composition roof. The full front porch is enclosed with a gabled roof. The building also has bellcast eaves and a pedimented front porch. **Garage: 1-story clapboard garage with gabled roof and modern doors. (noncontributing).**

3344 Baltimore Vacant Lot

65. 3345 Baltimore

Building Date: 1904; *Stories:* 2 1/2; *Plan:* Square; *Style:* Kansas City Shirtwaist; *Architect:* (Unknown); *Builder:* (Unknown); *Property Type:* Domestic, single dwelling; *Integrity:* Fair

Description: This 2 1/2-story building has a stone foundation, a wood frame, and uses vinyl and brick cladding materials, with a hip, composition roof. The full front porch is enclosed with a gabled roof. The building also has bellcast gablet; pedimented porch; and asymmetrically placed gable dormer.

United States Department of the Interior
National Park ServiceNational Register of Historic Places
Continuation SheetSection
number 7 Page 20Old Hyde Park West Historic District
Jackson County, Missouri**66. 3347 Baltimore**

Building Date: 1904; *Stories:* 2 1/2; *Plan:* Square; *Style:* Kansas City Shirtwaist; *Architect:* (Unknown);
Builder: (Unknown); *Property Type:* Domestic, single dwelling; *Integrity:* Fair

Description: This 2 1/2-story building has a stone foundation, a wood frame, and uses asbestos shingles and stone cladding materials, with a hip composition roof. The full front porch has a hip roof. The building also has a porch awning and bellcast eaves. **Garage: 1-story clapboard garage with gabled roof and wood doors. (contributing).**

67. 3351 Baltimore

Building Date: 1904; *Stories:* 2 1/2; *Plan:* Square; *Style:* Kansas City Shirtwaist; *Architect:* (Unknown);
Builder: (Unknown); *Property Type:* Domestic, single dwelling; *Integrity:* Fair

Description: This 2 1/2-story building has a stone foundation, a wood frame, and uses asbestos shingles and brick cladding materials, with a hip, composition roof. The full front porch has a gabled roof. The building also has brick posts and piers; a pedimented front porch; and bellcast eaves.

3354 Baltimore - Vacant Lot**68. 3355 Baltimore**

Building Date: 1904; *Stories:* 2 1/2; *Plan:* Square; *Style:* Kansas City Shirtwaist; *Architect:* (Unknown);
Builder: (Unknown); *Property Type:* Domestic, single dwelling; *Integrity:* Fair

Description: This 2 1/2-story building has a stone foundation, a wood frame, and uses asbestos shingles and stone cladding materials, with a hip, composition roof. The full front porch has a hip roof. The building also has molded concrete block first story and foundation, and a bellcast dormer.

3358 Baltimore - Vacant Lot**69. 3359 Baltimore**

Building Date: ca. 1904; *Stories:* 2 1/2; *Plan:* Square; *Style:* Kansas City Shirtwaist; *Architect:* (Unknown);
Builder: (Unknown); *Property Type:* Domestic, single dwelling; *Integrity:* Fair

Description: This 2 1/2-story building has a stone foundation, a wood frame, and uses asbestos shingles and stone cladding materials, with a front gabled, composition roof. The full front porch has a gabled roof. The building also has battered newel and matchstick balustrade; bellcast eaves with cornice returns; and Tuscan columns. **Garage: 1-story vinyl sided garage with gabled roof and modern doors. (noncontributing).**

United States Department of the Interior
National Park ServiceNational Register of Historic Places
Continuation SheetSection
number 7 Page 21Old Hyde Park West Historic District
Jackson County, Missouri**3362 Baltimore - Vacant Lot**

70. 3401 Baltimore *Historic Name:* John G. Groves Residence
Building Date: 1902; *Stories:* 2 1/2; *Plan:* Square; *Style:* Two-family flat; *Architect:* (Unknown); *Builder:* (Unknown); *Property Type:* Domestic, multiple dwelling; *Integrity:* Good

Description: This 2 1/2-story building has a stone foundation, and uses brick cladding materials, with a hip, composition roof. The 3/4 front porch has a hip roof. The building also has contrasting brick window surrounds and quoins; stone sills; and bracketed eaves. **Garage: 1-story asbestos shingle garage with gabled roof and modern doors. (noncontributing).**

71. 3404 Baltimore
Building Date: 1898; *Stories:* 2 1/2; *Plan:* Square; *Style:* Kansas City Shirtwaist; *Architect:* (Unknown); *Builder:* (Unknown); *Property Type:* Domestic, single dwelling; *Integrity:* Poor

Description: This 2 1/2-story building has a stone foundation, a wood frame, and uses asbestos shingles and brick cladding materials, with a hip, composition roof. The full front porch has a hip roof. The building also has asymmetrical porch with dentiled eaves and swag in pediment. **Garage: 1-story clapboard garage with gabled roof and modern doors. (noncontributing).**

72. 3405 Baltimore
Building Date: 1904; *Stories:* 2 1/2; *Plan:* Square; *Style:* Four Square; *Architect:* (Unknown); *Builder:* (Unknown); *Property Type:* Domestic, single dwelling; *Integrity:* Excellent

Description: This 2 1/2-story building has a stone foundation, a wood frame, and uses lap siding and brick cladding materials, with a hip, composition roof. The full front porch has a hip roof. The building also has molded window surrounds; matchstick balustrade with battered newel post.

73. 3410 Baltimore
Building Date: 1901; *Stories:* 2 1/2; *Plan:* Irregular; *Style:* Craftsman; *Architect:* (Unknown); *Builder:* (Unknown); *Property Type:* Domestic, single dwelling; *Integrity:* Excellent

Description: This 2 1/2-story building has a stone foundation, a stone frame, and uses stone cladding materials, with a hip, composition roof. The 2/3 front porch has a hip roof. The building also has second story bay with decorative sash; decorative upper sash; and projecting pavilion.

United States Department of the Interior
National Park Service

National Register of Historic Places Continuation Sheet

Section
number 7 Page 22

Old Hyde Park West Historic District
Jackson County, Missouri

74. 3411 Baltimore

Building Date: 1902; *stories:* 2 1/2; *Plan:* Square; *Style:* Kansas City Shirtwaist; *Architect:* (Unknown); *Builder:* Dr. James C. Stewart (attrib.); *Property Type:* Domestic, single dwelling; *Integrity:* Fair

Description: This 2 1/2-story building has a stone foundation, a wood frame, and uses asbestos shingles and stone cladding materials, with a hip, composition roof. The full front porch has a hip roof. The building also has offset bellcast dormer and modillioned eaves.

75. 3412 Baltimore

Building Date: c. 1898; *Stories:* 1 1/2; *Plan:* Rectangular; *Style:* Vernacular; *Architect:* (Unknown); *Builder:* (Unknown); *Property Type:* Domestic, single dwelling; *Integrity:* Fair

Description: Originally associated with 3416 Baltimore as a Carriage House. This 1 1/2 story building has a stone foundation, a wood frame, and uses lap siding cladding materials, with a side gabled, composition roof. The building also has a gabled wall dormer.

76. 3415 Baltimore

Building Date: 1902; *Stories:* 2 1/2; *Plan:* Square; *Style:* Kansas City Shirtwaist; *Architect:* (Unknown); *Builder:* Dr. James C. Stewart (attrib.); *Property Type:* Domestic, single dwelling; *Integrity:* Fair

Description: This 2 1/2-story building has a stone foundation, a wood frame, and uses asbestos shingles and brick cladding materials, with a hip, composition roof. The full front porch has a hip roof. The building also has an offset bellcast dormer and modillioned porch eaves.

77. 3416 Baltimore

Building Date: 1898; *Stories:* 2 1/2; *Plan:* Square; *Style:* Kansas City Shirtwaist; *Architect:* (Unknown); *Builder:* (Unknown); *Property Type:* Domestic, single dwelling; *Integrity:* Excellent

Description: This 2 1/2-story building has a brick foundation, a wood frame, and uses lap siding and brick cladding materials, with a hip, composition roof. The full front porch has a hip roof. The building also has matchstick balustrade; dentiled eaves; bay window; and stone beltcourse and sills.

United States Department of the Interior
National Park Service

National Register of Historic Places Continuation Sheet

Section
number 7 Page 23

Old Hyde Park West Historic District
Jackson County, Missouri

78. 3417 Baltimore

Building Date: 1898; *Stories:* 2 1/2; *Plan:* Square; *Style:* Four Square; *Architect:* (Unknown); *Builder:* (Unknown); *Property Type:* Domestic, single dwelling; *Integrity:* Good

Description: This 2 1/2-story building has a stone foundation, a wood frame, and uses vinyl and brick cladding materials, with a hip, composition roof. The full front porch has a hip roof. The building also has paired windows in dormer, and square posts and matchstick balustrade.

79. 3418-20 Baltimore

Building Date: 1921; *Stories:* 3; *Plan:* Rectangular; *Style:* Walk Up; *Architect:* (Unknown); *Builder:* (Unknown); *Property Type:* Domestic, multiple dwelling; *Integrity:* Excellent

Description: This three-story building has a stone foundation, and uses brick cladding materials, with a flat composition roof. There is no front porch. The building also has tripartite windows; brick and stone trim; side lights; and balustrade above door hood.

80. 3419 Baltimore

Building Date: 1902; *Stories:* 2 1/2; *Plan:* Square; *Style:* Kansas City Shirtwaist; *Architect:* (Unknown); *Builder:* (Unknown); *Property Type:* Domestic, single dwelling; *Integrity:* Good

Description: This 2 1/2-story building has a stone foundation, a wood frame, and uses asbestos shingles and stone cladding materials, with a hip, composition roof. The full front porch has a hip roof. The building also has bellcast eaves and an asymmetrical pedimented porch.

81. 3422 Baltimore

Building Date: 1899; *Stories:* 2 1/2; *Plan:* Square; *Style:* Kansas City Shirtwaist; *Architect:* (Unknown); *Builder:* (Unknown); *Property Type:* Domestic, single dwelling; *Integrity:* Fair

Description: This 2 1/2-story building has a stone foundation, a wood frame, and uses lap siding and brick cladding materials, with a hip, composition roof. The full front porch has a hip roof. The building also has battered stone piers; ornamental plaque; and a decorative upper sash in paired dormer windows. **Garage: 1-story garage with wood shingles, gabled roof and modern doors. (noncontributing).**

United States Department of the Interior
National Park ServiceNational Register of Historic Places
Continuation SheetSection
number 7 Page 24Old Hyde Park West Historic District
Jackson County, Missouri**82. 3423 Baltimore** *Historic Name:* Isaac Moog Residence*Building Date:* 1908; *Stories:* 2 1/2; *Plan:* Rectangular; *Style:* Colonial Revival; *Architect:* (Unknown);
Builder: Thomas Combs; *Property Type:* Domestic, single dwelling; *Integrity:* Good

Description: This 2 1/2-story building has a stone foundation, and uses brick cladding materials, with a side gabled, composition roof. The full, two-story front porch has a flat roof; the rear porch is enclosed. The building also has triple pedimented dormers with deep molded eaves; brick quoining; stone lintels and sills; two-story porch swag; dentiled eaves; and transom and side lights.

83. 3424 Baltimore*Building Date:* 1902; *Stories:* 2 1/2; *Plan:* Square; *Style:* Kansas City Shirtwaist; *Architect:* (Unknown);
Builder: (Unknown); *Property Type:* Domestic, multiple dwelling; *Integrity:* Fair

Description: This 2 1/2-story building has a stone foundation, a wood frame, and uses asbestos shingles and stone cladding materials, with a hip, composition roof. The full front porch has a hip roof. The building also has pedimented front and gable dormer with cornice returns.

3508 Baltimore - Vacant Lot**84. 3516 Baltimore***Building Date:* 1900; *Stories:* 2 1/2; *Plan:* Square; *Style:* Kansas City Shirtwaist; *Architect:* (Unknown);
Builder: (Unknown); *Property Type:* Domestic, single dwelling; *Integrity:* Good

Description: This 2 1/2-story building has a stone foundation, a wood frame, and uses lap siding and brick cladding materials, with a front gabled, composition roof. The full front porch has a hip roof. The building also has second story bay with decorative sash; stone posts and battered porch pier; triple drains in porch wall; and decorative tripartite windows with heavy stone sills. **Garage: 1-story clapboard garage with flat composition roof and modern doors. (noncontributing).**

85. 3520 Baltimore*Building Date:* 1901; *Stories:* 2 1/2; *Plan:* Square; *Style:* Kansas City Shirtwaist; *Architect:* (Unknown);
Builder: (Unknown); *Property Type:* Domestic, single dwelling; *Integrity:* Good

Description: This 2 1/2-story building has a stone foundation, a wood frame, and uses asbestos shingles and stone cladding materials, with a gabled, composition roof. The full front porch has a shed roof. The building also has stone balustrade; tripartite, Palladian-plan window in gable; and cornice returns.

United States Department of the Interior
National Park Service

National Register of Historic Places Continuation Sheet

Section
number 7 Page 25

Old Hyde Park West Historic District
Jackson County, Missouri

86. 3521-25 Baltimore

Historic Name: Baltimore Apartments

Building Date: 1925; *Stories:* 5; *Plan:* Rectangular; *Style:* High Rise Apartment; Spanish Colonial; *Architect:* (Unknown); *Builder:* Richard D. Shore; *Property Type:* Domestic, multiple dwelling; *Integrity:* Good

Description: This five-story building uses brick cladding materials, with a flat, composition roof. The front, three-story porch is enclosed with a balcony. The building also has parapets centered on eaves; wood shingled, modillioned pent overhangs; and tripartite arched openings on the porches.

87. 3524 Baltimore

Building Date: 1900; *Stories:* 2 1/2; *Plan:* Square; *Style:* Kansas City Shirtwaist; *Architect:* (Unknown); *Builder:* H.D. Train; *Property Type:* Domestic, single dwelling; *Integrity:* Fair

Description: This 2 1/2-story building has a stone foundation, a wood frame, and uses asbestos shingles and brick cladding materials, with a hip, composition roof. The full front porch has a shed roof; there is also a two-story porch on the side. The building also has oval window; tripartite dormer window with decorative upper sash; and hipped dormer with pedimented front.

89. 3528 Baltimore

Building Date: 1900; *Stories:* 2 1/2; *Plan:* Square; *Style:* Dutch Colonial; *Architect:* (Unknown); *Builder:* (Unknown); *Property Type:* Domestic, single dwelling; *Integrity:* Good

Description: This 2 1/2-story building has a stone foundation, a wood frame, and uses asbestos shingles and stone cladding materials, with a side gambrel, composition roof. The full front porch has a shed roof. The building also has cross gable with cornice returns.

89. 3532 Baltimore

Building Date: 1900; *Stories:* 2 1/2; *Plan:* Square; *Style:* Kansas City Shirtwaist; *Architect:* (Unknown); *Builder:* H.D. Train, realtor; *Property Type:* Domestic, single dwelling; *Integrity:* Good

Description: This 2 1/2-story building has a stone foundation, a wood frame, and uses asbestos shingles and stone cladding materials, with a hip, composition roof. The full front porch has a hip roof. The building also has ornamental plaster medallion; polygonal dormer; and matchstick balustrade.

United States Department of the Interior
National Park Service

National Register of Historic Places Continuation Sheet

Section
number 7 Page 26

Old Hyde Park West Historic District
Jackson County, Missouri

90. 3536-42 Baltimore

Building Date: 1909; *Stories:* 3; *Plan:* Rectangular; *Style:* Classical Revival; *Architect:* Unknown; *Builder:* R.J. Delano; *Property Type:* Domestic, Multiple Dwelling; *Integrity:* Good

Description: This is a three-story apartment building with a stone foundation.

91. 3604 Baltimore

Building Date: 1921; *Stories:* 2; *Plan:* Rectangular; *Style:* Vernacular; *Architect:* (Unknown); *Builder:* (Unknown); *Property Type:* Domestic, multiple dwelling; *Integrity:* Good

Description: This two-story, four-family flat was built in 1921 in a vernacular style that incorporates stucco, brick and wood shingle cladding. It features two-story posts with dentils between posts, wide fascia, stone sills and a water table. It has a colonnaded full porch.

92. 3606 Baltimore

Building Date: 1923; *Stories:* 3; *Plan:* Rectangular; *Style:* Renaissance Revival; *Architect:* (Unknown); *Builder:* (Unknown); *Property Type:* Domestic, multiple dwelling; *Integrity:* Excellent

Description: This three-story brick apartment building was constructed in 1923 in a Renaissance Revival style that incorporates a two-pillar portico, classical entry surrounds, tripartite windows, decorative polychrome terracotta panels, and wide eaves with modillions.

93. 3608-12 Baltimore (noncontributing)

Building Date: 1965; *Stories:* 2; *Plan:* Rectangular; *Style:* Modern; *Architect:* (Unknown); *Builder:* (Unknown); *Property Type:* Domestic, multiple dwelling; *Integrity:* Good

Description: This modern apartment building features a wood shingle roof, interior courtyard and wrought iron balconies.

94. 3609 Baltimore

Building Date: 1901; *Stories:* 2 ½; *Plan:* square; *Style:* American Foursquare; *Architect:* (Unknown); *Builder:* Samuel Harrelson; *Property Type:* Domestic, single dwelling; *Integrity:* Good

Description: This 2 1/2 story house was built in 1901 in the Kansas City Shirtwaist style. It incorporates limestone cladding on the ground floor and wood shingles on the second story. It features an asymmetrical porch, bellcast eaves, and is topped with a gable roof and dormer windows.

United States Department of the Interior
National Park Service

National Register of Historic Places Continuation Sheet

Section
number 7 Page 27

Old Hyde Park West Historic District
Jackson County, Missouri

95. 3611 Baltimore

Building Date: 1887; *Stories:* 2 1/2 *Plan:* square; *Style:* American Foursquare; *Kansas City Shirtwaist;*
Architect: (Unknown); *Builder:* Benjamin F. Tyler; *Property Type:* Domestic, single dwelling; *Integrity:* Fair

Description: This 2 1/2 story home was built in 1887 in a Kansas City Shirtwaist style. The first floor features stone cladding and terra cotta accents. The second story is clad with wood shingles. It has a gabled composition roof and features a pedimented dormer with Palladian windows and a two-story bay. **Garage: 1-story vinyl siding garage with hip roof and modern doors. (noncontributing).**

96. 3614-3618 Baltimore (noncontributing)

Building Date: 1965; *Stories:* 3; *Plan:* Rectangular; *Style:* Classical Revival; *Architect:* Unknown; *Builder:* unknown; *Property Type:* Domestic, Multiple Dwelling; *Integrity:* Good; *Description:* Noncontributing

97. 3620-22 Baltimore

Building Date: 1889; *Stories:* 2; *Plan:* Irregular; *Style:* Vernacular; *Architect:* (Unknown); *Builder:* (Unknown); *Property Type:* Domestic, single dwelling; *Integrity:* Fair

Description: This two-story woodframe structure was built in 1889 in a Vernacular style. It has been re clad in asbestos shingles. It features a composition gable roof and has a full front porch on the first floor and a half porch on the second story.

98. 3632 Baltimore (noncontributing)

Building Date: 1966; *Stories:* 3; *Plan:* Rectangular; *Style:* Modern; *Architect:* (Unknown); *Builder:* (Unknown); *Property Type:* Domestic, multiple dwelling; *Integrity:* Good

Description: This is a noncontributing structure

3635 Baltimore - Vacant Lot

99. 3636 Baltimore (noncontributing)

Building Date: 1966; *Stories:* 2; *Plan:* Rectangular; *Style:* Modern; *Architect:* (Unknown); *Builder:* (Unknown); *Property Type:* Domestic, multiple dwelling; *Integrity:* Good

Description: This is a noncontributing structure

United States Department of the Interior
National Park ServiceNational Register of Historic Places
Continuation SheetSection
number 7 Page 28Old Hyde Park West Historic District
Jackson County, Missouri**100. 3641 Baltimore**

Building Date: 1902; *Stories:* 2 ½; *Plan:* Square; *Style:* American Foursquare; *Kansas City Shirtwaist;*
Architect: (Unknown); *Builder:* (Unknown); *Property Type:* Domestic, single dwelling; *Integrity:* Fair

Description: This 2 1/2 story home was built in 1902 in the Kansas City Shirtwaist style, incorporating brick cladding on the ground floor and shingles on the second floor. It has a pedimented porch supported on decorative braces and square posts with recessed panels. **Garage: 1-story stucco garage with gabled roof and modern doors. (noncontributing).**

101. 3643 Baltimore

Building Date: circa. 1900; *Stories:* 2 ½; *Plan:* Square; *Style:* American Foursquare; *Kansas City Shirtwaist;*
Architect: (Unknown); *Builder:* (Unknown); *Property Type:* Domestic, single dwelling; *Integrity:* Fair

Description: This 2 1/2 story home was built around 1900 in the Kansas City Shirtwaist style, incorporating brick cladding on the ground floor and wood shingles on the second floor. It has a full-width front porch with a hipped roof and a hip composition roof with a bellcast dormer window and modillioned eaves.

102. 3644 Baltimore

Building Date: 1888; *Stories:* 2 ½; *Plan:* Irregular; *Style:* Queen Anne; *Architect:* (Unknown); *Builder:*
(Unknown); *Property Type:* Domestic, single dwelling; *Integrity:* Good

Description: This 2 1/2 story home was built in 1888 in the Queen Anne style. It sits on a limestone foundation and is clad in lap siding, brick and stucco. It features an asymmetrical plan with multiple gables, a semicircular stone porch with concrete piers, and Doric columns. It has 1/1 double hung windows and a gabled roof.

103. 3700 Baltimore

Building Date: 1899; *Stories:* 2 ½; *Plan:* Square; *Style:* Dutch Colonial Revival; *Architect:* (Unknown);
Builder: (Unknown); *Property Type:* Domestic, single dwelling; *Integrity:* Good

Description: Built in 1899, this Dutch Colonial Revival home sits on a stone foundation and combines wood shingles and brick cladding. It has paired gambrel dormers with decorative sash, a modillioned cornice, paired and tripled porch columns, a second story deck with matchstick balustrade, and a two-story, projecting bay.

104. 3701 Baltimore (noncontributing)

Building Date: 1968; *Stories:* 2; *Plan:* Rectangular; *Style:* Modern; *Architect:* (Unknown); *Builder:*
(Unknown); *Property Type:* Domestic, multiple dwelling; *Integrity:* Good

Description: This is a noncontributing structure.

United States Department of the Interior
National Park Service

National Register of Historic Places Continuation Sheet

Section
number 7 Page 29

Old Hyde Park West Historic District
Jackson County, Missouri

105. 3704 Baltimore

Building Date: 1898; *Stories:* 2 ½; *Plan:* Square; *Style:* American Foursquare; *Architect:* (Unknown); *Builder:* (Unknown); *Property Type:* Domestic, single dwelling; *Integrity:* Fair

Description: This 2 1/2 story home was built in 1898 in the American Foursquare style. It's clad in brick and asbestos shingles and features a full-width, enclosed porch, a hip roof and tripartite-style dormer windows with decorative sash.

106. 3706 Baltimore

Building Date: 1899; *Stories:* 2 ½; *Plan:* Square; *Style:* American Foursquare: Kansas City Shirtwaist; *Architect:* (Unknown); *Builder:* C.E. Finlay; *Property Type:* Domestic, single dwelling; *Integrity:* Fair

Description: Built in 1899 in the Kansas City Shirtwaist style, this 2 1/2 story home is clad in limestone on the ground floor and shingles on the second story. It has wide, modillioned eaves and features a full-length stone porch with limestone piers and a gabled roof with dormer windows.

107. 3710 Baltimore

Building Date: 1898; *Stories:* 2 ½; *Plan:* Square; *Style:* Vernacular; *Architect:* (Unknown); *Builder:* C.E. Finlay
Property Type: Domestic, single dwelling; *Integrity:* Fair

Description: This 2 1/2 story Vernacular home, built in 1899, encompasses several architectural styles, including Colonial and Georgian Revival. It sits on a stone foundation, is clad in brick on the ground floor and asbestos shingles on the second floor. There is a full-width stone porch with Tuscan columns and a matchstick balustrade. The second floor features a small cut-out Carpenter's Gothic window between two typical windows. The gabled roof features a Palladian window. **Garage: 2-story wood garage with gabled roof and modern doors. (noncontributing).**

108. 3711 Baltimore (noncontributing due to alterations)

Building Date: 1901; *Stories:* 2 ½; *Plan:* Rectangular; *Style:* Vernacular; *Architect:* (Unknown); *Builder:* W.H. Collins; *Property Type:* Domestic, single dwelling; *Integrity:* Poor

Description: This is a noncontributing structure due to changes in windows, siding, and roofline.

United States Department of the Interior
National Park Service

National Register of Historic Places Continuation Sheet

Section
number 7 Page 30

Old Hyde Park West Historic District
Jackson County, Missouri

109. 3715 Baltimore

Building Date: 1901; *Stories:* 2 ½; *Plan:* Rectangular; *Style:* Shingle; *Architect:* (Unknown); *Builder:* W.H. Collins; *Property Type:* Domestic, single dwelling; *Integrity:* Excellent

Description: This 2 1/2 story home, built in 1901, is a Shingle-style design, featuring patterned wood shingles and stone cladding. It has paired second story oriel windows with modillions and brackets and a bi-gabled dormer. Its porch features Tuscan columns, tripled at the corners.

110. 3716 Baltimore

Building Date: 1900; *Stories:* 2 ½; *Plan:* Square; *Style:* American Foursquare: Kansas City Shirtwaist; *Architect:* (Unknown); *Builder:* C.E. Finlay; *Property Type:* Domestic, single dwelling; *Integrity:* Fair

Description: Built in 1900 in the American Foursquare: Kansas City Shirtwaist style, this house is clad in stone and lap siding. It features a pent roof overhang above the entrance, oriel windows, an open deck with stone balustrade, bellcast eaves, wide fascia, and tripartite windows in the gable roof.

111. 3717 Baltimore

Building Date: 1898; *Stories:* 2 ½; *Plan:* Square; *Style:* Vernacular; *Architect:* (Unknown); *Builder:* C.E. Finlay; *Property Type:* Domestic, single dwelling; *Integrity:* Fair

Description: This 2 1/2 story Vernacular house, built in 1898 features a tripartite window in the gable, projecting gable with a bay window, modillioned eaves and Tuscan columns.

112. 3718 Baltimore (noncontributing)

Building Date: 1962; *Stories:* 2 ½; *Plan:* Rectangular; *Style:* Modern; *Architect:* (Unknown); *Builder:* (Unknown); *Property Type:* Domestic, multiple dwelling; *Integrity:* Good

Description: This is a noncontributing structure.

113. 3724 Baltimore

Building Date: 1898; *Stories:* 2 ½; *Plan:* Square; *Style:* American Foursquare: Kansas City Shirtwaist; *Architect:* (Unknown); *Builder:* (Unknown); *Property Type:* Domestic, single dwelling; *Integrity:* Good

Description: Built in 1898, this American Foursquare: Kansas City Shirtwaist-style home is clad in stone and patterned shingles. It features tripartite windows in the dormer and bellcast eaves. It has a full-width stone porch with rusticated piers.

United States Department of the Interior
National Park Service

National Register of Historic Places Continuation Sheet

Section
number 7 Page 31

Old Hyde Park West Historic District
Jackson County, Missouri

114. 3725 Baltimore

Building Date: 1899; *Stories:* 2 ½; *Plan:* Square; *Style:* American Foursquare; *Kansas City Shirtwaist;*
Architect: (Unknown); *Builder:* (Unknown); *Property Type:* Domestic, single dwelling; *Integrity:* Good

Description: Built in 1899 in the American Foursquare: Kansas City Shirtwaist style, this 2 1/2 story home is clad in brick and vinyl siding. It features a projecting central porch section with Tuscan columns, and modillioned dormer eaves.

115. 3728 Baltimore

Building Date: 1906; *Stories:* 2 ½; *Plan:* Rectangular; *Style:* Vernacular; *Architect:* (Unknown); *Builder:*
(Unknown); *Property Type:* Domestic, single dwelling; *Integrity:* Good

Description: Built in 1906, this 2 1/2 story Vernacular home is clad in brick. It features bellcast eaves, a tripartite window in the gable and brick quoins.

116. 3729 Baltimore

Building Date: 1900; *Stories:* 2 ½; *Plan:* Irregular; *Style:* Queen Anne; *Architect:* (Unknown); *Builder:* C.E.
Finlay; *Property Type:* Domestic, single dwelling; *Integrity:* Good

Description: Built in 1900, this 2 1/2 story Queen Anne style home is clad in stone and asbestos shingles. It features paired, fluted porch posts, a gabled entrance, offset projecting gable, tripartite upper gable window in a curved surround, and a two-story bay.

117. 3730 Baltimore

Building Date: 1899; *Stories:* 2 ½; *Plan:* Square; *Style:* Vernacular; *Architect:* (Unknown); *Builder:*
(Unknown); *Property Type:* Domestic, single dwelling; *Integrity:* Good

Description: Built in 1899, this 2 1/2 story home is designed in a Vernacular style that combines a star-patterned upper sash in the dormer, wide bellcast modillioned eaves, a small oval window in the second story, a stained glass transom, and a two-story bay. **Garage: 1-story cinder block garage with hip roof and modern doors. (noncontributing).**

118. 3733 Baltimore

Building Date: 1901; *Stories:* 2 ½; *Plan:* Square; *Style:* Bungalow; *Architect:* (Unknown); *Builder:* (Unknown);
Property Type: Domestic, single dwelling; *Integrity:* Good

Description: Built in 1901 in the Bungalow style, this 2 1/2 story home is clad in lap siding and stone. It features a full-width porch with stone piers and matchstick balustrade, and a cross-gabled roof with tripartite windows.

United States Department of the Interior
National Park Service

National Register of Historic Places Continuation Sheet

Section
number 7 Page 32

Old Hyde Park West Historic District
Jackson County, Missouri

119. 3737 Baltimore

Building Date: 1899; *Stories:* 2 ½; *Plan:* Square; *Style:* American Foursquare; *Kansas City Shirtwaist;*
Architect: (Unknown); *Builder:* (Unknown); *Property Type:* Domestic, single dwelling; *Integrity:* Good

Description: Built in 1899 in the American Foursquare: Kansas City Shirtwaist style, this 2 1/2 story home is clad in lap siding and stone. It features wide, bellcast eaves and a pedimented dormer with tripartite window.
Garage: 1-story stone garage with parapet roof and wood doors. (contributing).

120. 3800-02 Baltimore

Building Date: 1910; *Stories:* 4; *Plan:* Square; *Style:* Classical Revival; *Architect:* (Unknown); *Builder:*
(Unknown); *Property Type:* Domestic, multiple dwelling; *Integrity:* Good

Description: Built in 1910, this four-story walkup apartment building is an example of the Classical Revival style. Clad in brick, it features a stone portico entryway topped with a Palladian window and a modillioned cornice.

121. 3807 Baltimore

Building Date: 1908; *Stories:* 2 ½; *Plan:* Square; *Style:* Kansas City Shirtwaist; *Architect:* (Unknown);
Builder: (Unknown); *Property Type:* Domestic, single dwelling; *Integrity:* Good

Description: Built in 1908, this 2 1/2 story home is an example of the Kansas City Shirtwaist architectural style. The ground floor is clad in stone and the second floor is composed of lap siding. It has a full, hip roof with dormer windows.

122. 3809 Baltimore

Building Date: 1908; *Stories:* 2 ½; *Plan:* Square; *Style:* Kansas City Shirtwaist; *Architect:* (Unknown); *Builder:*
(Unknown); *Property Type:* Domestic, single dwelling; *Integrity:* Good

Description: Built in 1908, this 2 1/2 story home is an example of the Kansas City Shirtwaist architectural style. The ground floor is clad in brick and the second floor is composed of lap siding. It has a full-width front porch and a gable roof.

123. 3811 Baltimore

Building Date: 1908; *Stories:* 2 ½; *Plan:* Square; *Style:* Kansas City Shirtwaist; *Architect:* (Unknown);
Builder: (Unknown); *Property Type:* Domestic, single dwelling; *Integrity:* Good

United States Department of the Interior
National Park ServiceNational Register of Historic Places
Continuation SheetSection
number 7 Page 33Old Hyde Park West Historic District
Jackson County, Missouri

Description: Built in 1908, this 2 1/2 story home is an example of the Kansas City Shirtwaist architectural style. The ground floor is clad in stone and the second floor is composed of asbestos shingle siding. It has a full-width, enclosed front porch and a hip roof.

124. 3815 Baltimore

Building Date: 1908; *Stories:* 2 1/2; *Plan:* Square; *Style:* Kansas City Shirtwaist; *Architect:* (Unknown); *Builder:* (Unknown); *Property Type:* Domestic, single dwelling; *Integrity:* Fair

Description: Built in 1908, this 2 1/2 story home is an example of the Kansas City Shirtwaist architectural style. The ground floor is clad in brick and the second floor is composed of lap siding. It has a full-width front porch and a gable roof.

125. 3817-19 Baltimore

Building Date: 1909; *Stories:* 2; *Plan:* Rectangular; *Style:* Colonnaded four-family flat; *Architect:* (Unknown); *Builder:* (Unknown); *Property Type:* Domestic, multiple dwelling; *Integrity:* Excellent

Description: Built in 1909, this 2-story building was constructed as a four-family flat. It's clad in brick and features square columns, two porches topped by balconies, a bracketed cornice and a hip roof.

126. 3820 Baltimore *Historic Name:* Charles E. Perkins Residence

Building Date: 1898; *Stories:* 2 1/2; *Plan:* Square; *Style:* Kansas City Shirtwaist; *Architect:* (Unknown); *Builder:* Charles E. Perkins; *Property Type:* Domestic, single dwelling; *Integrity:* Good

Description: Built in 1898, this 2 1/2 story home is an example of the Kansas City Shirtwaist architectural style. The ground floor is clad in brick and the second floor is composed of asbestos shingle siding. It has a full-width front porch and a hip roof.

127. 3825-27 Baltimore

Building Date: 1910; *Stories:* 2; *Plan:* Rectangular; *Style:* Colonnaded four-family flat; *Architect:* (Unknown); *Builder:* (Unknown); *Property Type:* Domestic, multiple dwelling; *Integrity:* Excellent

Description: Built in 1910 in the colonnaded style, this four-family brick flat has neoclassic features, including ionic columns, a lattice-work balustrade on the front porch and balcony, a modillioned cornice.

128. 3828 Baltimore *Historic Name:* James W. Martin Residence

Building Date: 1901; *Stories:* 2 1/2; *Plan:* Square; *Style:* Four square/Colonial Revival; *Architect:* (Unknown); *Builder:* James W. Martin; *Property Type:* Domestic, single dwelling; *Integrity:* Excellent

United States Department of the Interior
National Park Service

National Register of Historic Places Continuation Sheet

Section
number 7 Page 34

Old Hyde Park West Historic District
Jackson County, Missouri

Description: Built in 1901, this 2 1/2 story brick home combines elements of the Four square and Colonial Revival styles. There is a portico supported by ionic columns and topped with a hip roof. The windows feature transom lights. There is a bay window on the second floor, directly above the portico. The brickwork features quieted corners. **Garage: 1-story stucco garage with gabled roof and modern doors. (noncontributing).**

129. 3829-31 Baltimore

Building Date: 1911; *Stories:* 2 1/2; *Plan:* Square; *Style:* Neoclassical, colonnaded four-family flat; *Architect:* (Unknown); *Builder:* (Unknown); *Property Type:* Domestic, multiple dwelling; *Integrity:* Good

Description: Built in 1911, this colonnaded, four-family flat is composed of stucco and stone. It features neoclassical elements, banded Corinthian columns, ornately milled balustrade, and a gabled roof with a dormer.

130. 3833-35 Baltimore

Building Date: 1912; *Stories:* 2; *Plan:* Square; *Style:* Neoclassical, colonnaded four-family flat; *Architect:* (Unknown); *Builder:* (Unknown); *Property Type:* Domestic, multiple dwelling; *Integrity:* Good

Description: Built in 1912, this colonnaded, four-family flat is composed of stone and lap siding. It features neoclassical elements, such as banded Corinthian columns, a matchstick balustrade, and a hip roof.

131. 3837-39 Baltimore

Building Date: 1911; *Stories:* 2; *Plan:* Rectangular; *Style:* Neoclassical, colonnaded four-family flat; *Architect:* (Unknown); *Builder:* (Unknown); *Property Type:* Domestic, multiple dwelling; *Integrity:* Good

Description: Built in 1911, this colonnaded, four-family flat is composed of brick. It features neoclassical elements, such as banded Corinthian columns, a wrought-iron balustrade, and a modillioned cornice.

3838 Baltimore – Parking Lot

132. 3401-03 Central

Building Date: 1922; *Stories:* 3; *Plan:* Rectangular; *Style:* Double loaded corridor: Mission Revival; *Architect:* (Unknown); *Builder:* (Unknown); *Property Type:* Domestic, multiple dwelling; *Integrity:* Fair

Description: This three-story building has a brick foundation, and uses brick cladding materials, with a flat, composition roof. The building also has barrel tiled, bracketed pent eaves and door hood; central parapet; and stone and brick trim.

United States Department of the Interior
National Park Service

National Register of Historic Places Continuation Sheet

Section
number 7 Page 35

Old Hyde Park West Historic District
Jackson County, Missouri

133. 3409 Central

Building Date: 1910; *Stories:* 2 1/2; *Plan:* Square; *Style:* Kansas City Shirtwaist; *Architect:* (Unknown);
Builder: Jas. A. Casey; *Property Type:* Domestic, single dwelling; *Integrity:* Good

Description: This 2 1/2-story building has a stone foundation, a wood frame, and uses asbestos shingles and brick cladding materials, with a front gabled, composition roof. The full front porch has a hip roof.. The building also has paired casement windows in gable; bellcast gable end with cornice returns; and sawtooth stone porch wall.

134. 3411 Central

Building Date: 1910; *Stories:* 2 1/2; *Plan:* Square; *Style:* Kansas City Shirtwaist; *Architect:* (Unknown);
Builder: Jas. A. Casey; *Property Type:* Domestic, single dwelling; *Integrity:* Excellent

Description: This 2 1/2-story building has a stone foundation, a wood frame, and uses lap siding and brick cladding materials, with a front gabled, composition roof. The full front porch has a gabled roof. The building also has paired windows in gable; bellcast eaves; cornice returns in gable and porch; sawtooth stone porch wall; sliding wood garage doors below porch.

135. 3415 Central

Building Date: 1910; *Stories:* 1 1/2; *Plan:* Square; *Style:* Gable Square; *Architect:* (Unknown); *Builder:* C.O. Jones; *Property Type:* Domestic, single dwelling; *Integrity:* Fair

Description: This 1 1/2 story building has a stone foundation, a wood frame, and uses asbestos shingles cladding materials, with a front gabled, composition roof. There is a full front porch. The building also has grouped windows; and exposed rafter tails.

136. 3417 Central

Building Date: 1923; *Stories:* 1 1/2; *Plan:* Square; *Style:* Pyramid Square; *Architect:* (Unknown); *Builder:* (Unknown); *Property Type:* Domestic, single dwelling; *Integrity:* Fair

Description: This 1 1/2 story building has a wood frame, and uses asbestos shingles and brick cladding materials, with a truncated hip, composition roof. The full front porch has a hip roof. The building also has Tuscan columns; gabled wall dormers; arched brick window openings; and cornice returns in dormer gable ends.

United States Department of the Interior
National Park ServiceNational Register of Historic Places
Continuation SheetSection
number 7 Page 36Old Hyde Park West Historic District
Jackson County, Missouri**137. 3419 Central**

Building Date: (Unknown), contributing garage -1930; *Stories:* 1 1/2; *Plan:* Square; *Style:* Pyramid Square; *Architect:* (Unknown); *Builder:* (Unknown); *Property Type:* Domestic, single dwelling; *Integrity:* Fair

Description: This 1 1/2 story building has a wood frame, and uses brick, stucco, and asbestos shingles cladding materials, with a truncated hip, composition roof. The full front porch has a hip roof. The building also has gabled wall dormers with cornice returns. **Garage: Frame garage constructed c. 1930. (contributing)**

3423 Central- Parking Lot for 300 W. Armour**138. 3433-35 Central** *Historic Name:* Fletcher Apartments

Building Date: 1911; *Stories:* 3; *Plan:* Rectangular; *Style:* Colonnaded double-loaded corridor, neoclassical; *Architect:* Otis Goddard; *Builder:* (Unknown); *Property Type:* Domestic, multiple dwelling; *Integrity:* Good

Description: This three-story building has a stone foundation, and uses brick cladding materials, with a flat, composition roof. The full three-story front porch is colonnaded with a flat roof. The building also has fluted Ionic columns; porches bow out slightly; flat roof with wide eaves; modillions and dentils; three story projecting bays; arched window openings; porch doors flanked by double-hung windows.

139. 3516-18 Central

Building Date: 1911; *Stories:* 3; *Plan:* Square; *Style:* Colonnaded walk-up; *Architect:* (Unknown); *Builder:* T.C. Mitchell; *Property Type:* Domestic, multiple dwelling; *Integrity:* Excellent

Description: This three-story building has a stone foundation, and uses brick cladding materials, with a flat, composition roof. The full front porch is colonnaded with a gabled roof. The building also has full-height Ionic columns; temple front with wide entablature; and stone quoining and trim.

140. 3520-22 Central

Building Date: 1911; *Stories:* 3; *Plan:* Square; *Style:* Colonnaded walk-up; *Architect:* (Unknown); *Builder:* T.C. Mitchell; *Property Type:* Domestic, multiple dwelling; *Integrity:* Excellent

Description: This three-story building has a stone foundation, and uses brick cladding materials, with a flat, composition roof. The full front porch is colonnaded with a gabled roof. The building also has full-height Ionic columns; temple front with wide entablature; and stone quoining and trim.

United States Department of the Interior
National Park ServiceNational Register of Historic Places
Continuation SheetSection
number7Page 37Old Hyde Park West Historic District
Jackson County, Missouri**141. 3525 Central**

Building Date: 1912; *Stories:* 3 ½; *Plan:* Rectangular; *Style:* Walk-up; *Architect:* (Unknown); *Builder:* (Unknown); *Property Type:* Domestic, multiple dwelling; *Integrity:* Excellent

Description: This three+-story building has a stone foundation, and uses brick cladding materials, with a flat, composition roof. The full three-story front porch has a flat roof. The building also has front parapet with stone coping; wide eaves with modillions over porch; and stone trim lintels and sills. **Garage: 1-story woodframe modern garage with gabled roof. (noncontributing).**

142. 3527-29 Central*Historic Name:* Tishue Apartments

Building Date: 1915; *Stories:* 3; *Plan:* Rectangular; *Style:* Walk-up, Craftsman; *Architect:* (Unknown); *Builder:* (Unknown); *Property Type:* Domestic, multiple dwelling; *Integrity:* Excellent

Description: This three-story building has a stone foundation, and uses brick and asbestos shingles cladding materials, with a flat, composition roof. The full front porch is colonnaded and enclosed and has a gabled roof. The building also has secondary gables over each side pavilion; patterned brick and stone trim; wide bracketed eaves; three-story bay; and a patterned upper sash.

143. 3533-35 Central

Building Date: 1915; *Stories:* 3; *Plan:* Rectangular; *Style:* Walk-up, Craftsman; *Architect:* (Unknown); *Builder:* (Unknown); *Property Type:* Domestic, multiple dwelling; *Integrity:* Excellent

Description: This three-story building has a stone foundation, and uses brick and asbestos shingles cladding materials, with a flat, composition roof. The full front porch is colonnaded and enclosed and has a gabled roof. The building also has secondary gables over each side pavilion; and brick patterning and stone trim.

144. 3537-43 Central

Building Date: 1916; *Stories:* 4; *Plan:* Rectangular; *Style:* Double walk-up, Craftsman; *Architect:* (Unknown); *Builder:* (Unknown); *Property Type:* Domestic, multiple dwelling; *Integrity:* Good

Description: This four-story building has a brick foundation, and uses brick and asbestos shingles cladding materials, with a mansard, composition roof. There are three-story front balconies. The building also has stone trim; wide bracketed eaves; contrasting dark brick foundation and stone beltcourses; and projecting pavilions flanking entrance.

United States Department of the Interior
National Park Service

National Register of Historic Places Continuation Sheet

Section
number 7 Page 38

Old Hyde Park West Historic District
Jackson County, Missouri

145. 3601 Central

Building Date: 1900; *Stories:* 1 1/2; *Plan:* Square; *Style:* Bungalow; *Architect:* (Unknown); *Builder:* (Unknown); *Property Type:* Domestic, single dwelling; *Integrity:* Good

Description: This 1 1/2 story building has a stone foundation, a wood frame, and uses lap siding and brick cladding materials, with a side gabled, composition roof. There is a full front porch. The building also has double-gabled dormer with diamond-pane sash; sidelights; and cornice returns in gable ends.

146. 3603-05 Central

Historic Name: Hanover Apartments

Building Date: 1912; *Stories:* 3; *Plan:* Square; *Style:* Colonnaded Apartment; *Architect:* Nelle E. Peters; *Builder:* W.G. Wren; *Property Type:* Domestic, multiple dwelling; *Integrity:* Excellent

Description: This three-story building has a stone foundation, and uses brick cladding materials, with a flat, composition roof. The full three-story front porch is colonnaded with a flat roof. The building also has three-story column-over-pier design; fluted Ionic columns; flat porch roof with wide bracketed eaves and dentils; stone trim and patterned balustrade.

147. 3609-11 Central (noncontributing, outside period of significance)

Building Date: 1953; *Stories:* 2; *Plan:* Square; *Style:* Colonial Revival; *Architect:* (Unknown); *Builder:* (Unknown); *Property Type:* Domestic, single dwelling; *Integrity:* Good

Description: This two-story building has a poured concrete foundation, a wood frame, and uses asbestos shingles and stucco cladding materials, with a side gabled, composition roof. The building also has pent overhang with small brackets; and shutters.

148. 3613 Central

Building Date: 1901; *Stories:* 2 1/2; *Plan:* Rectangular; *Style:* Stick Style; *Architect:* (Unknown); *Builder:* (Unknown); *Property Type:* Domestic, single dwelling; *Integrity:* Excellent

Description: This 2 1/2-story building has a stone foundation, a wood frame, and uses lap siding and brick cladding materials, with a gabled, composition roof. There is an ell-shaped porch that is arcaded with a gabled roof. The building also has Stick-style trim; projecting front gabled porch with knee braces; bay windows; and knee-braced eaves.

United States Department of the Interior
National Park Service

National Register of Historic Places Continuation Sheet

Section
number 7 Page 39

Old Hyde Park West Historic District
Jackson County, Missouri

149. 3615-17 Central

Building Date: 1915; *Stories:* 2 1/2; *Plan:* Irregular; *Style:* Craftsman; *Architect:* (Unknown); *Builder:* (Unknown); *Property Type:* Domestic, single dwelling; *Integrity:* Good

Description: This 2 1/2-story building has a stone foundation, a wood frame, and uses lap stucco and stone cladding materials, with a gabled, composition roof. There is a full enclosed porch with a balcony on the side. The building also has false half-timbering; and a third story deck hood supported on exaggerated braces.

150. 3621-23 Central

Building Date: 1899; *Stories:* 2 1/2; *Plan:* Rectangular; *Style:* Colonnaded Apartment: Two-family flat; *Architect:* (Unknown); *Builder:* (Unknown); *Property Type:* Domestic, multiple dwelling; *Integrity:* Good

Description: This 2 1/2-story building has a stone foundation, a wood frame, and uses stucco cladding materials, with a hip, composition roof. There is a full two-story front porch. The building also has two-story Tuscan columns-over-piers; lipped window and door surrounds; and matchstick balustrade.

150. 3625 Central

Building Date: 1903; *Stories:* 2 1/2; *Plan:* Square; *Style:* Kansas City Shirtwaist; *Architect:* (Unknown); *Builder:* (Unknown); *Property Type:* Domestic, single dwelling; *Integrity:* Good

Description: This 2 1/2-story building has a stone foundation, a wood frame, and uses asbestos shingles and brick cladding materials, with a gabled, composition roof. The full front porch has a hip roof. The building also has wide, bellcast eaves with modillions; paired modillions under porch eaves; paired windows in gable, recessed from main wall; and decorative medallion in second story. **Garage: 1-story wood shingle garage with gabled roof and wood doors. (contributing).**

151. 3629 Central

Building Date: 1903; *Stories:* 2 1/2; *Plan:* Square; *Style:* Kansas City Shirtwaist; *Architect:* (Unknown); *Builder:* (Unknown); *Property Type:* Domestic, single dwelling; *Integrity:* Good

Description: This 2 1/2-story building has a stone foundation, a wood frame, and uses asbestos shingles and stone cladding materials, with a hip, composition roof. The full front porch has a gabled roof. The building also has paired modillions under porch eaves; pedimented porch; bellcast eaves; and hip dormer with flared walls. **Garage: 1-story wood shingle garage with gabled roof and wood doors. (contributing).**

United States Department of the Interior
National Park Service

National Register of Historic Places Continuation Sheet

Section
number 7 Page 40

Old Hyde Park West Historic District
Jackson County, Missouri

152. 3633 Central

Building Date: 1903; *Stories:* 2 1/2; *Plan:* Square; *Style:* Kansas City Shirtwaist; *Architect:* (Unknown); *Builder:* (Unknown); *Property Type:* Domestic, single dwelling; *Integrity:* Good

Description: This 2 1/2-story building has a stone foundation, a wood frame, and uses lap siding and stone cladding materials, with a hip, composition roof. The full front porch has a hip roof. The building also has paired modillions under porch eaves; and a bellcast roof. James F. Goodman, vice-president of Dickanson-Goodman Lumber Co. was the resident in 1915.

153. 3637 Central

Building Date: 1903; *Stories:* 2 1/2; *Plan:* Square; *Style:* Kansas City Shirtwaist/Craftsman; *Architect:* (Unknown); *Builder:* (Unknown); *Property Type:* Domestic, single dwelling; *Integrity:* Good

Description: This 2 1/2-story building has a stone foundation, a wood frame, and uses asbestos shingles and stone cladding materials, with a gabled, composition roof. The full front porch has a hip roof. The building also has paired windows; and brackets. Henry A. Thomas, real estate, was the resident in 1915.

154. 3641 Central

Building Date: 1903; *Stories:* 2 1/2; *Plan:* Square; *Style:* Kansas City Shirtwaist; *Architect:* (Unknown); *Builder:* (Unknown); *Property Type:* Domestic, single dwelling; *Integrity:* Fair

Description: This 2 1/2-story building has a stone foundation, a wood frame, and uses asbestos shingles and brick cladding materials, with a hip, composition roof. The full front porch has a hip roof. The building also has a bellcast roof; wide eaves with paired modillions and dentils; paired windows; pedimented dormer with Corinthian pilasters.

155. 3645 Central

Building Date: 1903; *Stories:* 2 1/2; *Plan:* Square; *Style:* Kansas City Shirtwaist; *Architect:* (Unknown); *Builder:* (Unknown); *Property Type:* Domestic, single dwelling; *Integrity:* Good

Description: This 2 1/2-story building has a stone foundation, a wood frame, and uses lap siding and brick cladding materials, with a gabled, composition roof. The full front porch has a hip roof. The building also has a bellcast roof; paired windows in gable; wide eaves; and pedimented side dormers. Robert E. Booth, vice-president of City Center Bank, was the resident in 1915. **Garage: 1-story wood shingle garage with hip roof and wood doors. (contributing).**

United States Department of the Interior
National Park ServiceNational Register of Historic Places
Continuation SheetSection
number 7 Page 41Old Hyde Park West Historic District
Jackson County, Missouri**156. 3649 Central**

Building Date: 1903; *Stories:* 2 1/2; *Plan:* Square; *Style:* Kansas City Shirtwaist; *Craftsman;* *Architect:* (Unknown); *Builder:* (Unknown); *Property Type:* Domestic, single dwelling; *Integrity:* Fair

Description: This 2 1/2-story building has a stone foundation, a wood frame, and uses asbestos shingles and stone cladding materials, with a hip, composition roof. The full front porch has a hip roof. The building also has paired hip dormers with flared sides, starburst sash, and modillions; exterior stone chimney; and round, stone porch piers. C.W. Sheldon Carlton, vice-president of Kawmo Wholesale Grocer Co., was the resident in 1915.

Garage: 1-story clapboard garage with gabled roof and wood doors. (contributing).

157. 3703-05 Central (noncontributing due to age)

Building Date: 1987; *Stories:* 1; *Plan:* Rectangular; *Style:* Duplex, Ranch; *Architect:* (Unknown); *Builder:* (Unknown); *Property Type:* Domestic, multiple dwelling; *Integrity:* Poor

Description: This one-story building has a poured concrete foundation, a wood frame, and uses lap siding and brick cladding materials, with a gabled, composition roof. The building also has vertical board and batten siding.

158. 3704 Central

Building Date: 1889; *Stories:* 2 1/2; *Plan:* Square; *Style:* Kansas City Shirtwaist/Colonial Revival; *Architect:* (Unknown); *Builder:* (Unknown); *Property Type:* Domestic, single dwelling; *Integrity:* Good

Description: This 2 1/2-story building has a stone foundation, a wood frame, and uses asbestos shingles and stucco cladding materials, with a front gabled, composition roof. The 1/2 front porch has a flat roof. The building also has pedimented gable; wide eaves with modillions, classical entrance porch with paired Doric columns; sidelights and transom.

159. 3708 Central

Building Date: 1901; *Stories:* 2 1/2; *Plan:* Square; *Style:* Kansas City Shirtwaist; *Colonial Revival;* *Architect:* (Unknown); *Builder:* (Unknown); *Property Type:* Domestic, single dwelling; *Integrity:* Excellent

Description: This 2 1/2-story building has a stone foundation, a wood frame, and uses wood shingles and stone cladding materials, with a gabled, composition roof. The full front porch has a flat roof. The building also has Doric columns; bay windows; stone balustrade; and Palladian windows. Guy D. Adams, manager for Atlas Tire Co., was the resident in 1915. **Garage: one-story wood shingle and stucco garage with gabled roof and wooden doors. (contributing)**

United States Department of the Interior
National Park Service

National Register of Historic Places Continuation Sheet

Section
number 7 Page 42

Old Hyde Park West Historic District
Jackson County, Missouri

160. 3709 Central

Building Date: 1906; *Stories:* 2 1/2; *Plan:* Square; *Style:* Four Square; *Architect:* (Unknown); *Builder:* (Unknown); *Property Type:* Domestic, single dwelling; *Integrity:* Fair

Description: This 2 1/2-story building has a stone foundation, and uses brick cladding materials, with a hip, composition roof. The front porch has a flat roof. The building also has stone water table and beltcourse.

161. 3712 Central

Building Date: 1903; *Stories:* 2 1/2; *Plan:* Square; *Style:* Kansas City Shirtwaist; *Architect:* Sidney R. Frink; *Builder:* (Unknown); *Property Type:* Domestic, single dwelling; *Integrity:* Good

Description: This 2 1/2-story building has a stone foundation, a wood frame, and uses lap siding and stucco cladding materials, with a hip, composition roof. The full front porch has a hip roof. The building also has bellcast roof lines; hip dormer with diamond-pane upper sash; and bay window.

162. 3715 Central

Building Date: 1900; *Stories:* 2 1/2; *Plan:* Square; *Style:* Kansas City Shirtwaist; *Architect:* Craftsman; *Builder:* (Unknown); *Property Type:* Domestic, single dwelling; *Integrity:* Poor

Description: This 2 1/2-story building has a stone foundation, a wood frame, and uses asbestos shingles and brick cladding materials, with a hip, composition roof. The full front porch has a hip roof. The building also has hip dormer with paired "bay" windows with diamond-pane sash; and star-patterned sash.

163. 3716 Central

Building Date: 1900; *Stories:* 2 1/2; *Plan:* Square; *Style:* Kansas City Shirtwaist; *Architect:* Charles A. Smith; *Builder:* M.E. Tomlinson; *Property Type:* Domestic, single dwelling; *Integrity:* Fair

Description: This 2 1/2-story building has a stone foundation, a wood frame, and uses asbestos shingles and stone cladding materials, with a hip, composition roof. The full front porch has a hip roof. The building also has battered stone piers; projecting central bay; and two-story oriel.

164. 3721 Central

Building Date: 1909; *Stories:* 2 1/2; *Plan:* Square; *Style:* Kansas City Shirtwaist/Spanish Colonial Revival; *Architect:* (Unknown); *Builder:* (Unknown); *Property Type:* Domestic, single dwelling; *Integrity:* Good

Description: This 2 1/2-story building has a stone foundation, a wood frame, and uses stucco and stone cladding materials, with a hip, composition roof. The full two-story porch is arcaded. The building also has bellcast roof with wide eaves; arcaded second story porch; and stone balustrade.

United States Department of the Interior
National Park Service

National Register of Historic Places Continuation Sheet

Section
number 7 Page 43

Old Hyde Park West Historic District
Jackson County, Missouri

165. 3723 Central

Building Date: 1908; *Stories:* 1 1/2; *Plan:* Square; *Style:* Pyramid Square; *Architect:* (Unknown); *Builder:* S.E. Johnson; *Property Type:* Domestic, single dwelling; *Integrity:* Good

Description: This 1 1/2 story building has a stone foundation, and uses brick cladding materials, with a hip, composition roof. The full front porch is recessed. The building also has tripartite windows in pedimented dormers; and stone balustrade.

166. 3724 Central

Building Date: 1899; *Stories:* 2 1/2; *Plan:* Square; *Style:* American Foursquare; *Architect:* (Unknown); *Builder:* (Unknown); *Property Type:* Domestic, single dwelling; *Integrity:* Fair

Description: This 2 1/2-story building has a stone foundation, a wood frame, and uses asbestos shingles and brick cladding materials, with a hip, composition roof. The full front porch has a hip roof. The building also has sloped-wall dormer with paired diamond-pane windows; and Tuscan columns. S.C.A. Rubey, state manager for Modern Woodmen of America, was the resident in 1915.

3725 Central – Vacant Lot

167. 3733 Central

Building Date: 1899; *Stories:* 2 1/2; *Plan:* Square; *Style:* Kansas City Shirtwaist; *Architect:* (Unknown); *Builder:* (Unknown); *Property Type:* Domestic, single dwelling; *Integrity:* Fair

Description: This 2 1/2-story building has a stone foundation, a wood frame, and uses asbestos shingles and brick cladding materials, with a hip, composition roof. The full front porch has a hip roof. The building also has paired casement windows in dormers; ornamental plaque in second story; two arch oriel; and ornamental upper sash.

168. 3735 Central

Building Date: 1899; *Stories:* 2 1/2; *Plan:* Square; *Style:* Kansas City Shirtwaist; *Architect:* (Unknown); *Builder:* (Unknown); *Property Type:* Domestic, single dwelling; *Integrity:* Good

Description: This 2 1/2-story building has a stone foundation, a wood frame, and uses asbestos shingles and brick cladding materials, with a hip, composition roof. The full front porch has a hip roof. The building also has diamond-pane upper sash; ornamental plaque in second story; hip dormers with flared walls and paired sash.

United States Department of the Interior
National Park ServiceNational Register of Historic Places
Continuation SheetSection
number 7 Page 44Old Hyde Park West Historic District
Jackson County, Missouri**169. 3737 Central**

Building Date: 1899; *Stories:* 2 1/2; *Plan:* Square; *Style:* American Foursquare; *Kansas City Shirtwaist;* *Architect:* (Unknown); *Builder:* (Unknown); *Property Type:* Domestic, single dwelling; *Integrity:* Good

Description: This 2 1/2-story building has a stone foundation, a wood frame, and uses asbestos shingles and brick cladding materials, with a hip, composition roof. The full two-story porch has a shed roof. The building also has sloped-wall dormers with paired sash. William R. Rowe, assistant industrial commissioner for Board of Trade, was the resident in 1915.

170. 3741 Central

Building Date: 1899; *Stories:* 2 1/2; *Plan:* Square; *Style:* Kansas City Shirtwaist; *Craftsman;* *Architect:* (Unknown); *Builder:* (Unknown); *Property Type:* Domestic, single dwelling; *Integrity:* Good

Description: This 2 1/2-story building has a wood frame, and uses asbestos shingles and brick cladding materials, with a hip, composition roof. The full front porch has a hip roof. The building also has wide, sloped eaves with false "rafter tails"; Tuscan columns; ornamental plaque in second story; hip dormers and flared walls and paired sash.

171. 3745 Central

Building Date: 1904; *Stories:* 2 1/2; *Plan:* Square; *Style:* Kansas City Shirtwaist; *Architect:* (Unknown); *Builder:* (Unknown); *Property Type:* Domestic, single dwelling; *Integrity:* Fair

Description: This 2 1/2-story building has a stone foundation, a wood frame, and uses stone cladding materials, with a hip, composition roof. The full front porch has a hip roof. The building also has bellcast rooflines; wide eaves with modillions; and paired windows in dormers.

172. 3800 Central

Building Date: 1911; *Stories:* 3; *Plan:* Rectangular; *Style:* Colonnaded Walk-up; *Architect:* E.S. Farwell (NYC); *Builder:* (Unknown); *Property Type:* Domestic, multiple dwelling; *Integrity:* Good

Description: This three-story building has a stone foundation, and uses stucco cladding materials, with a flat, composition roof. The front porch is colonnaded with a gabled roof. The building also has three-story, projecting entrance pavilion with flanking porches; dentiled cornice; flat roof with pedimented pavilion; sidelights and 5-light arched transom.

United States Department of the Interior
National Park Service

National Register of Historic Places Continuation Sheet

Section
number 7 Page 45

Old Hyde Park West Historic District
Jackson County, Missouri

173. 3806 Central

Building Date: 1905; *Stories:* 2 1/2; *Plan:* Square; *Style:* American Foursquare; *Kansas City Shirtwaist;* *Architect:* (Unknown); *Builder:* (Unknown); *Property Type:* Domestic, single dwelling; *Integrity:* Good

Description: This 2 1/2-story building has a stone foundation, a wood frame, and uses asbestos shingles and brick cladding materials, with a front gabled, composition roof. The full front porch has a gabled roof. The building also has bellcast eaves; and a two-story oriel. Henry S. Siegrist, president of Siegrist Engraving Co., was the resident in 1915.

174. 3808 Central

Building Date: 1900; *Stories:* 2 1/2; *Plan:* Square; *Style:* Kansas City Shirtwaist; *Architect:* (Unknown); *Builder:* (Unknown); *Property Type:* Domestic, single dwelling; *Integrity:* Excellent

Description: This 2 1/2-story building has a stone foundation, a wood frame, and uses lap siding cladding materials, with a front gabled, composition roof. The full front porch has a hip roof. The building also has wide eaves with modillions; and square porch posts with recessed panels.

175. 3810-12 Central

Building Date: 1900; *Stories:* 2 1/2; *Plan:* Square; *Style:* Two-family flat, Craftsman; *Architect:* (Unknown); *Builder:* (Unknown); *Property Type:* Domestic, multiple dwelling; *Integrity:* Excellent

Description: This 2 1/2-story building has a stone foundation, a wood frame, and uses lap siding and brick cladding materials, with a hip, composition roof. The full two-story porch has a flat roof. The building also has arched openings on first story porch; diamond-pane windows in second story; and a second story open deck.

Garage: 1-story clapboard and cinderblock garage with Flemish roof and modern doors. (noncontributing).

176. 3813-15 Central

Historic Name: Leland Apartments

Building Date: 1903; *Stories:* 3; *Plan:* Rectangular; *Style:* Colonnaded walk-up, Neoclassical; *Architect:* Nelle E. Peters; *Builder:* W.G. Wrenn; *Property Type:* Domestic, multiple dwelling; *Integrity:* Excellent

Description: This three-story building has a stone foundation, and uses brick cladding materials, with a flat, composition roof. The full front porch is colonnaded with a flat roof. The building also has full-height column-over-pier fluted, Ionic columns; stone trim; wide eaves with modillions; and patterned balustrades.

United States Department of the Interior
National Park Service

National Register of Historic Places Continuation Sheet

Section number 7 Page 46

Old Hyde Park West Historic District
Jackson County, Missouri

177. 3814-16 Central

Building Date: 1921; *Stories:* 3; *Plan:* Square; *Style:* Walk-up; *Architect:* Neile E. Peters; *Builder:* Charles E. Phillips; *Property Type:* Domestic, multiple dwelling; *Integrity:* Good

Description: This three-story building has a brick foundation, and uses brick cladding materials, with a flat, composition roof. The building also has wide eaves; false timbering; wide eaves with cornice; stone trim; portico with Doric column; and paired windows.

178. 3817-19 Central

Historic Name: Arvada Apartments

Building Date: 1912; *Stories:* 3; *Plan:* Rectangular; *Style:* Colonnaded walk-up/Neoclassical; *Architect:* Nelle E. Peters; *Builder:* W.G. Wrenn; *Property Type:* Domestic, multiple dwelling; *Integrity:* Excellent

Description: This three-story building has a stone foundation, and uses brick cladding materials, with a flat, composition roof. The full front porch is colonnaded with a flat roof. The building also has full-height column-over-pier fluted, Ionic columns; wide eaves with modillions and dentils; stone trim; and patterned balustrade.

3820 Central - Vacant Lot

179. 3821-23 Central

Historic Name: Buford Apartments

Building Date: 1911-12; *Stories:* 3; *Plan:* Rectangular; *Style:* Colonnaded walk-up; Neoclassical/Craftsman; *Architect:* (Unknown); *Builder:* T.C. Mitchell; *Property Type:* Domestic, multiple dwelling; *Integrity:* Excellent

Description: This three-story building has a stone foundation, and uses brick cladding materials, with a flat, composition roof. The full three-story front porch is colonnaded with a flat roof. The building also has full-height Doric columns support flat roof with wide eaves; patterned balustrade; stone quoining, lintels and sills; and arched window openings in sidewalls.

180. 3825-27 Central

Historic Name: Alamo Apartments

Building Date: 1911; *Stories:* 3; *Plan:* Rectangular; *Style:* Colonnaded walk-up; Neoclassical/Craftsman; *Architect:* (Unknown); *Builder:* T.C. Mitchell; *Property Type:* Domestic, multiple dwelling; *Integrity:* Excellent

Description: This three-story building has a stone foundation, and uses brick cladding materials, with a flat, composition roof. The full front porch is colonnaded and pedimented. The building also has full-height Doric columns support oversized pediment and entablature; stylized balustrade; stone quoining, lintels, and sills; and arched openings in side walls.

United States Department of the Interior
National Park ServiceNational Register of Historic Places
Continuation SheetSection
number 7 Page 47Old Hyde Park West Historic District
Jackson County, Missouri**181. 3829-31 Central***Historic Name:* Waldorf Apartments*Building Date:* 1911; *Stories:* 3; *Plan:* Rectangular; *Style:* Colonnaded walk-up; Neoclassical; *Architect:* (Unknown); *Builder:* T.C. Mitchell; *Property Type:* Domestic, multiple dwelling; *Integrity:* Excellent

Description: This three-story building has a stone foundation, and uses brick cladding materials, with a flat, composition roof. The full front porch is colonnaded and pedimented. The building also has full-height Doric columns support oversized pediment and entablature; stylized balustrade; stone quoining, lintels, and sills; and arched openings in side walls.

182. 3833-35 Central*Historic Name:* Carpathia Apartments*Building Date:* 1912; *Stories:* 3; *Plan:* Rectangular; *Style:* Colonnaded walk-up/ Neoclassical; *Architect:* (Unknown); *Builder:* (Unknown); *Property Type:* Domestic, multiple dwelling; *Integrity:* Good

Description: This three-story building has a stone foundation, and uses brick cladding materials, with a flat, composition roof. The full front porch is colonnaded and pedimented. The building also has full-height Doric columns support oversized pediment and entablature; stone quoining, lintels, and sills; and arched openings in side walls; small pent roofs at the level of each porch.

183. 3321 Wyandotte*Building Date:* 1905; *Stories:* 2 1/2; *Plan:* Square; *Style:* Kansas City Shirtwaist; *Architect:* (Unknown); *Builder:* (Unknown); *Property Type:* Domestic, single dwelling; *Integrity:* Good

Description: This 2 1/2-story building has a stone foundation and uses brick and Asbestos shingles cladding materials with a hip, composition roof. The full front porch has a hip roof. The building also has paired dormer windows.

184. 3323 Wyandotte*Building Date:* 1905; *Stories:* 2 1/2; *Plan:* Square; *Style:* Kansas City Shirtwaist; *Architect:* (Unknown); *Builder:* (Unknown); *Property Type:* Domestic, single dwelling; *Integrity:* Good

Description: This 2 1/2-story building has a stone foundation and uses brick and wood shingles cladding materials with a hip, composition roof. The full front porch has a hip roof. The building also has paired dormer windows.

185. 3325 Wyandotte*Building Date:* 1905; *Stories:* 2 1/2; *Plan:* Square; *Style:* Kansas City Shirtwaist; *Architect:* (Unknown); *Builder:* (Unknown); *Property Type:* Domestic, single dwelling; *Integrity:* Fair

United States Department of the Interior
National Park Service

National Register of Historic Places Continuation Sheet

Section
number 7 Page 48

Old Hyde Park West Historic District
Jackson County, Missouri

Description: This 2 1/2-story building has a stone foundation and uses brick and asbestos shingles cladding materials with a gabled, composition roof. The full front porch has a hip roof. The building also has Tuscan columns on low piers with recessed panels, and bellcast eaves.

186. 3327 Wyandotte

Building Date: 1905; *Stories:* 2 1/2; *Plan:* Square *Style:* Kansas City Shirtwaist/Colonial Revival; *Architect:* (Unknown); *Builder:* (Unknown); *Property Type:* Domestic, single dwelling; *Integrity:* Good

Description: This 2 1/2-story building has a stone foundation and uses brick and wood shingles cladding materials with a gabled, composition roof. The full front porch has a hip roof. The building also has Tuscan columns, cornice returns, and pedimented dormers with cornerboards.

187. 3329 Wyandotte

Building Date: 1904; *Stories:* 1 1/2; *Plan:* Square; *Style:* Gabled Square; *Architect:* (Unknown); *Builder:* (Unknown); *Property Type:* Domestic, single dwelling; *Integrity:* Fair

Description: This 1 1/2 story building has a stone foundation and uses stone and asbestos shingles cladding materials with a gabled, composition roof. The full front porch has a hip roof. The building also has Tuscan columns, cornice returns, pedimented dormers, and a tripartite window.

188. 3331 Wyandotte

Building Date: 1904; *Stories:* 1 1/2; *Plan:* Square; *Style:* Gabled Square; *Architect:* (Unknown); *Builder:* (Unknown); *Property Type:* Domestic, single dwelling; *Integrity:* Good

Description: This 1 1/2 story building has a stone foundation and uses stone and asbestos shingles cladding materials with a gabled, composition roof. The full front porch has a hip roof. The building also has Tuscan columns, shed-roof dormer, cornice returns, and a tripartite window.

189. 3333 Wyandotte

Building Date: 1904; *stories:* 2 1/2; *Plan:* Square; *Style:* Open Gable; *Architect:* (Unknown); *Builder:* (Unknown); *Property Type:* Domestic, single dwelling; *Integrity:* Excellent

Description: This 2 1/2-story building has a stone foundation and uses brick cladding materials with a pedimented gable, composition roof. The full front porch has a hip roof. The building also has 6/2 paired sash in pedimented gable, stone lintels and sills, and exterior wall chimneys.

United States Department of the Interior
National Park Service

National Register of Historic Places Continuation Sheet

Section
number 7 Page 49

Old Hyde Park West Historic District
Jackson County, Missouri

190. 3337 Wyandotte

Building Date: 1905; *Stories:* 2 1/2; *Plan:* Square; *Style:* Kansas City Shirtwaist; *Architect:* (Unknown);
Builder: (Unknown); *Property Type:* Domestic, single dwelling; *Integrity:* Fair

Description: This 2 1/2-story building has a stone foundation and uses stone and asbestos shingles cladding materials with a gabled, composition roof. The full front porch has a gabled roof while the rear porch is enclosed. The building also has dormers with bellcast eaves and paired third-story windows.

191. 3339 Wyandotte

Building Date: 1905; *Stories:* 2 1/2; *Plan:* Square; *Style:* Kansas City Shirtwaist; *Architect:* (Unknown);
Builder: (Unknown); *Property Type:* Domestic, single dwelling; *Integrity:* Good

Description: This 2 1/2-story building has a stone foundation and uses stone and asbestos shingles cladding materials with a gabled, composition roof. The full front porch has a gabled roof. The building also has cornice returns and wide bellcast eaves. **Garage: 1-story brick garage with flat roof and wood doors. (contributing).**

192. 3341 Wyandotte

Building Date: 1905; *Stories:* 2 1/2; *Plan:* Square; *Style:* Kansas City Shirtwaist; *Architect:* (Unknown);
Builder: (Unknown); *Property Type:* Domestic, single dwelling; *Integrity:* Good

Description: This 2 1/2-story building has a stone foundation and uses stone and asbestos shingles cladding materials with a pedimented gable, composition roof. The full front porch has a hip roof. The building also has sidelights, and a pedimented gable with bellcast eaves.

193. 3344 Wyandotte

Building Date: 1916; *Stories:* 1 1/2; *Plan:* Square; *Style:* Bungalow:Craftsman; *Architect:* (Unknown);
Builder: (Unknown); *Property Type:* Domestic, single dwelling; *Integrity:* Good

Description: This 1 1/2 story building has a stone foundation and uses stucco cladding materials with a gabled, composition roof. The full front porch is recessed. The building also has exposed, notched rafter tails; arched porch openings; vertically divided sash; tripartite window; and sidelights.

United States Department of the Interior
National Park Service

National Register of Historic Places Continuation Sheet

Section
number 7 Page 50

Old Hyde Park West Historic District
Jackson County, Missouri

194. 3345 Wyandotte

Building Date: 1905; *Stories:* 2 1/2; *Plan:* Square; *Style:* Kansas City Shirtwaist; *Architect:* (Unknown); *Builder:* (Unknown); *Property Type:* Domestic, single dwelling; *Integrity:* Fair

Description: This 2 1/2-story building has a stone foundation and uses stone and asbestos shingles cladding materials with a gabled, composition roof. The full front porch has a gabled roof. The building also has cornice returns; wide, bellcast eaves; and sidelights. **Garage: 1-story woodframe modern garage with gabled roof. (noncontributing).**

195. 3347 Wyandotte

Building Date: 1905; *Stories:* 2 1/2; *Plan:* Square; *Style:* Kansas City Shirtwaist; *Architect:* (Unknown); *Builder:* (Unknown); *Property Type:* Domestic, single dwelling; *Integrity:* Good

Description: This 2 1/2-story building has a stone foundation and uses stone and asbestos shingles cladding materials with a hip, composition roof. The full front porch has a hip roof. The building also has wide, bellcast eaves, diamond-paned sash, and paired windows.

196. 3351 Wyandotte

Building Date: 1905; *Stories:* 2 1/2; *Plan:* Square; *Style:* Kansas City Shirtwaist; *Architect:* (Unknown); *Builder:* (Unknown); *Property Type:* Domestic, single dwelling; *Integrity:* Poor

Description: This 2 1/2-story building has a stone foundation and uses brick and asbestos shingles cladding materials with a pedimented gable, composition roof. The full front porch has a gabled roof. The building also has bellcast eaves, and paired gable windows with diamond-pane sash.

3400 Wyandotte - Vacant Lot

197. 3401-03 Wyandotte

Building Date: 1902; *Stories:* 2; *Plan:* Rectangular; *Style:* Four-family flat; *Architect:* (Unknown); *Builder:* (Unknown); *Property Type:* Domestic, multiple dwelling; *Integrity:* Fair

Description: This two-story building has a brick foundation and uses brick cladding materials with a flat, composition roof. The front porch is second-floor balcony. The building also has patterned brick eaves and arched openings.

United States Department of the Interior
National Park Service

National Register of Historic Places Continuation Sheet

Section
number 7 Page 51

Old Hyde Park West Historic District
Jackson County, Missouri

198. 3405-07 Wyandotte

Building Date: 1902; *Stories:* 2; *Plan:* Rectangular; *Style:* Four-family flat; *Architect:* (Unknown); *Builder:* (Unknown); *Property Type:* Domestic, multiple dwelling; *Integrity:* Fair

Description: This two-story building has a brick foundation and uses brick cladding materials with a flat, composition roof. The full front porch has is two-story, balcony style. The building also has patterned brick eaves and arched openings.

3404-08 Wyandotte - Vacant Lot

3410-14 Wyandotte - Vacant Lot

199. 3415 Wyandotte

Building Date: 1902; *Stories:* 2 1/2; *Plan:* Rectangular; *Style:* Kansas City Shirtwaist; *Architect:* (Unknown); *Builder:* J.A. Rose, realtor; *Property Type:* Domestic, single dwelling; *Integrity:* Fair

Description: This three-story building has a stone foundation, a wood frame, and uses stone and asbestos shingles cladding materials with a pedimented, gable roof. The full front porch is a shed type. The building also has Tuscan columns, bellcast eaves, and a tripartite window. **Garage: 1-story clapboard garage with gabled roof and wood doors. (contributing).**

200. 3416 Wyandotte

Building Date: 1921; *Stories:* 3; *Plan:* Rectangular; *Style:* Walk-up, tapestry brick; *Architect:* (Unknown); *Builder:* W. Lee Smith; *Property Type:* Domestic, multiple dwelling; *Integrity:* Good

Description: This three-story building has a stone foundation and uses brick cladding materials with a flat, composition roof. There is no porch. The building also has decorative brick and stone detail, grouped windows with decorative sash, and sidelights.

201. 3418 Wyandotte

Building Date: 1902; *Stories:* 2 1/2; *Plan:* Square; *Style:* Kansas City Shirtwaist; *Architect:* (Unknown); *Builder:* J.A. Rose; *Property Type:* Domestic, single dwelling; *Integrity:* Good

Description: This 2 1/2-story building has a stone foundation, a wood frame, and uses brick and asbestos shingles cladding materials with a gabled, composition roof. The full front porch has a pedimented, gable roof. The building also has a pedimented gable and arched first story window openings.

United States Department of the Interior
National Park Service

National Register of Historic Places

Continuation Sheet

Section
number 7 Page 52

Old Hyde Park West Historic District
Jackson County, Missouri

202. 3419 Wyandotte

Building Date: 1905; *Stories:* 2 1/2; *Plan:* Irregular; *Style:* Kansas City Shirtwaist; *Architect:* (Unknown); *Builder:* (Unknown); *Property Type:* Domestic, multiple dwelling; *Integrity:* Poor

Description: This 2 1/2-story building has a stone foundation, a wood frame, and uses brick and vinyl cladding materials with a gabled, composition roof. The full front porch has a pedimented, gable roof. The building also has a three-story bay, sidelights, stone lintels, and cornice returns and bellcast eaves. **Garage: 1-story vinyl siding garage with hip roof and wood doors. (noncontributing).**

203. 3420-24 Wyandotte

Building Date: 1915; *Stories:* 2 1/2; *Plan:* Irregular; *Style:* Two-family flat; *Architect:* (Unknown); *Builder:* (Unknown); *Property Type:* Domestic, multiple dwelling; *Integrity:* Poor

Description: This 2 1/2-story building has a stone foundation and uses brick and lap siding cladding materials with a hip, composition roof. The flat front porch is two-story, enclosed. The building also has an enclosed sleeping porch, arched openings, and brick detailing.

204. 3421 Wyandotte

Building Date: 1915; *Stories:* 3; *Plan:* Rectangular; *Style:* Colonnaded walk-up, Neoclassical; *Architect:* (Unknown); *Builder:* Charles Luce; *Property Type:* Domestic, multiple dwelling; *Integrity:* Fair

Description: This three-story building has a stone foundation and uses brick cladding materials with a flat, composition roof. There is no porch. The building also has full-height Ionic columns, wide entablature with paired brackets and recessed panels.

205. 3425 Wyandotte

Building Date: 1902; *Stories:* 2 1/2; *Plan:* Square; *Style:* Kansas City Shirtwaist; *Architect:* (Unknown); *Builder:* J.A. Rose, realtor; *Property Type:* Domestic, multiple dwelling; *Integrity:* Fair

Description: This 2 1/2-story building has a stone foundation, a wood and stone frame, and uses stone and asbestos shingles cladding materials with a gabled, composition roof. The full front enclosed porch is of the shed type. The building also has bellcast eaves, tripartite, paired and single windows with ledge moldings, and square posts with recessed panels. **Garage: 1-story shingle garage with flat roof and wood doors. Noncontributing.**

3426 Wyandotte - Vacant Lot

United States Department of the Interior
National Park Service

National Register of Historic Places Continuation Sheet

Section
number 7 Page 53

Old Hyde Park West Historic District
Jackson County, Missouri

206. 3427 Wyandotte

Building Date: 1904; *Stories:* 2 1/2; *Plan:* Square; *Style:* Kansas City Shirtwaist; *Architect:* (Unknown);
Builder: J.A. Rose, realtor; *Property Type:* Domestic, multiple dwelling; *Integrity:* Fair

Description: This 2 1/2-story building has a stone foundation, a wood and stone frame, and uses stone and asbestos shingles cladding materials with a hip, composition roof. The full front porch has a hip roof. The building also has bellcast eaves, tripartite windows, and Tuscan columns. **Garage: 1-story wood frame garage with wood doors. (noncontributing).**

207. 3432-34 Wyandotte

Building Date: 1902; *Stories:* 2 1/2; *Plan:* Irregular; *Style:* Two-family flat: Colonial Revival; *Architect:* (Unknown); *Builder:* J.A. Rose, realtor; *Property Type:* Domestic, multiple dwelling; *Integrity:* Excellent

Description: This 2 1/2-story building uses brick cladding materials with a hip, composition roof. The two-story front porch is gabled, balcony. The building also has quoins, projecting, two-story entrance porch with Tuscan columns and brick piers, and arched openings.

208. 3509-11 Wyandotte

Building Date: 1909; *Stories:* 3; *Plan:* Square; *Style:* Walk-up, Colonial Revival; *Architect:* (Unknown);
Builder: Jacob Schweizer; *Property Type:* Domestic, multiple dwelling; *Integrity:* Fair

Description: This three-story building has a stone foundation and uses brick cladding materials with a flat, composition roof. The front porch is three-story, with a flat roof. The building also has full-height, pier (wood) over post (brick) colonnade, fluted pilasters, Classical entrance surround, and French doors with transoms.

209. 3513-15 Wyandotte

Building Date: 1909; *Stories:* 3; *Plan:* Square; *Style:* Colonnaded walk-up, Neoclassical; *Architect:* John C. Williams; *Builder:* James Hughes; *Property Type:* Domestic, multiple dwelling; *Integrity:* Good

Description: This three-story building has a stone foundation and uses brick cladding materials with a flat, composition roof. The front porch is three-story, with a flat roof. The building also has full-height, column-over-pier Corinthian colonnade; wide entablature with dentils and ornate brackets; Classical entrance surround; matchstick balustrade; and stone lintels and sills.

United States Department of the Interior
National Park Service

National Register of Historic Places Continuation Sheet

Section
number 7 Page 54

Old Hyde Park West Historic District
Jackson County, Missouri

210. 3517-19 Wyandotte

Building Date: 1911; *Stories:* 3; *Plan:* Square; *Style:* Colonnaded walk-up, Neoclassical; *Architect:* (Unknown); *Builder:* Gilchrist-Weidenbeck; *Property Type:* Domestic, multiple dwelling; *Integrity:* Good

Description: This three-story building has a stone foundation and uses brick cladding materials with a flat, composition roof. The front three-story porch has a flat roof. The building has full-height, fluted ionic colonnade, stone lintels and sills, dentiled eaves and a three-story bay.

211. 3521-23 Wyandotte

Building Date: 1909; *Stories:* 2; *Plan:* Rectangular; *Style:* Colonnaded: neoclassical; *Architect:* (Unknown); *Builder:* Ed A. Leland; *Property Type:* Domestic, four family flat; *Integrity:* Excellent

Description: This two-story building has a stone foundation and uses brick cladding materials with a flat composition roof. The front, full, two-story porch also has a flat roof. The building is full-height, fluted ionic colonnade; it has brick quoins and exaggerated dentils, two-story polygonal bay, stone lintels and sills, and a matchstick balustrade.

212. 3525-27 Wyandotte

Building Date: 1909; *Stories:* 2; *Plan:* Square; *Style:* Colonnaded: neoclassical; *Architect:* (Unknown); *Builder:* Ed A. Leland; *Property Type:* Domestic, four family flat; *Integrity:* Excellent

Description: This two-story building has a stone foundation and uses brick cladding materials with a flat composition roof. The front, 3/4, two-story porch also has a flat roof. The building is full-height, fluted ionic colonnade; it has brick quoins and exaggerated dentils, two-story polygonal bay with shingles, stone lintels and sills, and a matchstick balustrade. **Garage: 1-story brick garage with flat roof and wood doors. (contributing).**

213. 3528 Wyandotte

Building Date: 1900; *Stories:* 2 1/2; *Plan:* Square; *Style:* Colonial Revival; *Architect:* (Unknown); *Builder:* (Unknown); *Property Type:* Domestic, single dwelling; *Integrity:* Good

Description: This 2 1/2-story building has a stone foundation and uses brick cladding materials with a hip composition roof. There are front and rear porches with hip roofs. The building has a dormer with flare walls and paired windows, stone lintels and sills, and a "Green Man" plaque.

United States Department of the Interior
National Park Service

National Register of Historic Places Continuation Sheet

Section
number 7 Page 55

Old Hyde Park West Historic District
Jackson County, Missouri

214. 3529-31 Wyandotte

Building Date: 1910; *Stories:* 2; *Plan:* Square; *Style:* Four-family flat; *Architect:* (Unknown); *Builder:* (Unknown); *Property Type:* Domestic, multiple dwelling; *Integrity:* Good

Description: This two-story building has a stone foundation and uses brick cladding materials with a flat composition roof. The front, 3/4, two-story porch also has a flat roof. The building is full-height colonnade; it has brick quoins and exaggerated dentils, stone lintels and sills.

215. 3533-35 Wyandotte

Building Date: 1915; *Stories:* 3; *Plan:* Square; *Style:* Walk-up, Craftsman; *Architect:* (Unknown); *Builder:* (Unknown); *Property Type:* Domestic, multiple dwelling; *Integrity:* Excellent

Description: This three-story building has a stone foundation and uses brick cladding materials with a flat composition roof. The front, three-story porch is enclosed with a mansard roof. The building has wrought iron balconies, multi-light French doors flanked by multi and single-light sidelights, paired brackets, recessed entrance bay, and stone and brick ornament.

216. 3537-39 Wyandotte

Building Date: 1915; *Stories:* 3; *Plan:* Square; *Style:* Walk-up, Craftsman; *Architect:* C.P. Schmidt; *Builder:* J.B. Betterman; *Property Type:* Domestic, multiple dwelling; *Integrity:* Excellent

Description: This three-story building has a stone foundation and uses brick cladding materials with a flat composition roof. The front, three-story porch is enclosed with a mansard roof. The building has screened porches with projecting wrought iron balconies, stone and brick ornament, hipped roof with wide projecting eaves, paired brackets, multi-light sidelights, and a recessed entrance bay.

217. 3538 Wyandotte

Building Date: 1902; *Stories:* 2 1/2; *Plan:* Square; *Style:* Kansas City Shirtwaist; *Architect:* Braeklin; *Builder:* (Unknown); *Property Type:* Domestic, single dwelling; *Integrity:* Good

Description: This 2 1/2-story building has a stone foundation and uses brick and asbestos shingles cladding materials with a hip, composition roof. The front porch is of the type pedimented gable. The building has wide, bellcast eaves, diamond-pane dormer sash, and a patterned balustrade.

United States Department of the Interior
National Park ServiceNational Register of Historic Places
Continuation SheetSection
number 7 Page 56Old Hyde Park West Historic District
Jackson County, Missouri**218. 3600 Wyandotte**

Building Date: 1904; *Stories:* 2 1/2; *Plan:* Square; *Style:* Kansas City Shirtwaist; *Architect:* (Unknown);
Builder: (Unknown); *Property Type:* Domestic, multiple dwelling; *Integrity:* Good

Description: This 2 1/2-story building has a stone foundation, a wood frame, and uses brick and lap siding cladding materials with a hip, composition roof. The front porch has a hip roof while the side porch has a flat roof. The building also has a side porch with square posts; Tuscan columns and brick posts; and gabled dormers with cornice returns.

219. 3601 Wyandotte

Building Date: 1905; *Stories:* 2 1/2; *Plan:* Square; *Style:* Kansas City Shirtwaist; *Architect:* (Unknown);
Builder: (Unknown); *Property Type:* Domestic, single dwelling; *Integrity:* Good

Description: This 2 1/2-story building has a stone foundation, a wood frame, and uses brick and lap siding cladding materials with a hip, composition roof. The full front porch is has a pedimented, gable roof. The building also has asymmetrical gable with multi-light sash and wide eaves.

220. 3605 Wyandotte

Building Date: 1905; *Stories:* 2 1/2; *Plan:* Square; *Style:* Kansas City Shirtwaist; *Architect:* (Unknown);
Builder: (Unknown); *Property Type:* Domestic, single dwelling; *Integrity:* Fair

Description: This 2 1/2-story building has a stone foundation, a wood frame, and uses brick and vinyl cladding materials with a hip, composition roof. The full front porch has a hip roof. The building also has wide, bellcast eaves with modillions; and paired windows in dormers.

221. 3607 Wyandotte

Building Date: 1905; *Stories:* 2 1/2; *Plan:* Square; *Style:* Kansas City Shirtwaist; *Architect:* (Unknown);
Builder: (Unknown); *Property Type:* Domestic, single dwelling; *Integrity:* Good

Description: This 2 1/2-story building has a stone foundation, a wood frame, and uses brick, wood shingle, and lap siding cladding materials with a gabled, composition roof. The full front porch has a pedimented, gable roof. The building also has wide, bellcast eaves; a pedimented porch, and shingles in gable peaks.

United States Department of the Interior
National Park ServiceNational Register of Historic Places
Continuation SheetSection
number 7 Page 57Old Hyde Park West Historic District
Jackson County, Missouri**222. 3608 Wyandotte**

Building Date: 1898; *Stories:* 2 1/2; *Plan:* Irregular; *Style:* Kansas City Shirtwaist; *Architect:* (Unknown); *Builder:* (Unknown); *Property Type:* Domestic, multiple dwelling; *Integrity:* Fair

Description: This 2 1/2-story building has a stone foundation, a wood frame, and uses brick and lap siding cladding materials with a gabled, composition roof. There are no porches. The building also has arched first story openings and stained glass.

223. 3611 Wyandotte

Building Date: 1924; *Stories:* 2 1/2; *Plan:* Square; *Style:* Kansas City Shirtwaist; *Architect:* (Unknown); *Builder:* (Unknown); *Property Type:* Domestic, single dwelling; *Integrity:* Excellent

Description: This 2 1/2-story building has a stone foundation, a wood frame, and uses brick and lap siding cladding materials with a hip, composition roof. The full front porch has a hip roof. The building also has wide, modillioned eaves; hipped dormers with flared walls; and brick posts. **Garage: 1-story clapboard garage with hip roof and wood doors. (contributing).**

224. 3612-14 Wyandotte

Building Date: 1899; *Stories:* 2 1/2; *Plan:* Irregular; *Style:* Two-family flat, Colonial Revival; *Architect:* (Unknown); *Builder:* (Unknown); *Property Type:* Domestic, multiple dwelling; *Integrity:* Fair

Description: This 2 1/2-story building has a stone foundation and uses brick cladding materials with hip and flat, composition roofs. The front porch is two-story, with a flat roof. The building also has wide, dentiled eaves; two-story polygonal bay; quoins; and a two-story front porch.

225. 3615 Wyandotte

Building Date: 1902; *Stories:* 2 1/2; *Plan:* Square; *Style:* Kansas City Shirtwaist; *Architect:* (Unknown); *Builder:* (Unknown); *Property Type:* Domestic, single dwelling; *Integrity:* Fair

Description: This 2 1/2-story building has a stone foundation, a wood frame, and uses brick and asbestos shingles cladding materials with a hip, composition roof. The full front porch has a hip roof. The building also has wide eaves and hipped dormers with paired windows. James E. Jordan was a resident in 1917.

United States Department of the Interior
National Park ServiceNational Register of Historic Places
Continuation SheetSection
number 7 Page 58Old Hyde Park West Historic District
Jackson County, Missouri**226. 3616 Wyandotte** (noncontributing due to alterations)

Building Date: 1901; *Stories:* 2 1/2; *Plan:* Square; *Style:* Kansas City Shirtwaist; *Architect:* (Unknown);
Builder: (Unknown); *Property Type:* Domestic, single dwelling; *Integrity:* Fair

Description: This 2 1/2-story building has a stone foundation, a wood frame, and uses brick and vinyl siding cladding materials with a hip, composition roof. The front porch was replaced in 1999 after a fire. The building also has modillioned eaves (dormers and porch); triple-column porch supports; bellcast eaves, and paired dormer windows. George P. Whitsett was the resident in 1917.

227. 3617 Wyandotte

Building Date: 1909; *Stories:* 2; *Plan:* Square; *Style:* Two-family flat, Colonial Revival; *Architect:* (Unknown); *Builder:* W.J. Morley; *Property Type:* Domestic, multiple dwelling; *Integrity:* Excellent

Description: This two-story building has a stone foundation and uses brick cladding materials with a flat, composition roof. The 3/4 front porch is two-story with a flat roof. The building also has two-story, column-over-pier colonnade; wide entablature with dentiled eaves; stone lintels and sills with quoining at windows; tiled and bracketed hood over secondary entrance. John C. Fallon and Mrs. S.A. Stanley were residents in 1917.

228. 3618 Wyandotte

Building Date: 1901; *Stories:* 2 1/2; *Plan:* Square; *Style:* Kansas City Shirtwaist; *Architect:* (Unknown); *Builder:* (Unknown); *Property Type:* Domestic, single dwelling; *Integrity:* Good

Description: This 2 1/2-story building has a stone foundation; wood frame construction; and uses stone and asbestos shingles cladding materials with a hip, composition roof. The front porch has a hip roof. The building also has stone columns. John a Durkin was the resident in 1917.

229. 3619-21 Wyandotte

Building Date: 1909; *Stories:* 2; *Plan:* Rectangular; *Style:* Four-family flat: Colonial Revival; *Architect:* (Unknown); *Builder:* (Unknown); *Property Type:* Domestic, multiple dwelling; *Integrity:* Good

Description: This two-story building uses brick cladding materials with a flat, composition roof. The front porch is three-story with a flat roof. The building also has two-story, brick post, colonnaded porch; wide eaves with modillions and dentils; and stone sills. Paul Hillgardner, George T. Scovill, and Forest Schulz, music (3621) residents in 1917.

United States Department of the Interior
National Park Service

National Register of Historic Places Continuation Sheet

Section
number 7 Page 59

Old Hyde Park West Historic District
Jackson County, Missouri

230. 3620 Wyandotte

Building Date: 1901; *Stories:* 1 1/2; *Plan:* Square; *Style:* Kansas City Shirtwaist; *Architect:* (Unknown); *Builder:* (Unknown); *Property Type:* Domestic, single dwelling; *Integrity:* Fair

Description: This 1 1/2 story building has a stone foundation, a wood frame, and uses brick and lap siding cladding materials with a gabled, composition roof. The front porch has a hip roof. The building also has pedimented gable and arched openings in first story with stone sills.

231. 3623 Wyandotte

Building Date: 1890; *Stories:* 2 1/2; *Plan:* Irregular; *Style:* Queen Anne; *Architect:* (Unknown); *Builder:* (Unknown); *Property Type:* Domestic, single dwelling; *Integrity:* Good

Description: This 2 1/2-story building has a stone foundation and uses brick cladding materials with a hip, composition roof. The full front porch has a shed roof. The building also has an eyebrow window; a curved second story bay window; brackets; a pedimented porch; Tuscan columns; stained glass; and arched window openings. Sarah E. Schroer was the resident in 1917. **Garage: 1-story modern garage with flat roof and modern doors. (noncontributing).**

232. 3624 Wyandotte

Building Date: 1903; *Stories:* 2 1/2; *Plan:* Square; *Style:* Kansas City Shirtwaist, Craftsman; *Architect:* (Unknown); *Builder:* (Unknown); *Property Type:* Domestic, single dwelling; *Integrity:* Good

Description: This 2 1/2-story building has a stone foundation; a wood frame; and uses stone and lap siding cladding materials with a hip, composition roof. The front porch has a hip roof. The building also has paired hip dormers; and wide, bellcast eaves with modillions.

233. 3627-29 Wyandotte (noncontributing due to alternations)

Building Date: 1890; *Stories:* 2; *Plan:* Irregular; *Style:* Two-family flat; *Architect:* (Unknown); *Builder:* (Unknown); *Property Type:* Domestic, multiple dwelling; *Integrity:* Fair

Description: This two-story building has a stone foundation and uses brick cladding materials with a gabled, composition roof. The full front porch is three-story with a gabled roof. The building also has French doors flanked by 1/1 windows. Elder A. Forbes and Isabel McKenna were residents in 1917.

United States Department of the Interior
National Park Service

National Register of Historic Places Continuation Sheet

Section
number 7 Page 60

Old Hyde Park West Historic District
Jackson County, Missouri

234. 3628 Wyandotte

Building Date: 1903; *Stories:* 2 1/2; *Plan:* Square; *Style:* Kansas City Shirtwaist, Craftsman; *Architect:* (Unknown); *Builder:* (Unknown); *Property Type:* Domestic, single dwelling; *Integrity:* Fair

Description: This two+-story building has a stone foundation; a wood frame; and uses stone and lap siding cladding materials with a gabled, composition roof. The enclosed front porch has a gabled roof. The building also has bracketed eaves; paired windows; and tripartite windows in the gable. W.H. Blood was the resident in 1917.

235. 3631 Wyandotte

Building Date: ca. 1890 (moved to site 1986); *Stories:* 2 1/2; *Plan:* Irregular; *Style:* Craftsman; *Architect:* (Unknown); *Builder:* (Unknown); *Property Type:* Domestic, single dwelling; *Integrity:* Excellent

Description: This 2 1/2-story building has a wood frame and uses wood shingles and other cladding materials with a cross-gabled, composition roof. The 1/3 front porch is recessed. The building also has half-timbering in gable; wide eaves with cornice returns; recessed entrance; and corner pilasters with recessed panels.

236. 3632 Wyandotte

Building Date: 1903; *Stories:* 2 1/2; *Plan:* Square; *Style:* Kansas City Shirtwaist, Craftsman; *Architect:* (Unknown); *Builder:* (Unknown); *Property Type:* Domestic, single dwelling; *Integrity:* Excellent

Description: This 2 1/2-story building has a stone foundation, a wood frame, and uses wood shingles cladding materials with a hip, composition roof. The front porch has a hip roof. The building also has paired hip dormers with star-patterned sash; round stone columns; paired windows; and wide, bellcast eaves.

237. 3636 Wyandotte

Building Date: 1903; *Stories:* 2 1/2; *Plan:* Square; *Style:* Kansas City Shirtwaist; *Architect:* (Unknown); *Builder:* (Unknown); *Property Type:* Domestic, single dwelling; *Integrity:* Excellent

Description: This 2 1/2-story building has a stone foundation; a wood frame; and uses stone and lap siding cladding materials with a hip, composition roof. The front porch has a gabled roof. The building also has wide, bellcast eaves with paired modillions; and a hip dormer with tripartite window.

United States Department of the Interior
National Park Service

National Register of Historic Places Continuation Sheet

Section
number 7 Page 61

Old Hyde Park West Historic District
Jackson County, Missouri

238. 3637 Wyandotte

Building Date: 1900; *Stories:* 2 1/2; *Plan:* Square; *Style:* Kansas City Shirtwaist, Craftsman; *Architect:* (Unknown); *Builder:* (Unknown); *Property Type:* Domestic, single dwelling; *Integrity:* Good

Description: This 2 1/2-story building has a stone foundation, a wood frame, and uses brick and lap siding cladding materials with a hip, composition roof. The full front porch has a hip roof. The building also has hip dormer with flared walls; patterned upper sash; pedimented porch; and battered piers. **Garage: 1-story clapboard garage with gabled roof and modern doors. (noncontributing).**

239. 3640 Wyandotte

Building Date: 1903; *Stories:* 2 1/2; *Plan:* Square; *Style:* Kansas City Shirtwaist; Colonial Revival
Architect: (Unknown); *Builder:* (Unknown); *Property Type:* Domestic, single dwelling; *Integrity:* Excellent

Description: This 2 1/2-story building has a stone foundation; a wood frame; and uses brick, wood shingles, and lap siding cladding materials with a gabled, composition roof. The front porch has a hip roof. The building also has wide, modillioned eaves; pent overhang in gable; pedimented dormers; oriel; brick posts with decorative banding; ornamental plaque in second story. **Garage: 1-story clapboard garage with gabled roof and wood doors. (contributing).**

240. 3641 Wyandotte

Building Date: 1901; *Stories:* 2 1/2; *Plan:* Square; *Style:* Kansas City Shirtwaist; *Architect:* (Unknown); *Builder:* (Unknown); *Property Type:* Domestic, single dwelling; *Integrity:* Fair

Description: This 2 1/2-story building has a stone foundation, a wood frame, and uses brick and vinyl cladding materials with a hip, composition roof. The full front porch has a hip roof. The building also has wide, bellcast eaves; and a hip dormer.

241. 3643 Wyandotte

Building Date: 1901; *Stories:* 2 1/2; *Plan:* Square; *Style:* Kansas City Shirtwaist; *Architect:* (Unknown); *Builder:* (Unknown); *Property Type:* Domestic, single dwelling; *Integrity:* Good

Description: This 2 1/2-story building has a stone foundation, a wood frame, and uses brick and lap siding cladding materials with a gabled, composition roof. The full front porch has a shed roof. The building also has wide, bellcast eaves; end-pedimented porch; tripartite 12/1 sash in gable; cross-gabled pedimented dormers.

United States Department of the Interior
National Park Service

National Register of Historic Places Continuation Sheet

Section
number 7 Page 62

Old Hyde Park West Historic District
Jackson County, Missouri

242. 3644 Wyandotte

Building Date: 1903; *Stories:* 2 1/2; *Plan:* Square; *Style:* Kansas City Shirtwaist, Craftsman; *Architect:* (Unknown); *Builder:* (Unknown); *Property Type:* Domestic, single dwelling; *Integrity:* Good

Description: This 2 1/2-story building has a stone foundation; masonry, stone, and wood frame; and uses stone and asbestos shingles cladding materials with a hip, composition roof. The full porch has a hip roof. The building also has wide eaves with paired modillions; hip dormers with flared walls; and stone columns.

243. 3645 Wyandotte

Building Date: 1901; *Stories:* 2 1/2; *Plan:* Square; *Style:* Kansas City Shirtwaist; *Architect:* (Unknown); *Builder:* (Unknown); *Property Type:* Domestic, single dwelling; *Integrity:* Good

Description: This 2 1/2-story building has a stone foundation, a wood frame, and uses brick and lap siding cladding materials with a hip, composition roof. The full front porch has a hip roof. The building also has wide, bellcast eaves; paired windows in hip dormer; leaded glass; and cross-gabled hip dormers.

244. 3648 Wyandotte

Building Date: 1903; *Stories:* 2 1/2; *Plan:* Square; *Style:* Kansas City Shirtwaist, Craftsman; *Architect:* (Unknown); *Builder:* (Unknown); *Property Type:* Domestic, single dwelling; *Integrity:* Good

Description: This 2 1/2-story building has a stone foundation; a wood frame; and uses stone and asbestos shingles cladding materials with a gabled, composition roof. There is a ell, gabled porch. The building also has a wraparound porch; and wide, bracketed eaves.

245. 3700-02 Wyandotte

Building Date: 1905; *Stories:* 2; *Plan:* Square; *Style:* Colonnaded Four-Family Flat: Neoclassical; *Architect:* (Unknown); *Builder:* Emmet E. Jones; *Property Type:* Domestic, multiple dwelling; *Integrity:* Excellent

Description: This two-story building has a stone foundation and uses brick cladding materials with a flat, composition roof. The front porch is two-story with a gabled roof. The building also has paired, pedimented two story porches flanking central entrance; Classical entrance surround; matchstick and star-patterned balustrade; quoins; and stone sills.

United States Department of the Interior
National Park Service

National Register of Historic Places Continuation Sheet

Section
number 7 Page 63

Old Hyde Park West Historic District
Jackson County, Missouri

246. 3701 Wyandotte

Building Date: 1899; *Stories:* 2 1/2; *Plan:* Square; *Style:* Kansas City Shirtwaist; *Architect:* (Unknown);
Builder: (Unknown); *Property Type:* Domestic, single dwelling; *Integrity:* Fair

Description: This 2 1/2-story building has a stone foundation, a wood frame, and uses brick and lap siding cladding materials with a hip, composition roof. The full front porch has a flat roof. The building also has wide bellcast eaves; hip dormer with paired sash.

247. 3704 Wyandotte (noncontributing due to age)

Building Date: 1967; *Stories:* 2; *Plan:* Square; *Style:* Four-Family Flat: Environmental Modern; *Architect:* (Unknown); *Builder:* (Unknown); *Property Type:* Domestic, multiple dwelling; *Integrity:* Excellent

Description: This two-story building has projecting flat rooflets over each bay; and balconies.

248. 3705 Wyandotte

Building Date: 1899; *Stories:* 2 1/2; *Plan:* Square; *Style:* Colonial Revival; *Architect:* (Unknown); *Builder:* (Unknown); *Property Type:* Domestic, single dwelling; *Integrity:* Fair

Description: This 2 1/2-story building has a stone foundation, a wood frame, and uses brick and lap siding cladding materials with a hip, composition roof. The full front porch has a hip roof. The building also has wide bellcast eaves; pedimented dormer with pilasters; 15/1 windows; fluted, Doric columns; and stone sills.

249. 3710 Wyandotte (noncontributing due to age)

Building Date: 1967; *Stories:* 2; *Plan:* L-Shaped; *Style:* Double-Loaded Corridor; *Architect:* (Unknown); *Builder:* (Unknown); *Property Type:* Domestic, multiple dwelling; *Integrity:* Excellent

Description: This two-story building has a poured concrete foundation, a wood frame, and uses brick and wood shingles cladding materials with a flat, composition roof. The front porch is two-story, arcade style.

250. 3711 Wyandotte

Building Date: 1901; *Stories:* 2 1/2; *Plan:* Square; *Style:* Kansas City Shirtwaist/Dutch Colonial Revival; *Architect:* (Unknown); *Builder:* (Unknown); *Property Type:* Domestic, single dwelling; *Integrity:* Good

Description: This 2 1/2-story building has a stone foundation; a wood frame; and uses stone and wood shingles cladding materials with a gambrel, composition roof. The full front porch has a pedimented gabled roof. The building also has gambrel roof with cornice returns; paired oriels in 2nd story; triple-column porch supports; modillioned eaves; and a gabled dormer.

United States Department of the Interior
National Park Service

National Register of Historic Places Continuation Sheet

Section
number 7 Page 64

Old Hyde Park West Historic District
Jackson County, Missouri

251. 3715 Wyandotte

Building Date: 1901; *Stories:* 2 1/2; *Plan:* Square; *Style:* Kansas City Shirtwaist, Craftsman; *Architect:* (Unknown); *Builder:* (Unknown); *Property Type:* Domestic, single dwelling; *Integrity:* Good

Description: This 2 1/2-story building has a stone foundation, a wood frame, and uses stone and wood shingles cladding materials with a gabled, composition roof. The full front porch has a shed roof. The building also has tripartite window in gable and curved-brace porch supports on stone piers.

252. 3716-18 Wyandotte

Building Date: 1911 c.; *Stories:* 3 1/2; *Plan:* Irregular; *Style:* Kansas City Shirtwaist; *Architect:* (Unknown); *Builder:* (Unknown); *Property Type:* Domestic, multiple dwelling; *Integrity:* Fair

Description: This three+-story building has a stone foundation, a wood frame, and uses brick and lap siding cladding materials with a gabled, composition roof. The full front porch is two-story with a flat roof. The building also has knee-braced front gable; dentiled beltcourse; polygonal bay; two-story porch between 2nd and 3rd stories.

253. 3720 Wyandotte

Building Date: 1892; *Stories:* 2 1/2; *Plan:* Rectangular; *Style:* Victorian Eclectic; *Architect:* (Unknown); *Builder:* (Unknown); *Property Type:* Domestic, single dwelling; *Integrity:* Fair

Description: This 2 1/2-story building has a stone foundation, a wood frame, and uses brick cladding materials with a hip, composition roof. The front porch has a flat roof. The building also has full-height gabled bay; cornice returns; dentiled and bracketed eaves; conical dormer with arched opening and wrought iron finial; and a polygonal bay.

254. 3723 Wyandotte

Building Date: 1902; *Stories:* 2 1/2; *Plan:* Square; *Style:* Kansas City Shirtwaist/ Colonial Revival; *Architect:* (Unknown); *Builder:* (Unknown); *Property Type:* Domestic, single dwelling; *Integrity:* Good

Description: This 2 1/2-story building has a stone foundation, a wood frame, and uses stone and lap siding cladding materials with a hip, composition roof. The full front porch has a hip roof. The building also has Tuscan columns; leaded glass; pedimented dormer with wide modillioned eaves and paired columns.

United States Department of the Interior
National Park Service

National Register of Historic Places Continuation Sheet

Section
number 7 Page 65

Old Hyde Park West Historic District
Jackson County, Missouri

255. 3724 Wyandotte

Building Date: 1899; *Stories:* 2 1/2; *Plan:* Square; *Style:* Kansas City Shirtwaist; *Architect:* (Unknown);
Builder: (Unknown); *Property Type:* Domestic, single dwelling; *Integrity:* Fair

Description: This 2 1/2-story building has a stone foundation, a wood frame, and uses brick and asbestos shingles cladding materials with a hip, composition roof. The full front porch has a hip roof while the rear porch is two-story. The building also has wide, bellcast eaves; hid dormer with flared walls and paired, diamond-pane sash.

256. 3725 Wyandotte

Building Date: 1902; *Stories:* 2 1/2; *Plan:* Square; *Style:* Kansas City Shirtwaist; *Architect:* (Unknown);
Builder: (Unknown); *Property Type:* Domestic, single dwelling; *Integrity:* Fair

Description: This 2 1/2-story building has a stone foundation, a wood frame, and uses stone and asbestos shingles cladding materials with a gabled, composition roof. The full front porch has a pedimented, gable roof. The building also has a tripartite window in gable.

257. 3727 Wyandotte

Building Date: 1902; *Stories:* 2 1/2; *Plan:* Square; *Style:* Kansas City Shirtwaist, Craftsman; *Architect:* (Unknown);
Builder: (Unknown); *Property Type:* Domestic, single dwelling; *Integrity:* Excellent

Description: This 2 1/2-story building has a stone foundation, a wood frame, and uses stone and lap siding cladding materials with a hip, composition roof. The full front porch has a hip roof. The building also has wide eaves, battered piers, and hip dormers. It was the Park Inn Hotel in 1917.

258. 3729 Wyandotte

Building Date: 1902; *Stories:* 2 1/2; *Plan:* Square; *Style:* Kansas City Shirtwaist; *Architect:* (Unknown);
Builder: (Unknown); *Property Type:* Domestic, single dwelling; *Integrity:* Fair

Description: This 2 1/2-story building has a stone foundation, a wood frame, and uses brick and asbestos shingles cladding materials with a gabled, composition roof. The full front porch has a flat roof, and there is a balcony in the rear. The building also wide eaves with cornice returns and Ionic corner pilasters.

United States Department of the Interior
National Park Service

National Register of Historic Places Continuation Sheet

Section
number 7 Page 66

Old Hyde Park West Historic District
Jackson County, Missouri

259. 3730 Wyandotte

Building Date: 1901; *Stories:* 2 1/2; *Plan:* Square; *Style:* Kansas City Shirtwaist/Colonial Revival; *Architect:* (Unknown); *Builder:* (Unknown); *Property Type:* Domestic, single dwelling; *Integrity:* Good

Description: This 2 1/2-story building has a stone foundation, a wood frame, and uses brick and asbestos shingles cladding materials with a hip, composition roof. The front porch has a flat roof. The building also has a polygonal dormer, curved portico with flanking patios, and a decorative upper sash.

260. 3731 Wyandotte

Building Date: 1901; *Stories:* 2 1/2; *Plan:* Square; *Style:* Kansas City Shirtwaist; *Architect:* (Unknown); *Builder:* (Unknown); *Property Type:* Domestic, single dwelling; *Integrity:* Fair

Description: This 2 1/2-story building has a stone foundation, a wood frame, and uses brick and asbestos shingles cladding materials with a hip, composition roof. The full front porch is enclosed with a hip roof. The building also has wide, bellcast eaves with modillions.

261. 3733 Wyandotte

Building Date: 1901; *Stories:* 2 1/2; *Plan:* Square; *Style:* Kansas City Shirtwaist; *Architect:* (Unknown); *Builder:* (Unknown); *Property Type:* Domestic, single dwelling; *Integrity:* Fair

Description: This 2 1/2-story building has a stone foundation, a wood frame, and uses brick and wood shingles cladding materials with a gabled, composition roof. The full front porch has a pedimented, gable roof. The building also has bellcast eaves and Tuscan columns.

262. 3734 Wyandotte

Building Date: 1890; *Stories:* 2 1/2; *Plan:* Irregular; *Style:* Queen Anne; *Architect:* (Unknown); *Builder:* (Unknown); *Property Type:* Domestic, single dwelling; *Integrity:* Good

Description: This 2 1/2-story building has a stone foundation, a wood frame, and uses brick cladding materials with a gabled, composition roof. The front porch has a pedimented, gable roof. The building also has projecting front pavilion; paired windows in main gable; semi-circular window in pavilion gable; stone sills, and pedimented gables.

United States Department of the Interior
National Park Service

National Register of Historic Places Continuation Sheet

Section
number 7 Page 67

Old Hyde Park West Historic District
Jackson County, Missouri

263. 3735 Wyandotte

Building Date: 1901; *Stories:* 2; *Plan:* Square; *Style:* Kansas City Shirtwaist; *Architect:* (Unknown);
Builder: (Unknown); *Property Type:* Domestic, single dwelling; *Integrity:* Fair

Description: This two-story building has a stone foundation, a wood frame, and uses brick and asbestos shingles cladding materials with a hip, composition roof. The full front porch has a hip roof. The building also has battered porch posts. George E. Swope was a resident in 1917.

264. 3737 Wyandotte

Building Date: 1899; *Stories:* 2 1/2; *Plan:* Square; *Style:* Kansas City Shirtwaist; *Architect:* (Unknown);
Builder: (Unknown); *Property Type:* Domestic, single dwelling; *Integrity:* Good

Description: This 2 1/2-story building has a stone foundation, a wood frame, and uses brick and lap siding cladding materials with a gabled, composition roof. The full front porch has a hip roof. The building also has Tuscan columns on battered stone piers and stone sills.

265. 3738 Wyandotte

Building Date: 1906; *Stories:* 2 1/2; *Plan:* Square; *Style:* Kansas City Shirtwaist; *Architect:* (Unknown);
Builder: (Unknown); *Property Type:* Domestic, single dwelling; *Integrity:* Fair

Description: This 2 1/2-story building has a stone foundation, a wood frame, and uses wood shingles cladding materials with a hip, composition roof. The front porch is ell shaped with a hip roof. The building also has bellcast eaves and a hip dormer with paired 4/1 sash.

266. 3739 Wyandotte (noncontributing due to age)

Building Date: 1967; *Stories:* 2; *Plan:* Rectangular; *Style:* Court Yard Plan; Environmental Modern
Architect: (Unknown); *Builder:* (Unknown); *Property Type:* Domestic, multiple dwelling; *Integrity:*
Excellent

Description: This two-story building has a poured concrete foundation, a wood frame, and uses brick and lap siding cladding materials with a mansard, wood shingle roof. The front porch is two-story balcony style. The building also has curved, wrought iron on the balconies.

United States Department of the Interior
National Park Service

National Register of Historic Places Continuation Sheet

Section
number 7 Page 68

Old Hyde Park West Historic District
Jackson County, Missouri

267. 3740-44 Wyandotte (noncontributing due to age)

Building Date: 1964; *Stories:* 3; *Plan:* Rectangular; *Style:* Court Yard Plan/Environmental Modern
Architect: (Unknown); *Builder:* (Unknown); *Property Type:* Domestic, Multiple dwelling; *Integrity:*
Excellent

Description: This three-story building has a poured concrete foundation, a wood frame, and uses brick cladding materials with a mansard, wood shingled roof. There are front, three-story balconies with wrought iron railings.

268. 3801 Wyandotte (noncontributing due to age)

Building Date: 1955; *Stories:* 1 1/2; *Plan:* Rectangular; *Style:* Modern; *Architect:* (Unknown); *Builder:*
(Unknown); *Property Type:* Religion, religious facility; *Integrity:* Excellent

Description: This 1 1/2 story church has a poured concrete foundation, and uses brick cladding materials with a gabled, composition roof. The building also has patterned brick, attached campanile, and small windows.

269. 3808 Wyandotte

Building Date: 1908; *Stories:* 3; *Plan:* Square; *Style:* Kansas City Shirtwaist; *Architect:* (Unknown);
Builder: (Unknown); *Property Type:* Domestic, multiple dwelling; *Integrity:* Fair

Description: This three-story building has a stone foundation, a wood frame, and uses brick and lap siding cladding materials with a hip, composition roof. There is a full, three-story balcony on the front of the house.

270. 3810 Wyandotte

Building Date: 1908; *Stories:* 2 1/2; *Plan:* Square; *Style:* Kansas City Shirtwaist; *Architect:* (Unknown);
Builder: James O. Wade; *Property Type:* Domestic, single dwelling; *Integrity:* Good

Description: This 2 1/2-story building has a stone foundation, a wood frame, and uses stone and lap siding cladding materials with a hip, composition roof. The front porch has a hip roof. The building also has wide, bellcast eaves and hip dormers.

271. 3814 Wyandotte

Building Date: 1908; *Stories:* 2 1/2; *Plan:* Square; *Style:* Kansas City Shirtwaist; *Architect:* (Unknown);
Builder: (Unknown); *Property Type:* Domestic, multiple dwelling; *Integrity:* Good

Description: This 2 1/2-story building has a stone foundation, a wood frame, and uses brick and wood siding cladding materials with a gabled, composition roof. The front porch has a gabled roof. The building also has cornice returns, stone sills, and brick balustrade with stone coping.

United States Department of the Interior
National Park Service

National Register of Historic Places Continuation Sheet

Section
number 7 Page 69

Old Hyde Park West Historic District
Jackson County, Missouri

272. 3816 Wyandotte

Building Date: 1893; *Stories:* 2 1/2; *Plan:* Irregular; *Style:* Colonial Revival; *Architect:* (Unknown); *Builder:* (Unknown); *Property Type:* Domestic, multiple dwelling; *Integrity:* Fair

Description: This 2 1/2-story building has a stone foundation, a wood frame, and uses lap siding cladding materials with a gabled, composition roof. The porch is ell shaped with a hip roof. The building also modillioned and dentiled cornice, pedimented gables, projecting front pavilion and a tripartite window.

273. 3823 Wyandotte

Building Date: 1897; *Stories:* 2 1/2; *Plan:* Square; *Style:* Colonial Revival; *Architect:* (Unknown); *Builder:* (Unknown); *Property Type:* Domestic, single dwelling; *Integrity:* Good

Description: This 2 1/2-story building has a stone foundation, a wood frame, and uses lap siding cladding materials with a hip, composition roof. The full front porch has a hip roof. The building also has wide, bellcast eaves; polygonal dormer, 12/1 double-hung windows; Tuscan columns and turned-spindle balustrade; and an oval window in the second story.

274. 3827 Wyandotte

Building Date: 1908; *Stories:* 2 1/2; *Plan:* Square; *Style:* Four Square; *Architect:* (Unknown); *Builder:* (Unknown); *Property Type:* Domestic, Single Dwelling; *Integrity:* Good

Description: This 2 1/2-story building has a stone foundation, a wood frame, and uses lap siding cladding materials with a hip, composition roof. The front porch has a hip roof. The building also has elongated battered piers with matchstick balustrade and a hip dormer.

275. 3831 Wyandotte

Building Date: 1907; *Stories:* 2 1/2; *Plan:* Square; *Style:* Kansas City Shirtwaist; *Architect:* (Unknown); *Builder:* (Unknown); *Property Type:* Domestic, single dwelling; *Integrity:* Fair

Description: This 2 1/2-story building has a stone foundation, a wood frame, and uses brick and asbestos shingles cladding materials with a hip, composition roof. The full front porch has a hip roof. The building also has wide, bellcast eaves and a dormer with flared walls.

United States Department of the Interior
National Park ServiceNational Register of Historic Places
Continuation SheetSection
number 7 Page 70Old Hyde Park West Historic District
Jackson County, Missouri**276. 3832-34 Wyandotte** *Historic Name:* Mitchell Woods Apartments*Building Date:* 1912; *Stories:* 3; *Plan:* Square; *Style:* Colonnaded walk-up, Neoclassical; *Architect:* (Unknown); *Builder:* T.C. Mitchell; *Property Type:* Domestic, multiple dwelling; *Integrity:* Fair

Description: This three-story building has a stone foundation, and uses brick cladding materials with a flat, composition roof. The front, two-story balcony has a gabled roof. The building also has full-height, Ionic colonnade; stone quoins, lintels, and sills; two colonnaded porch towers flanking the central entrance; and exaggerated entablature supporting pediment.

277. 3833 Wyandotte *Historic Name:* C. Lee Hochstetler Residence*Building Date:* 1895; *Stories:* 2 1/2; *Plan:* Irregular; *Style:* Dutch Colonial Revival; *Architect:* (Unknown); *Builder:* (Unknown); *Property Type:* Domestic, single dwelling; *Integrity:* Good

Description: This 2 1/2-story building has a stone foundation, a wood frame, and uses lap siding cladding materials with a gabled, composition roof. The full front porch has a shed roof. The building also has end-gabled porch on square posts, a two-story bay window, and curved porch bays. The form and date also suggest Shingle style—evidence could remain beneath siding.

278. 3836-38 Wyandotte *Historic Name:* E.B. Albertson Residence*Building Date:* 1909; *Stories:* 2 1/2; *Plan:* Square; *Style:* Two-family flat, Craftsman; *Architect:* (Unknown); *Builder:* E.B. Albertson; *Property Type:* Domestic, multiple dwelling; *Integrity:* Excellent

Description: This 2 1/2-story building has a stone foundation, a wood frame, and uses wood shingles cladding materials with a hip, composition roof. The 1/2 porch is gabled with a side balcony. The building also has wide, sloping eaves with exposed rafter tails; open second story corner porch; gabled dormer; multi-light sash; and sidelights.

3837 Wyandotte – Vacant Lot**279. 3840-42 Wyandotte***Building Date:* 1909; *Stories:* 2 1/2; *Plan:* Square; *Style:* Two-Family Flat, Craftsman; *Architect:* (Unknown); *Builder:* (Unknown); *Property Type:* Domestic, multiple dwelling; *Integrity:* Fair

Description: This 2 1/2-story building has a stone foundation, a wood frame, and uses wood shingles cladding materials with a hip, composition roof. The 1/2 front porch is gabled with a side balcony. The building also has exposed rafter tails and open second story corner porch.

United States Department of the Interior
National Park Service

National Register of Historic Places Continuation Sheet

Section
number 7 Page 71

Old Hyde Park West Historic District
Jackson County, Missouri

280. 3841 Wyandotte

Building Date: 1904; *Stories:* 2 1/2; *Plan:* Square; *Style:* Colonial Revival; *Architect:* (Unknown); *Builder:* (Unknown); *Property Type:* Domestic, single dwelling; *Integrity:* Good

Description: This 2 1/2-story building has a stone foundation, a stone frame, and uses stone cladding materials with a gabled, composition roof. The full front porch has a flat roof. The building also has oriel with cornice returns, wide eaves with cornice returns, and stone lintels and sills.

281. 3845-47 Wyandotte

Historic Name: "The Ruxton"

Building Date: 1916; *Stories:* 3; *Plan:* Rectangular; *Style:* Colonnaded walk-up, Neoclassical; *Architect:* (Unknown); *Builder:* Charles Luce; *Property Type:* Domestic, multiple dwelling; *Integrity:* Good

Description: This three-story building has a stone foundation, a wood frame, and uses brick cladding materials with a flat, composition roof. The porch is colonnaded with column-over-pier supports. The building also has full-height, column-over-pier Ionic columns; exaggerated cornice with paired brackets and swags; stone and brick trim; porch doors flanked by narrow double-hung windows; and two projecting porch towers flanking central entrance.

United States Department of the Interior
National Park Service**National Register of Historic Places
Continuation Sheet**Section
number8

Page

72Old Hyde Park West Historic District
Jackson County, Missouri

The *Old Hyde Park West Historic District* of Kansas City, Jackson County, Missouri, is significant under National Register Criterion A for the area of COMMUNITY PLANNING AND DEVELOPMENT (1887-1938) and under Criterion C for the area of ARCHITECTURE (1887-1938). The district is significant as an example of a streetcar suburb developed for the growing middle class population of Kansas City at the turn of the century. The initial development of the area coincided with the construction of streetcar lines to the south of the business district in 1887 and with the growth of industrial and manufacturing enterprises in the West Bottoms. The Old Hyde Park West district also represents a variety of late 19th and early 20th century architectural styles. While only a few were designed by architects, the vernacular forms, such as the Kansas City Shirtwaist and Colonnaded Apartment Building are representative examples of middle and upper class housing at the turn of the century in Kansas City. The proposed Old Hyde Park West historic district contains 281 primary buildings, only 15 of which date after 1930. Including the outbuildings, there are 319 resources in the district. Of these, 261 are contributing, 43 are noncontributing properties, and 15 were previously listed on the National Register. The level of integrity from property to property and block to block is high. Prevalent architectural styles include Prairie/Craftsman, Foursquare, Queen Anne, Classical and Tudor Revival, and the locally popular Kansas City Shirtwaist Style. The period of significance is 1887-1938 which includes the date of earliest construction in the district through the end of the last major period of development.

The Old Hyde Park West Historic District meets the criteria for Community Planning and Development as a strong example of a streetcar suburb. The district represents the transformation of Kansas City's rural farmland into urban residential development, made possible by the streetcar. The initial development of the neighborhood coincided with the construction of the streetcar lines to the south of the business district in 1887 and with the expansion of industrial and manufacturing enterprises in the West Bottoms area along the Missouri River. The area's combination of streetcar lines and grid layout characterizes the development of Kansas City as a transportation hub and important commercial center. During the period of significance, the area evolved from a fashionable, upper class, country retreat to a middle class streetcar suburb, largely commissioned by speculative developers, designed by some of the city's most prolific architects, and occupied by a rising class of industrial managers and other professionals.

Old Hyde Park West meets the criteria for Architecture via its representation of a variety of late 19th century and early 20th Century architectural style. The most prevalent examples are Prairie/Craftsman, Queen Anne, American Foursquare, Neoclassical and various Revival styles. While only a minority were designed by architects, the vernacular forms, such as the Kansas City Shirtwaist and the Colonnaded Apartment Building, are good representative examples of the middle and upper class housing in turn-of-the-century Kansas City. When combined, these architectural styles are reflective of the eclectic mix of design and materials that appealed to the tastes and means of both middle and upper middle class residents.

Since 1994, the neighborhood has been recognized as part of the Old Hyde Park local historic district. The locally-recognized Old Hyde Park district encompasses the South Side National Register Historic District, a

United States Department of the Interior
National Park ServiceNational Register of Historic Places
Continuation SheetSection
number 8 Page 73Old Hyde Park West Historic District
Jackson County, Missouri

commercial district that runs along Main Street. Because the South Side district divides the residential neighborhood and makes it non-contiguous, the residential neighborhood was separated into Old Hyde Park East and Old Hyde Park West. Old Hyde Park East has been submitted as a separate nomination.

The proposed district is located proximate to at least four other districts located on the National Register. The South Side Commercial District, which runs along Main Street, effectively serves as a dividing line between the proposed districts of Old Hyde Park East and Old Hyde Park West. The South Side district was placed on the National Register in 1981. The Armour Boulevard Multiple Resource Area, District I, located northwest of the proposed district between Broadway and Baltimore Avenue, features a series of hotels and apartment dwellings in a variety of styles. It is located within the proposed Old Hyde Park West boundaries and will add 15 contributing properties. Armour Boulevard MRA District I was placed on the National Register in 1983. Janssen Place, formerly a residential enclave of turn-of-the-century railroad and lumber barons, is located six blocks east of the proposed district. It was listed on the National Register in 1976. The proposed Old Hyde Park East district is also proximate to Central Hyde Park, which runs from Gillham Road to Troost Ave. This residential district was placed on the National Register in 1980.

Historic Context of Kansas City: 1870-1930

(Excerpt from *National Register of Historic Places Multiple Property Form for Colonnaded Apartments of Kansas City, Missouri*.¹)

After the end of the Civil War and almost immediately after the completion, in 1869, of the Hannibal Railroad Bridge, the City of Kansas became a national shipping hub. Manufacturing and related commercial businesses became more clustered and grew in density near the growing network of rail lines. Distinct residential neighborhoods and retail commercial centers began to emerge in the developed parts of the City. With the establishment and growth of rail lines and the ensuing commercial development, Kansas City acquired the economic base and population to support a booming real estate market. The 1880s was the most active and prosperous decade of this era. By 1886, cable car and electric trolley lines replaced the horse-drawn car lines that operated in the commercial areas between the river levee and the Town of Westport. The extensive cable system promoted outward expansion through twenty-five miles of cable that reached all corners of the City, as well as outside the city limits.

¹ Sally Schwenk, National Register of Historic Places Multiple Property Form "Colonnaded Apartments of Kansas City, Missouri," December 2003. City of Kansas City, Missouri Landmarks Commission, Kansas City, Missouri.

United States Department of the Interior
National Park Service

National Register of Historic Places Continuation Sheet

Section
number 8 Page 74

Old Hyde Park West Historic District
Jackson County, Missouri

Affluent families erected large "suburban" style homes in the Hyde Park and Roanoke neighborhoods, located in today's midtown area. It was during this period of expansion and growth that professionalism in architecture became firmly established in the City. The number of architects practicing in Kansas City tripled between 1884 and 1888, and peaked again during the building boom of 1904-1906. Ranging in skill and education from carpenter-builders to academically trained professionals, these "architects" erected buildings reflecting competent and innovative designs in the Second Empire, Queen Anne, Gothic Revival, and Romanesque styles.

Between 1910 and 1930, the City's newly initiated parks and boulevard plan began correcting the blight resulting from the City's rapid development, growing congestion, sprawl, and fluctuating land values. During this period, architecture shifted from the aesthetic abstractions of the Victorian period to styles that reflected the demands of rapid growth on construction, new technology, and economic realities of a new era. Architectural treatments reflected either a return to classical or simpler historic architectural forms or to more functional new styles. In Kansas City, this transition occurred slowly, in pace with the need for more housing and an increasing number of commercial structures. Typically, stylistic ornamentation – English Gothic, Renaissance, Baroque, Neoclassical, and Italian Renaissance – began to appear on functional, "modern" building plans. As time passed, even this historically derived ornamentation became flatter, crisper, and more mechanical.

The period also ushered in a change in the traditional housing types. Although developers erected a number of both large and small row houses, French flats, courts, apartment houses, and apartment hotels during the second half of the nineteenth century, Kansas City's residents demonstrated a decided preference for the single-family detached house. After the turn of the century, housing shortages, a rapidly growing middle class, and the emergence of speculative developers ushered in an era of small- to medium-sized four- to twelve-unit apartment buildings. As the City's population accelerated, so did the market for even larger apartment houses. Between the end of World War I and 1925, when the construction market peaked in Kansas City, both the number of smaller units and large apartment buildings (eighteen to twenty-four units) appeared in clusters in different neighborhoods, establishing apartment housing as a significant part of the City's residential patterns.

Old Hyde Park

The expansion of Kansas City's industrial base also resulted in a tremendous influx of population after the turn of the century. New residential neighborhoods were platted and built to meet the housing demand. Individuals and developers constructed single-family dwellings, duplexes, and multi-family apartment buildings. Because so much land was available for development (following the annexation of Westport in 1897 Kansas City had doubled its physical size), the majority of residential construction consisted of sizeable, single family homes.

United States Department of the Interior
National Park Service

National Register of Historic Places Continuation Sheet

Section
number 8 Page 75

Old Hyde Park West Historic District
Jackson County, Missouri

Neighborhoods such as Old Hyde Park, developed for the middle and upper-middle classes, incorporated large, high-style homes on the same block as more modest vernacular houses and multi-family apartments.

Most of the area included in the Old Hyde Park West Historic District, and the separately nominated Old Hyde Park East District, was platted as portions of the Hyde Park subdivision between 1886 and 1901. Small fragments of the district comprise other plats, such as "Hanover Place" (Broadway to Wyandotte, north half of 3700 block) platted in 1886, "Arnold's Resurvey of T.G. Cross Addition" (south half of 3800 block, Broadway to Wyandotte) platted in 1887, and "Redemptorist College Place" (south side of West 34th Street between Wyandotte and Broadway) platted in 1899. These subdivisions were formed from farmland adjacent to the pre-Civil War town of Westport that had been owned by families associated with Westport and the western expansion of the United States (such as J. J. Mastin, Seth and Hugh Ward, and John Harris). Hyde Park was annexed by Kansas City in 1897 as part of a large tract of land, extending approximately from 31st Street south to Brush Creek and from the state line east to Prospect. Significantly this annexation included the formerly independent town of Westport, the progenitor of Kansas City.

Nearly three-quarters of the buildings extant in this area today were constructed by numerous builders and architects between the dates of plat and America's entrance into World War I (164 of them between 1900 and 1909 alone). The neighborhood benefited from landscape architect George Kessler's creation of the naturalistic Hyde Park to the east, a key element in Kansas City's burgeoning Parks and Boulevards system, and the development of the Roanoke subdivision to the west. Both of these developments were targeted toward upper class interests.

After World War I, few unbuilt lots remained in Old Hyde Park. In the 1920s, Kansas City's residential development shifted again as J. C. Nichols drew the market for single-family residences to the area south of his Country Club Plaza commercial development along Brush Creek. Developers were better capitalized, however, and Old Hyde Park became home to both high-rise apartments (like those along Armour Road), and larger colonnaded apartments (such as those on the south 200 block of West 38th St). Since World War I construction in Old Hyde Park has consisted almost entirely of apartments and non-residential properties. The majority of noncontributing structures in the district today are post-World War II apartment buildings representing more recent trends in architectural styles.

During World War II a large number of single-family residences in Old Hyde Park were divided into small apartments and sleeping rooms, increasing the already dense population of the urban neighborhood but contributing an essential housing service. After the war these renters gradually left Old Hyde Park for other, more-suburban residential areas. The neighborhood went into relative decline, as did similar urban neighborhoods in Kansas City and all over the country. In the last decade the neighborhood has experienced revitalization as long-time residents have been joined by new residents in renovating the neighborhood's historic fabric.

United States Department of the Interior
National Park Service

National Register of Historic Places Continuation Sheet

Section
number 8 Page 76

Old Hyde Park West Historic District
Jackson County, Missouri

Development

During the period of peak construction in the district, between 1900 and 1909, Kansas City experienced a tremendous growth in population. There was a great need for housing, and many developers engaged in speculative construction to meet the demand. A number of developers purchased groups of lots on which they built houses, rapidly filling entire blocks. Several developers constructed a dozen or more homes on a single block within a single year. The following list represents those developers who made a significant impact on the Old Hyde Park streetscape through building construction on numerous parcels. One of the developers, Charles E. Finlay, was active right at the turn of the century, while the remaining developers were active between 1903 and 1908.

- * Charles E. Finlay: (c. 1899) - 3700 block Baltimore (6 buildings, both sides); (1899-1902) - 3700 block Wyandotte (9 buildings, odd)
- * J.D. Harmnick: (c. 1903) - 3600 block Central (7 buildings, odd); 3600 block Wyandotte (6 buildings, even)
- * E.W. Hayes: (c. 1904) - 3300 block Baltimore (5 building, odd)
- * J.O. Wade: (c. 1908) - 3800 block Baltimore (4 buildings, odd)

One locally prominent developer who was active in the proposed district was Charles E. Phillips, a noted builder of hotels and apartment buildings in Kansas City, including the Phillips House Hotel downtown. Phillips built several structures within the proposed district, including five buildings along West 38th Street (ca. 1921), a duplex at 206-08 West 34th Street, and 3418-20 Baltimore.

Phillips collaborated with architect Nelle E. Peters on three buildings within the district: 200-02 West Armour Blvd. (1920), 3814-16 Central St. (1921), and 300-06 West Armour Blvd. (1926). The buildings on Armour Blvd. are contributing structures to the Armour Blvd. MRA District I, listed on the National Register.

Architecture and Architects

The Old Hyde Park West Historic District was developed during a period of great architectural variety. The late 19th century was the heyday of exuberant Victorian architecture, while the early 20th century witnessed the return of more subdued Classical and Colonial Revival styles, the exploration of traditional Craftsman themes, and the development of the uniquely Midwestern Prairie style. The architectural vocabulary of these varied styles is represented both individually and in unique amalgamations on buildings throughout the District. The result is a neighborhood of substantial residences, eclectic in design, that present a streetscape largely unchanged since the 1920s.

The single-family residences represent the variety of architectural fashions popular from the end of the nineteenth century through World War I. Most of the single-family homes are 1 to 2 ½ stories. While a few architect-designed properties are included in the district, the majority are vernacular house forms embellished with stylistic elements. The locally popular "Kansas City Shirtwaist," a variation of the midwestern foursquare

United States Department of the Interior
National Park Service

National Register of Historic Places Continuation Sheet

Section
number 8 Page 77

Old Hyde Park West Historic District
Jackson County, Missouri

house, predominates. These houses are clad with brick or stone on the first story and shingles, clapboards, or stucco on the upper stories. Most have full-width or wraparound front porches and multiple roof dormers. Architectural embellishments reflect the various architectural styles elaborated below.

- Queen Anne: shingled siding, asymmetrical plan, wraparound porch, stained glass windows, decorative stick work
- Colonial Revival: center hall plan, gabled portico, pent overhang, sidelights
- Classical Revival: columns, cornice returns, dentils, modillions, Palladian window
- Tudor: small multi-light sash, simulated half-timbering
- Prairie: wide eaves, banded windows
- Craftsman: knee braces, exposed rafter tails, multiple gables and dormers, leaded and art glass windows

While the majority of homes in the district were not architect designed, some of Kansas City's most prominent architects did contribute designs to the neighborhood. While the majority of homes in the district were not architect-designed, some of Kansas City's most prominent architects did contribute designs to the neighborhood. Perhaps most notable among them was one of the few female architects of her day, Nelle E. Peters.

Working with builder Charles E. Phillips, Peters contributed five buildings within the district: 200-202 W. Armour (1920); 300-306 W. Armour (1926); 3813-3815 Central (1913); 3814-3816 Central (1921); and 3817-3819 Central (1913). The buildings along Central are typical three story, U-shaped, brick apartment buildings. Four of the buildings are Colonnaded apartments with two-story columns or posts resting on one-story brick piers. The other two buildings are similar in design, with enclosed sun porches replacing colonnaded porches on the facade. With its Gothic and Classical ornament around the door and window openings and the roof line, 300-06 Armour is reminiscent of Peters' designs on the Country Club Plaza. Known as the "literary group" of apartment buildings, the Robert Louis Stevenson, Eugene Field, Mark Twain, Washington Irving, Thomas Carlyle, James Russell Lowell and the Robert Browning, comprise the "Nelle Peters Historic District," which was designated to the Kansas City Register in 1989. Peters also designed Kansas City's Ambassador Hotel at 3560 Broadway, which is also listed on the National Register.

The concentration of Peters' designs in the proposed Old Hyde Park West district represents the second largest recognized concentration of Peters' work. Nelle E. Peters is credited with nearly 1,000 buildings during her 60-year career.

Five apartments by the area's leading female architect, Nelle E. Peters are included in the district: John McKecknie is recognized as one of Kansas City's leading interpreters of the turn-of-the-century Arts & Crafts school of design. Twelve buildings by McKecknie, and his firm McKecknie & Trask, are included in Old Hyde Park, including a concentration of eleven small apartment buildings at the west end of Armour Boulevard. McKecknie's work in the district includes the following properties: 100-06, 108-10, 112-14, 116-18 West Armour (1902-03); 109-11, 113-15, 117-19, 121-23 West Armour (1906); 212-14, 216-18, 220-22 West

United States Department of the Interior
National Park ServiceNational Register of Historic Places
Continuation SheetSection
number 8 Page 78Old Hyde Park West Historic District
Jackson County, Missouri

Armour (1905); 6-8 West 37th Street (1903). The majority of these buildings are two-story, colonnaded apartments embellished with McKecknie's own interpretation of Craftsman style. Identifying features include groups of thin posts instead of columns and ornate geometric brick and stone trim, especially at the eave line. 100-06 West Armour is a larger building of a Mediterranean-inspired design.

Other locally prominent architects whose work is contained in the Old Hyde Park West Historic District include:

- * Philip T. Drotts - 311-15 W. 38th Street (1925)
- * Otis Goddard - 3433-3435 Central (1911)
- * Alfred Hockaday - 220 West 34th Street (1901)
- * Wilder & Wight - 3800-02 Baltimore (1910)

The Old Hyde Park West Historic District retains the distinctive character of a late 19th-early 20th century neighborhood. The District's integrities of materials, design, and workmanship are strong, in spite of alterations to individual buildings and modern construction. The majority of alterations involve wall cladding, porch details, windows, and/or the construction of exterior wood stairs. Generally the alterations have only a minor affect on the character of the property and the district. Only seven of the 373 buildings constructed during the period of significance are sufficiently altered to be considered noncontributing elements. The district's integrity of setting is enhanced by the uniform setbacks of buildings and the large trees that still line the street. While modern apartment complexes, most constructed in the 1960s, disrupt the historic sense of scale in some areas, they do not damage the integrity of feeling for the larger district.

United States Department of the Interior
National Park Service

National Register of Historic Places Continuation Sheet

Section
number 9 Page 79

Old Hyde Park West Historic District
Jackson County, Missouri

BIBLIOGRAPHY

- A Place in Time*. Kansas City: Kansas City, Missouri Landmarks Commission, 1977.
- Bean, Million, Mobley & Gross. *The American Institute of Architects Guide to Kansas City Architecture & Public Art*. Kansas City: Highwater Editions, 2000.
- Boutros, Davi; Lee, Janice, White, Charlotte R., Wolfenbarger, Deon. eds. *A Legacy of Design: An Historical Survey of the Kansas City, Missouri, Parks and Boulevards System, 1893-1940*. Kansas City, MO: Kansas City Center for Design Education and Research, in cooperation with the Western Historical Manuscript Collection-Kansas City, 1995.
- Brown, A. Theodore and Lyle Dorsett. *K. C., A History of Kansas City, Missouri*. Boulder: Pruett Publishing Company, 1978.
- City of Kansas City, Missouri. Water Department, City Hall. Water Permits.
- Ehrlich, George. *An Architectural History of Kansas City, Missouri, 1826-1976*. Kansas City, Missouri: Historic Kansas City Foundation, 1979.
- Fitch, James Marston. *American Building: The Historical Forces That Shaped It*. Boston: Houghton Mifflin Company, 1966, 239-245.
- Hoye's City Directory of Kansas City, Missouri, Kansas City, Missouri: Hoye Directory Company, 1889. p. 52.
- McAlester, Virginia and Lee. *A Field Guide to American Houses*. New York: Alfred A. Knopf, 1985.
- Mobley, Jane and Whitehead Harris, Nancy. *A City Within A Park – One Hundred years of Parks and Boulevards in Kansas City, MO*. Kansas City: Lowell Press, 1991, 23.
- Schwenk, Sally. National Register of Historic Places Multiple Property Form "Colonnaded Apartments of Kansas City, Missouri," December 2003. City of Kansas City, Missouri Landmarks Commission, Kansas City, Missouri.
- Spencer, Brenda R. National Register of Historic Places Multiple Property Form "Colonnaded Apartments on the north end of The Paseo Boulevard in Kansas City, Missouri, ca. 1896-1945," 20 May 2000. City of Kansas City, Missouri Landmarks Commission, Kansas City, Missouri.
- Worley, William. *J.C. Nichols and the Shaping of Kansas City*. Columbia: University of Missouri Press, 1990.

United States Department of the Interior
National Park Service

National Register of Historic Places Continuation Sheet

Section number 10 Page 80

Old Hyde Park West Historic District
Jackson County, Missouri

UTM References

E	<u>15</u>	<u>362490</u>	<u>4325300</u>
	Zone	Easting	Northing

Verbal Boundary Description

Refer to the bold line on the attached scale maps of the proposed district.

LEGAL DESCRIPTION

All of Lots 9 thru 27, inclusive and the south 25 feet of Lot 8, Block 1; all of Lots 19 thru 30, inclusive. Block 2; all of Lots 12 thru 22, inclusive. Block 3; all of Lots 1 through 22, inclusive. Block 4; all of Lots 1 through 22, inclusive. Block 5; all of Lots 9 thru 11, inclusive. Block 6; all of Lots 1 thru 3, inclusive, and the east 20 feet of Lots 20 thru 22, inclusive, and all of Lots 5 and 6, Block 7; all of Lots 7 thru 16, inclusive, and the south 17.5 feet of Lot 17, Block 8; all of Lots 1 through 22, inclusive. Block 9; all of Lots 12 thru 17, inclusive, and the south 33.91 feet of Lot 18, Block 10, Hyde Park; a subdivision in Kansas City, Jackson County, Missouri.

All of Lots 1 thru 24, inclusive. Block 23; all of Lots 1 thru 7, inclusive. Block 24, Corrected Plat of Blocks 23 and 24 of Hyde Park; a subdivision in Kansas City, Jackson County, Missouri.

All of Lots 13 through 24, inclusive. Block 29; all of Lots 7 thru 12, inclusive. Block 30, Plat of Blocks 29 and 30 of Hyde Park; a subdivision in Kansas City, Jackson County, Missouri.

All of Lots 5 thru 8, inclusive. Block 39; all of Lots 2 thru 8, inclusive. Block 40; all of Lots 1 through 12, inclusive. Block 41; all of Lots 1 thru 5, inclusive, and the north 25 feet of Lot 6, Block 42; all of Lots 1 thru 4, inclusive, and Lots 7 thru 12, inclusive, Block 43; all of Lots 10 thru 12, inclusive, and the north 39 feet of Lot 9, Block 44, Plat of Blocks 39, 40, 41, 42, 43, and 44 of Hyde Park; a subdivision of Kansas City, Jackson County, Missouri.

All of Lots 13 thru 24, inclusive, Block 47; all of Lots 1 through 24, inclusive, Block 48; all of Lot 2, Block 49; all of Lot 2 and the north 83.42 feet of the west 60 feet of Lot 1, Block 50, Plat of Blocks 47, 48, 49, and 50 of Hyde Park; a subdivision in Kansas City, Jackson County, Missouri.

All of Lots 1 thru 14, inclusive. Block 59, Plat of Blocks 59 and 60 of Hyde Park; a subdivision in Kansas City, Jackson County, Missouri.

United States Department of the Interior
National Park Service

National Register of Historic Places Continuation Sheet

Section
number 10 Page 81

Old Hyde Park West Historic District
Jackson County, Missouri

All of Lots 7 thru 12, inclusive. Block 1; all of Lots 1 thru 12, inclusive, Block 2, Hyde Park Annex; a subdivision in Kansas City, Jackson County, Missouri.

All of Lots 1 thru 5, inclusive, and Lots 10 thru 12, inclusive, Arnold's Resurvey of T.G. Cross' Addition; a subdivision in Kansas City, Jackson County, Missouri.

All of Lots 1 thru 12, inclusive, Hanover place; a subdivision in Kansas City, Jackson County, Missouri.

All of Lots 1 thru 8, inclusive, Redemptorist College Place; a subdivision in Kansas City, Jackson County, Missouri.

All of Baltimore Place, a condominium subdivision in Kansas City, Jackson County, Missouri.

Boundary Justification

The Old Hyde Park West Historic District is comprised of a residential area bounded by Linwood Boulevard, Central Street, Baltimore Street, and 39th Street. The district is limited mainly to properties constructed as residences along Central, Baltimore, Wyandotte, and numbered side streets. Properties along Main Street and Broadway are excluded from the district. The area along Main Street is itself a National Register Historic District, referred to as South Side National Register Historic District. Main Street and Broadway are both primarily commercial corridors, whereas Old Hyde Park West Historic District is primarily residential. These boundaries have been delineated to exclude the majority of commercial properties in the area (most of which have lost integrity due to extensive alterations) while including those portions of the streetscape that retain integrity from the period of significance. An Old Hyde Park East Historic District is also being nominated at this time. The two areas, though very similar, are not being nominated as a single district because of the wide strip of non-historic commercial development that separates the two residential neighborhoods.

United States Department of the Interior
National Park Service

National Register of Historic Places Continuation Sheet

Section
number Photos Page 82

Old Hyde Park West Historic District
Jackson County, Missouri

Property: Old Hyde Park West Historic District
Photos by: Tony Gardner
Date: November 2003

1. 116-118 W. Armour
2. 121-123 W. Armour
3. 200-202 W. Armour
4. 31 W. 36th St.
5. 3410 Baltimore Ave.
6. 3602 Baltimore Ave.
7. 3606 Baltimore Ave.
8. 3800 Baltimore Ave.
9. 3820 Baltimore Ave.
10. 3339 Wyandotte St.
11. 3505-3507 Wyandotte St.
12. 3420-3424 Wyandotte St.
13. 3432-34 Wyandotte St.
14. 3525-27 Wyandotte St.
15. 3648 Wyandotte St.
16. 3700-02 Wyandotte St.
17. 3716 Wyandotte St.
18. 3816 Wyandotte St.
19. (2) 100 blk W. Armour, facing south
20. (2) 3400 blk Baltimore, facing north
21. (2) 3600 blk Baltimore, facing south
22. (2) 3500 blk Wyandotte, facing south

Old Hyde Park West

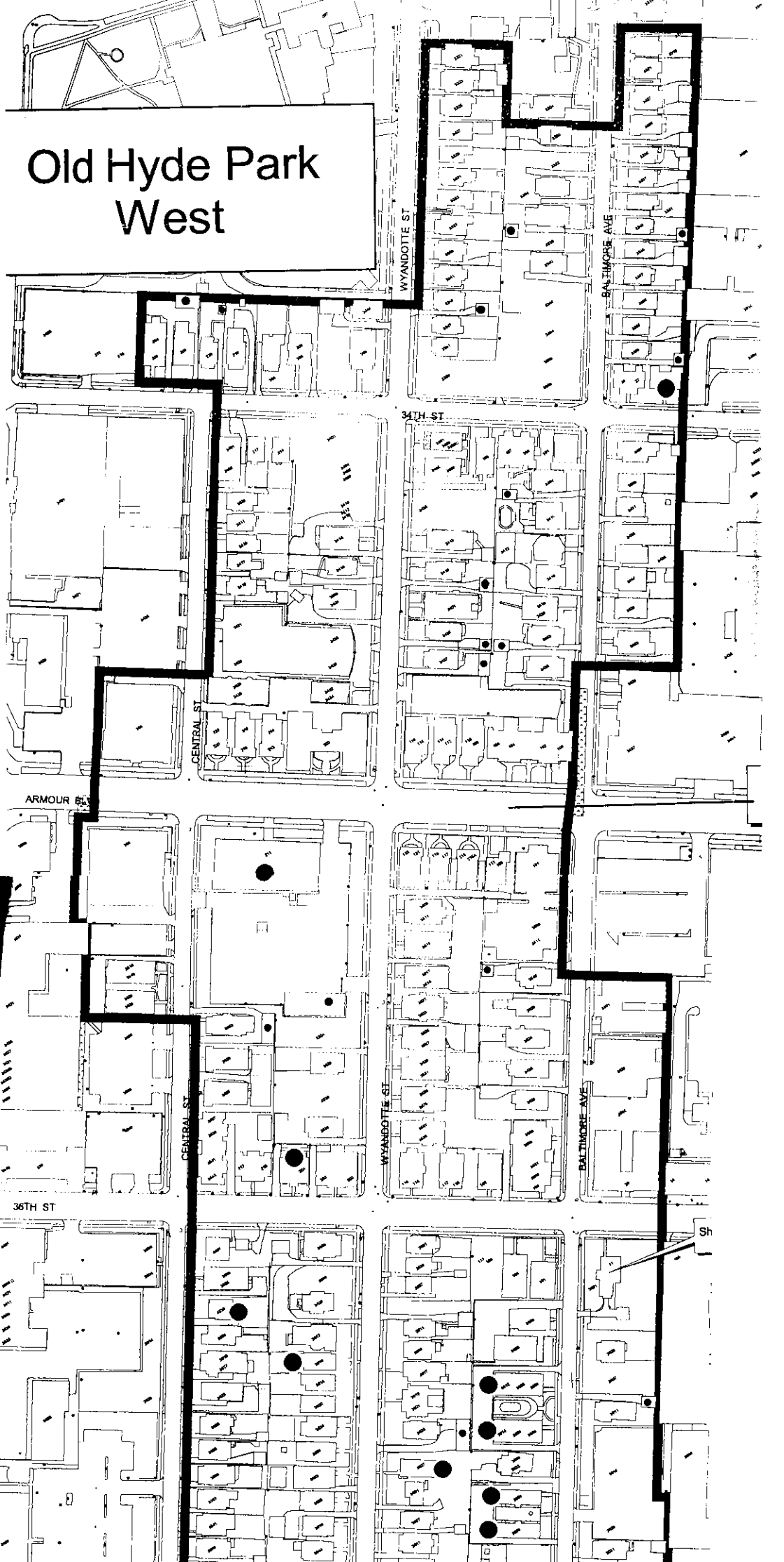

WYANDOTTE ST

BALTIMORE AVE

34TH ST

CENTRAL ST

ARMOUR BLVD

WYANDOTTE ST

BALTIMORE AVE

36TH ST

CENTRAL ST

Sh

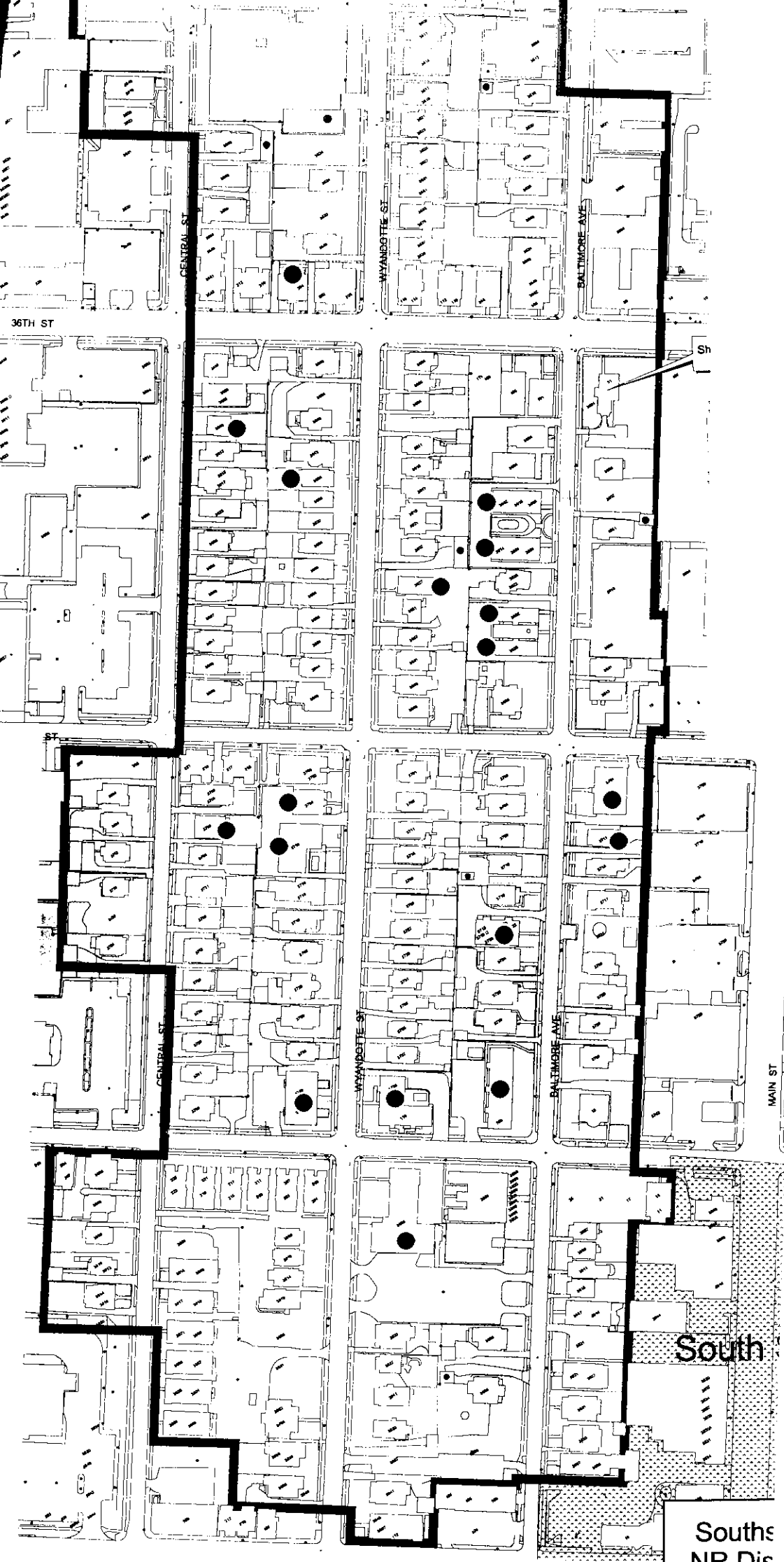

36TH ST

CENTRAL ST

WYANDOTTE ST

BALTIMORE AVE

ST

CENTRAL ST

WYANDOTTE ST

BALTIMORE AVE

MAIN ST

South

South NP Dis

Old Hyde Park West



South

South
Main St

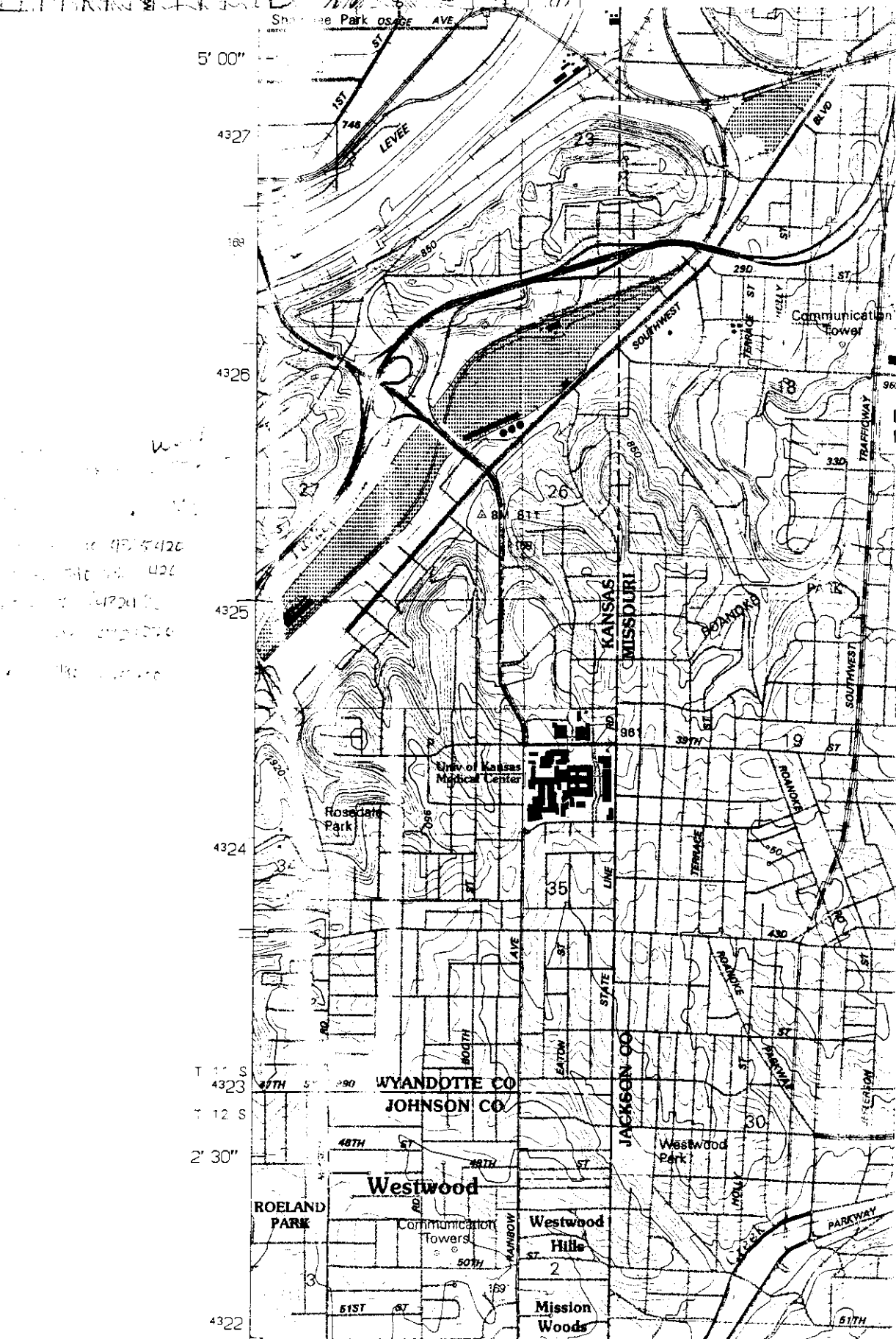

Map scale and coordinate information: 5' 00", 4327, 169, 4326, 4325, 4324, T 11 S 4323, T 12 S 2' 30", 4322.

Shelton Park OSAGE AVE

15TH ST

LEVEE

290

27

26

University of Kansas Medical Center

Rosedale Park

WYANDOTTE CO

JOHNSON CO

WESTWOOD

ROELAND PARK

Communication Towers

51ST ST

29

26

26

26

University of Kansas Medical Center

Rosedale Park

WYANDOTTE CO

JOHNSON CO

WESTWOOD

ROELAND PARK

Communication Towers

51ST ST

29

26

26

26

University of Kansas Medical Center

Rosedale Park

WYANDOTTE CO

JOHNSON CO

WESTWOOD

ROELAND PARK

Communication Towers

51ST ST

29

26

26

26

University of Kansas Medical Center

Rosedale Park

WYANDOTTE CO

JOHNSON CO

WESTWOOD

ROELAND PARK

Communication Towers

51ST ST

29

26

26

26

University of Kansas Medical Center

Rosedale Park

WYANDOTTE CO

JOHNSON CO

WESTWOOD

ROELAND PARK

Communication Towers

51ST ST

29

26

26

26

University of Kansas Medical Center

Rosedale Park

WYANDOTTE CO

JOHNSON CO

WESTWOOD

ROELAND PARK

Communication Towers

51ST ST

29

26

26

26

University of Kansas Medical Center

Rosedale Park

WYANDOTTE CO

JOHNSON CO

WESTWOOD

ROELAND PARK

Communication Towers

51ST ST





123









Baltimore Place
ESTABLISHED 1914

















JACK



WYANDOTTE ST









SPEED
LIMIT
25



